

温馨提示:

- 1、本资料中部分提示示意图，仅供参考，如与实物不符，请以实物为准。
- 2、本资料图片均来自专业的相机拍摄，但在摄影及印刷过程中，受光线、设备、环境等因素的影响，图片与实物的颜色可能存在色差，请以实物为准。
- 3、本公司全权负责该资料的修订及解释，并保留更改产品及技术参数不另行通知的权利，敬请原谅。

佛山市泓力智能设备有限公司

Foshan Hongli Intelligent Equipment Co., Ltd

手机: 0086-133 8052 7235 / 189 2212 8789

官方网站: www.risen168.com

生产基地: 佛山市南海区狮山镇小塘创景工业园 1 栋

ADD: 1st Building, Chuangjin industrial zone, Xiaotang, Shishan Town, Nanhai, Foshan



抖 音



官 网



国 际 站

热管理整体方案供应商

All-in-one Solution of TMS Manufacturer



RISEN[®] 日森

机械有日森 运行更稳定

Mechanical operation is more stable with RISEN

您好， 我们是日森



Hello!

We Are RiSen technology

佛山市泓力智能设备有限公司，坐落在南海区狮山镇，成立于 2019 年，承接了原上市公司（广州市日森机械股份有限公司）的 RISEN 品牌及专业核心技术团队，是原散热器行业头部品牌，采用先进的钎焊技术，以超过 20 年的专业技术专注于各类金属散热器的开发与生产，主要从事设计、生产各类油冷器、风冷器、散热器、冷却模块总成及各种换热器零部件。

我司先后通过了 ISO9001/ISO9000/QS9000 认证，获得了国家高新技术认证，拥有 38 项专利技术，已通过环境管理体系、职业健康安全管理体系认证，我们将专业贯穿于产品每一处细节。

在多年热管理研究下，连同中科院博士心血凝结，十五年散热器装置制造经验，为客户提供高效完美的散热专业解决方案，致力于解决一切工业产品、民用产品散热痛点。

RISEN 品牌享誉全球，拥有雄厚的工程技术力量以及精良的生产检测设备，产品类型齐全、质量出众，赢得了客户的广泛信赖，收获了良好的品牌声誉。

Foshan Hongli Intelligent Equipment Co., Ltd., located in Shishan Town, Nanhai District, was founded in 2019. It has undertaken the RISEN brand and professional core technology team of the original listed company (Guangzhou Nissen Machinery Co., Ltd.). It is the head brand of the original radiator industry. With advanced brazing technology, it has focused on the development and production of various metal radiators with more than 20 years of professional technology, mainly engaged in the design and production of various oil coolers Air cooler, radiator, cooling module assembly and various heat exchanger components.

Our company has successively passed the ISO9001/ISO9000/QS9000 certification, obtained the national high-tech certification, has 38 patented technologies, and has passed the certification of environmental management system and occupational health and safety management system. We will be professional in every detail of our products.

After years of research on thermal management, together with the blood of the doctor of the Chinese Academy of Sciences, and 15 years of experience in the manufacture of radiator devices, we provide customers with efficient and perfect professional cooling solutions, and are committed to solving the cooling pain points of all industrial products and civil products.

RISEN brand enjoys a worldwide reputation, with strong engineering and technical force and excellent production and testing equipment, complete product types and outstanding quality, which has won the wide trust of customers and gained a good brand reputation.



3_年

公司成立已有
Company

20_年

制造经验
Experience

38_项

专利技术
Patent technology

100000_项⁺

工程案例
Engineering case



技术研发 x TECHNOLOGY R&D

专业研发团队



日森拥有数台进口的全自动机械生产设备，从生产、加工到成品，我们突破了传统的工艺制作，大大提高了生产效率和产品品质，凭借人性化的设计、严格的品控成为了行业的佼佼者。

RISEN owned several imported full-automatic production line, what broke through the traditional art works from the production, process to completed goods, greatly improved the quality and efficiency, with humanized design and strict QC to become the industry leader.



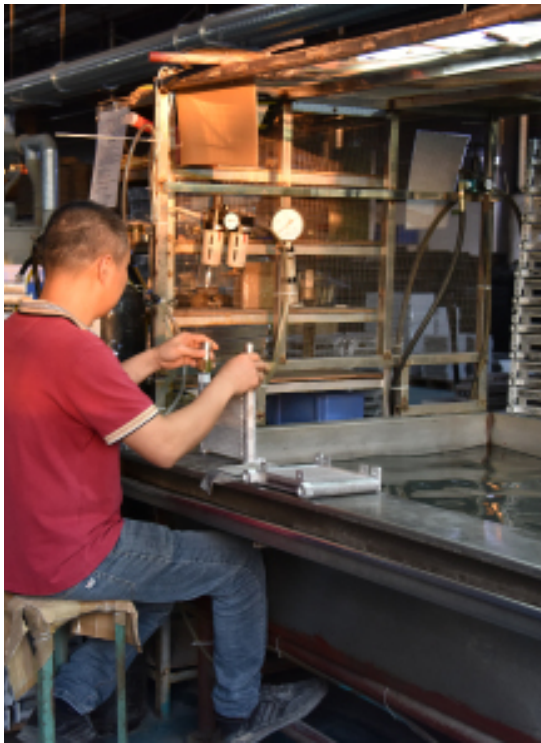

GATHER THE WISDOM OF DESIGN AND
MAKE A BRILLIANT TEAM

汇聚设计智慧
前瞻性研发团队聚力出彩

品牌实力 X BRAND STRENGTH

商标注册证



汗水与智慧见证了昨日拼搏的足迹，
激情与梦想成就不断锐意进取，开拓创新，
在务实求精中践行创新、创意、创享的价值理念，
收获不绝于耳的赞扬声，斩获一项项令人瞩目的荣耀。

Perspiration and wisdom evidenced our footprints of hard working. Passion and dream help us to improve and positive enterprise. RISEN practiced the values of creativity, originality and sharing to seek for great perfection, to harvest endless praises and attract more and more attentions.



品牌实力 X BRAND STRENGTH

部份产品专利





品牌实力 × BRAND STRENGTH

公司荣誉



在过往一路走来的 20 多年风风雨雨中，一路征程一路凯歌。赢得了广大消费者的深深信赖和厚爱，并取得了一个又一个的骄人业绩。

Along with wind and rain in the past decades, we always go ahead with triumphant songs. we are highly praised and appreciated by the consuming public, and made extraordinary progress step by step.

品牌见证 X BRAND WITNESS

发展历程



20TH 多年来不断探索与创新 *20 years of continuous exploration and innovation*

持久于品质层面上的关注，是对客户与消费者的基本之责。

产品的品质控制体系，以理性而苛刻的态度，

守护 RISEN 品牌最具生命力的价值部分。

荣誉不仅仅是肯定，更是永续坚守的职责。

Focus on high quality overtime what is our duty and responsible for customers. In a rational and critical manner to control the QC system, to guard the most vital values of RISEN brand. Glory is not only definitely, but also help us hold our ground forever.

1992

创始人以销售液压气动产品作为创业起点。
The founder started his business by selling hydraulic and pneumatic products.

2009

开辟新领域，成立新的散热器事业部，生产各类风冷却器。

Open up new fields, establish a new radiator business department, and produce various types of air coolers.

2002

成立广州市日森机械有限公司，自主研发、设计、生产和销售油缸、液压产品。

Guangzhou RISEN Machinery Co., Ltd. was established to independently develop, design, produce and sell oil cylinder and hydraulic products.

2014

广州市股权交易中心挂牌，股票代码：890552。

Listed in Guangzhou Stock Exchange Center, stock code: 890552.

成立英德市日森机械有限公司。

Establishment of Yingde Risen Machinery Co., Ltd.

2010

日森散热器产品走向国际市场，陆续出口俄罗斯、非洲、中东、澳洲等国家和地区。

RISEN radiator products have been exported to the international market, including Russia, Africa, the Middle East, Australia and other countries and regions.



2015

公司股份制改革，更名为：广州市日森机械股份有限公司。

The company's shareholding reform changed its name to Guangzhou RISEN Machinery Co., Ltd.

2017

散热器厂扩大生产规模，实现散热器厂、油缸厂、液压系统厂全年产销合计达到1.3亿元。

The radiator factory expanded its production scale to achieve a total annual production and sales of 130 million yuan for radiator factory, oil tank factory and hydraulic system factory.

2016

全国中小企业股份转让系统挂牌，股票代码：838689。

Listed in the National Small and Medium-sized Enterprise Share Transfer System, stock code: 838689.

20...

困难与挫折是短暂的，也是过去式，RISEN人定当总结过去、展望未来，RISEN会持续为广大客户提供最专业的热管理方案和最优质的服务。

Difficulties and setbacks are short and past. RISEN people should summarize the past and look forward to the future. RISEN will continue to provide customers with the most professional thermal management solutions and the best quality services.

2019-2020

在上市过程中，因盲目扩张、管理不善导致日森公司被退市。退市后日森公司旗下产业链进行重组，搬迁至佛山市南海区狮山镇，成立泓力公司，泓力公司保留了日森品牌，承接了原有的生产、技术和销售团队。泓力公司在新能源领域扩大研发规模，并在热管理技术、充电桩领域不断突破。

In the process of listing, Nissen was delisted due to blind expansion and poor management. After delisting, RISEN industrial chain was restructured, and moved to Shishan Town, Nanhai District, Foshan City to establish Hongli Company, which retained Nissen's brand and undertook the original production, technology and sales team. Hongli Company has expanded its research and development scale in the field of new energy, and made continuous breakthroughs in the fields of thermal management technology and charging piles.

产品应用 X ELECTRONIC EQUIPMENT THERMAL MANAGEMENT SYSTEM

电子设备热管理系统



计算机液冷系统 X Computer night cooling system



冷凝器系统 X Condenser system

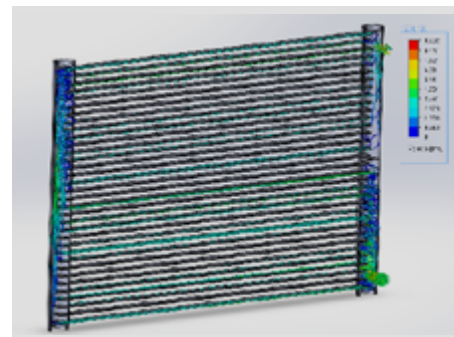

计算机液冷系统 X Computer night cooling system



服务器液冷系统 X Computer night cooling system



产品应用 X POWER EQUIPMENT THERMAL MANAGEMENT SYSTEM

电力设备热管理系统



发电设备热管理系统 X Power generation equipment



配电设备热管理系统 X Power distribution equipment heat



发电机热管理系统 X Generator thermal management system



油冷机系统 X Oil cooler system



热交换器系统 X hot box

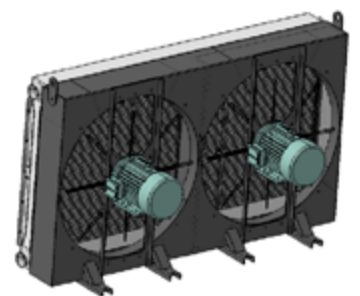

产品应用 X NEW ENERGY THERMAL MANAGEMENT SYSTEM

新能源热管理系统



车辆热管理系统 X Vehicle thermal management system

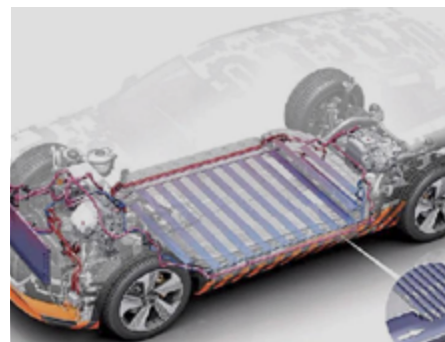
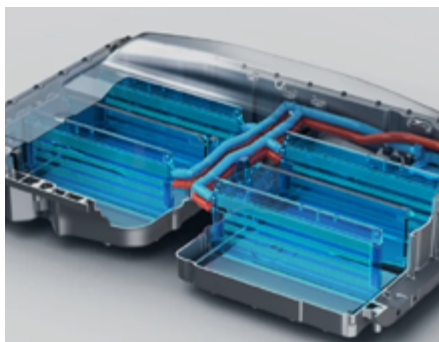

充电桩热管理系统 X Thermal management system of charging pile



储能装置热管理系统 X Thermal management of energy storage device



特种车热管理系统 X Thermal management of special vehicles



产品应用 × SPECIAL EQUIPMENT THERMAL MANAGEMENT SYSTEM

特种设备热管理系统



冷水机系统 × Chiller system



矿山设备热管理系统 × Equipment thermal management system



激光设备热管理系统 × Thermal management system of laser equipment



数控热管理系统 × Equipment thermal management system

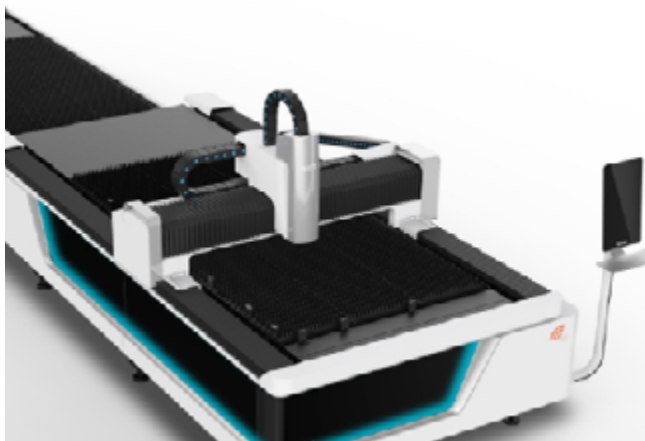

液压设备热管理系统 × Thermal management of hydraulic equipment



产品选型 X PRODUCT SELECTION

板翅片式冷却器



材料：铝合金

Material: aluminum alloy

最高工作压力 :2.5MPa

Maximum working pressure: < 2.5MPa

最高使用温度：<130° C

Maximum service temperature: < 130 °C

适用流体：不与铝合金产生化学反应流体工质

Applicable fluid: working fluid without chemical reaction with aluminum alloy

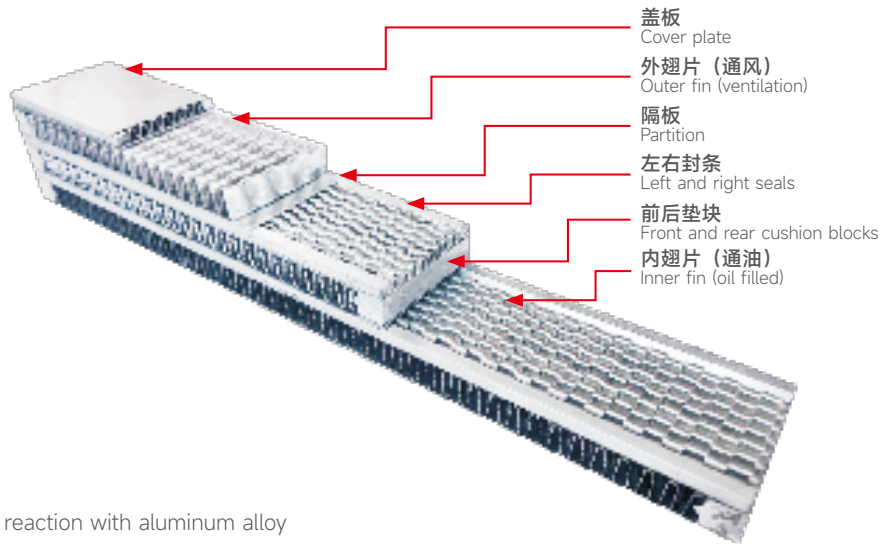

板 - 翅片式冷却器特点：

结构紧密，体积小，重量轻，换热面更大，换热效率更好。密封流体通道内有内翅片，流体通道外焊接波浪形外翅片，导热更迅速。每单位的换热面积，板翅片式冷却器相较于套接铜管式或其他材质或结构，有最佳的换热效能，至少达到10-20倍。

Compact structure, small volume, light weight, larger heat exchange surface and better heat exchange efficiency. There are inner fins in the sealed fluid channel, and wavy outer fins are welded outside the fluid channel to conduct heat more rapidly. Per unit of heat exchange area, plate fin cooler has better heat exchange efficiency than socket copper tube or other materials or structures, at least 10-20 times.

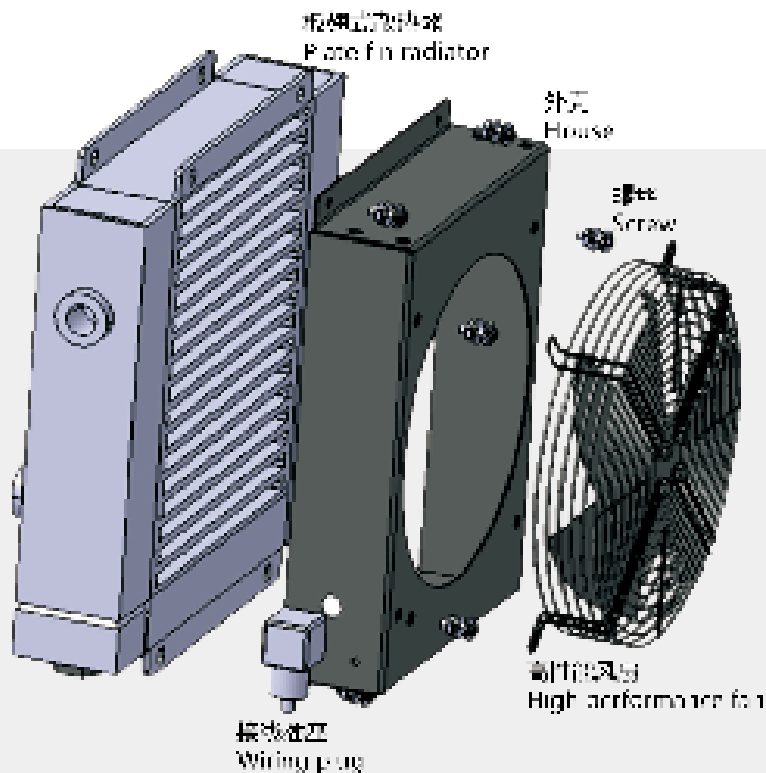

关于产品 X ABOUT
PRODUCT

产品目录



AJ0510T-CA	P17
AJ1025T-CA	P18
AJ0607T-CA	P19
AJ0608T	P20
AJ0608TL	P21
AJ1012T	P22
AF0510T-CA	P23
AF1025T-CA	P24
AL608T-CA	P25
AL404T-CA	P26
AH0607T-CA	P27
AH0608T-CA	P28
AH0608TL-CA	P29
AH1012T	P30
AH1012T1	P31
AH1012TB	P32
AH1417T-CA	P33
AH1417TB	P34
AH1470TB	P35
AH1470T-CA	P36
AH1490T-CA	P37
AH1490TB	P38
AH1680T-CA	P39
AH2431T-CA	P40
AH3818T-CA	P41
AJ5435T-36	P42
HPW-5A/10A	P43
HPW-15A/25A	P44
汽车变速箱油冷	P45
汽车发动机油冷	P46
RS1500-KS 矿山机械 / 油缸	P47
矿机、服务器等非标定制	P48

AJ 系列 X AJ SERIES

AJ0510T-CA



风冷却器 AIR COOLER



产品配置 PRODUCT CONFIGURATION			
形式 Form	AJ0510T-CA	冷却能力 Cooling capacity	1.2KW
流量 Flow	10L/min	重量 Weight	2KG
工作压力 Working pressure	≤ 2MPa	包装尺寸 Package size	24.5*12.5*22cm
风扇功率 Fan power	34W	风扇电压 Fan voltage	AC110V/AC220V-240V/AC380V/ DC12V/DC24V/50HZ
外翅片散热面积 Fan power	0.9 m ²	注：特殊电压特殊尺寸可按要求定制 Special voltage size can be customized	

产品线图 PRODUCT LINE DIAGRAM

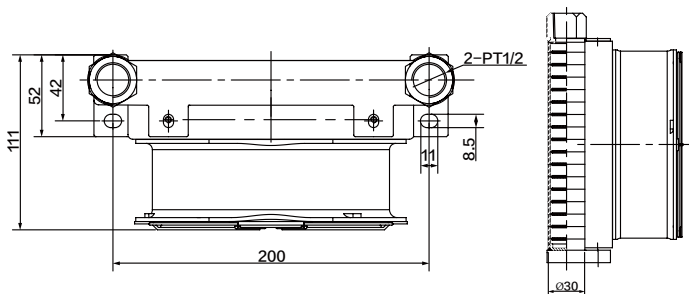
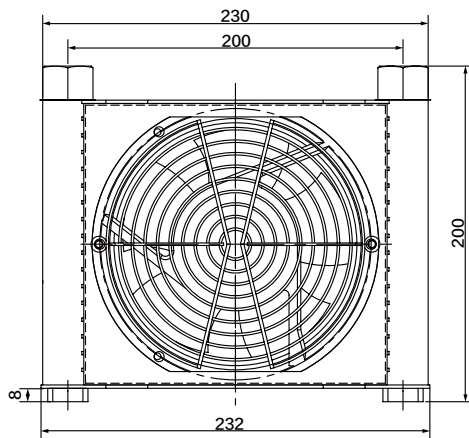

性能曲线 PERFORMANCE CURVE

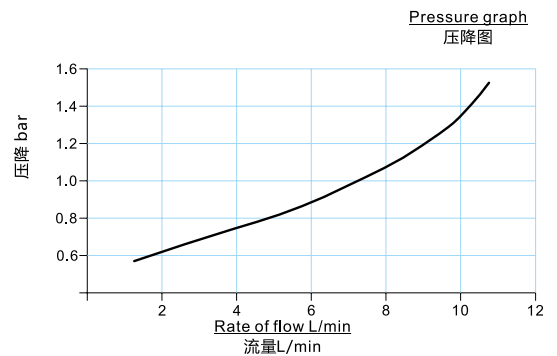
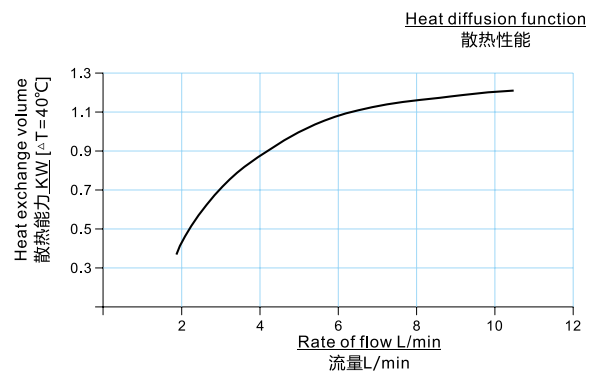

AJ 系列 X AJ SERIES

AJ1025T-CA



风冷却器 AIR COOLER

产品配置 PRODUCT CONFIGURATION			
形式 Form	AJ1025T-CA	冷却能力 Cooling capacity	1.35KW
流量 Flow	25L/min	重量 Weight	2.5KG
工作压力 Working pressure	≤ 2MPa	包装尺寸 Package size	26*12*26.5cm
风扇功率 Fan power	34W	风扇电压 Fan voltage	AC110V/AC220V-240V/AC380V/ DC12V/DC24V/50HZ
外翅片散热面积 Fan power	1.3 m ²	注：特殊电压特殊尺寸可按要求定制 Special voltage size can be customized	



产品线图 PRODUCT LINE DIAGRAM

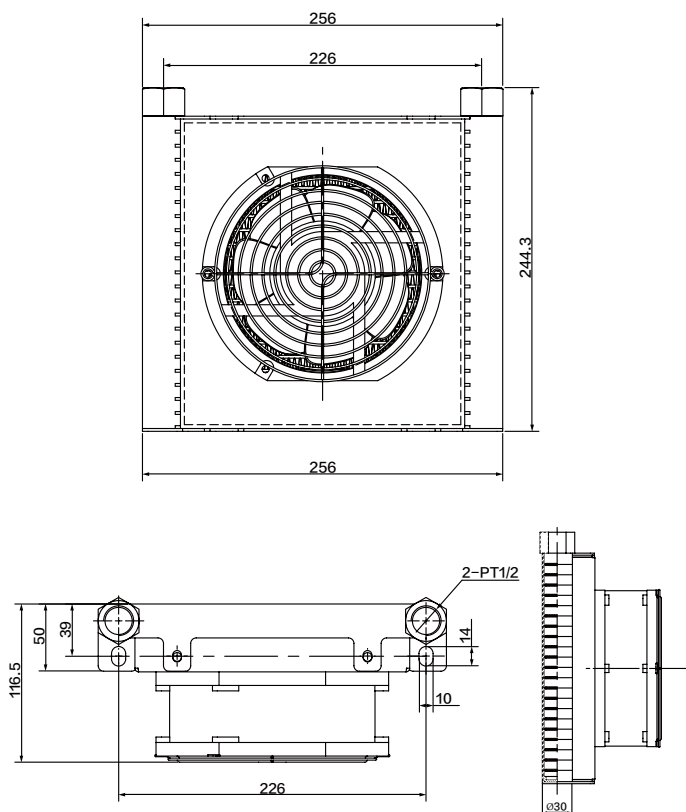

性能曲线 PERFORMANCE CURVE

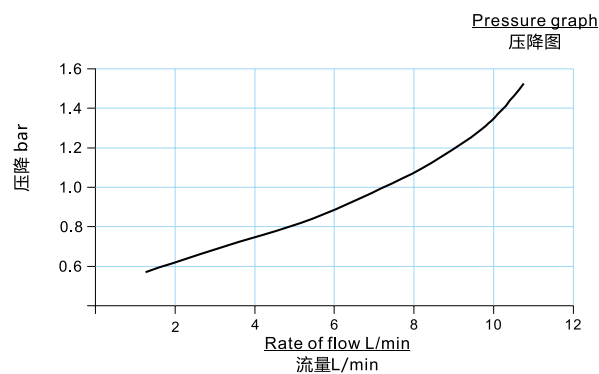
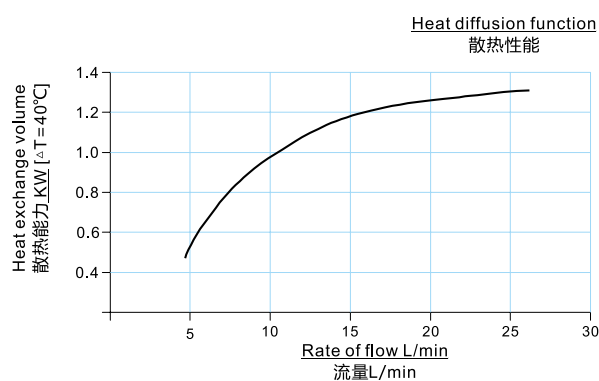

AJ 系列 X AJ SERIES

AJ0607T-CA



风冷却器 AIR COOLER



产品配置 PRODUCT CONFIGURATION			
形式 Form	AJ0607T-CA	冷却能力 Cooling capacity	1.05KW
流量 Flow	40L/min	重量 Weight	2.5KG
工作压力 Working pressure	≤ 2MPa	包装尺寸 Package size	28.5*14*22cm
风扇功率 Fan power	34W	风扇电压 Fan voltage	AC110V/AC220V-240V/AC380V/ DC12V/DC24V/50HZ
外翅片散热面积 Fan power	0.8 m ²	注：特殊电压特殊尺寸可按要求定制 Special voltage size can be customized	



产品线图 PRODUCT LINE DIAGRAM

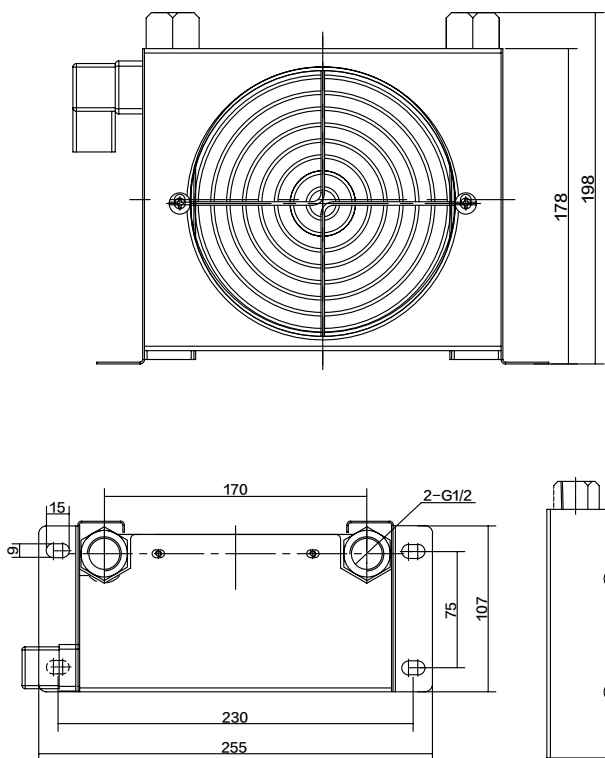

性能曲线 PERFORMANCE CURVE

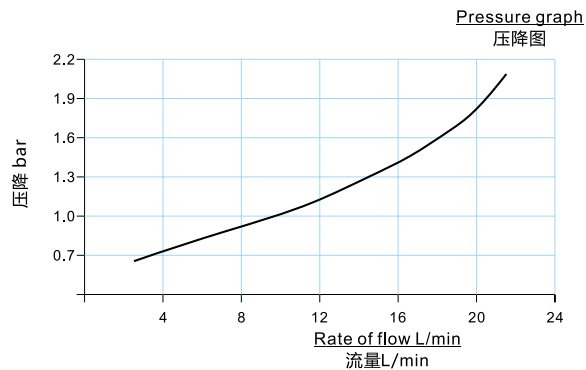
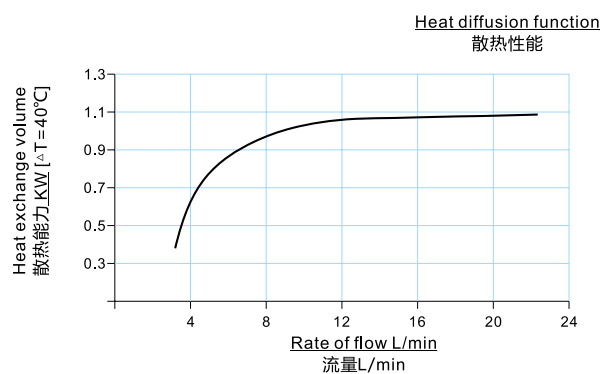

AJ 系列 X AJ SERIES

AJ0608T



风冷却器 AIR COOLER



产品配置 PRODUCT CONFIGURATION			
形式 Form	AJ0608T	冷却能力 Cooling capacity	1.8KW
流量 Flow	60L/min	重量 Weight	4KG
工作压力 Working pressure	≤ 2MPa	包装尺寸 Package size	35.5*14*21.5cm
风扇功率 Fan power	34W	风扇电压 Fan voltage	AC110V/AC220V-240V/AC380V/ DC12V/DC24V/50HZ
外翅片散热面积 Fan power	1.3 m ²	注：特殊电压特殊尺寸可按要求定制 Special voltage size can be customized	

产品线图 PRODUCT LINE DIAGRAM

性能曲线 PERFORMANCE CURVE

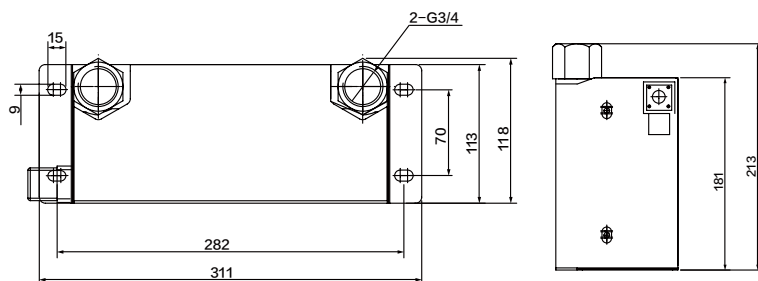
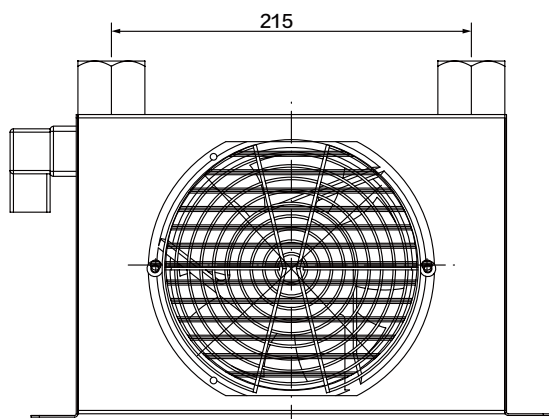

Heat diffusion function
散热性能

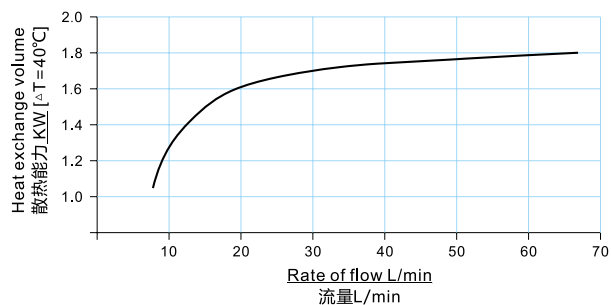

Pressure graph
压降图

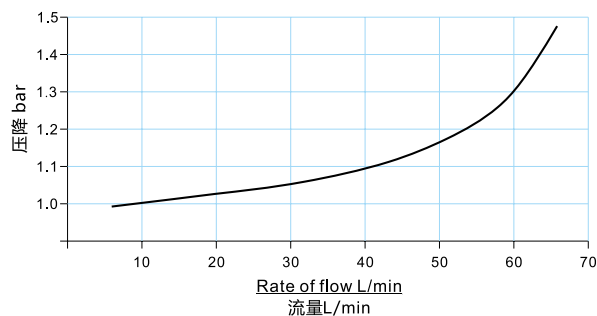

AJ 系列 X AJ SERIES

AJ0608TL



风冷却器 AIR COOLER



产品配置 PRODUCT CONFIGURATION			
形式 Form	AJ0608TL	冷却能力 Cooling capacity	2.4KW
流量 Flow	60L/min	重量 Weight	6KG
工作压力 Working pressure	≤ 2MPa	包装尺寸 Package size	44*14*21.5cm
风扇功率 Fan power	68W	风扇电压 Fan voltage	AC110V/AC220V-240V/AC380V/ DC12V/DC24V/50HZ
外翅片散热面积 Fan power	1.8 m ²	注：特殊电压特殊尺寸可按要求定制 Special voltage size can be customized	



产品线图 PRODUCT LINE DIAGRAM

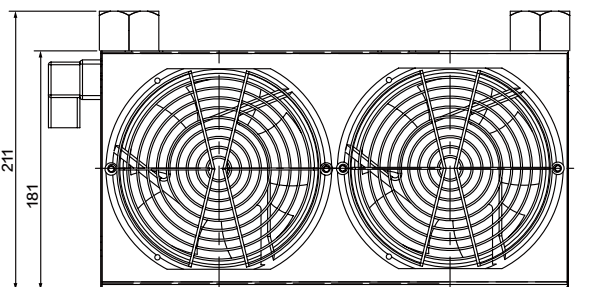

性能曲线 PERFORMANCE CURVE

Heat diffusion function
散热性能

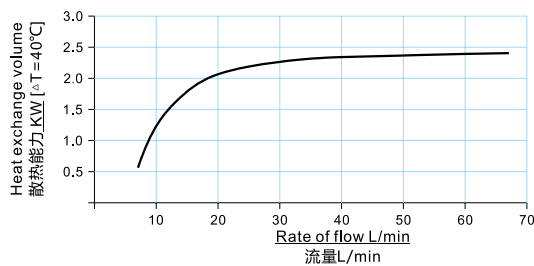

Pressure graph
压降图

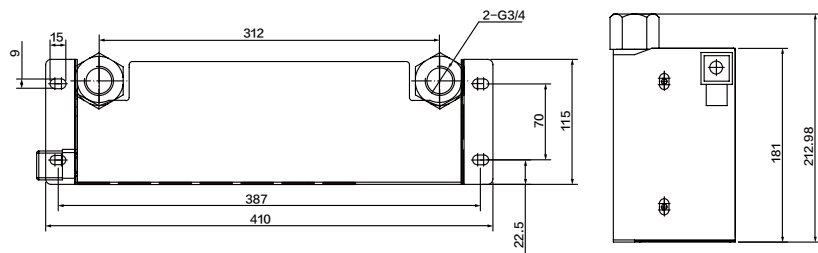
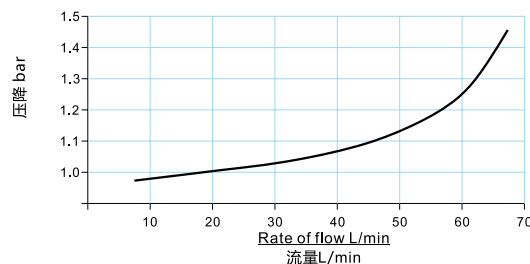

AJ 系列 X AJ SERIES

AJ1012T



风冷却器 AIR COOLER

产品配置 PRODUCT CONFIGURATION			
形式 Form	AJ1012T	冷却能力 Cooling capacity	5.8KW
流量 Flow	100L/min	重量 Weight	9.5KG
工作压力 Working pressure	≤ 2MPa	包装尺寸 Package size	45*22*37cm
风扇功率 Fan power	45/52W	风扇电压 Fan voltage	AC110V/AC220V-240V/AC380V/ DC12V/DC24V/50HZ
外翅片散热面积 Fan power	3.2 m ²	注：特殊电压特殊尺寸可按要求定制 Special voltage size can be customized	



产品线图 PRODUCT LINE DIAGRAM

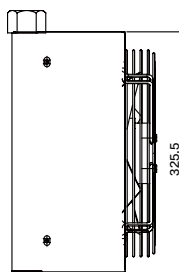
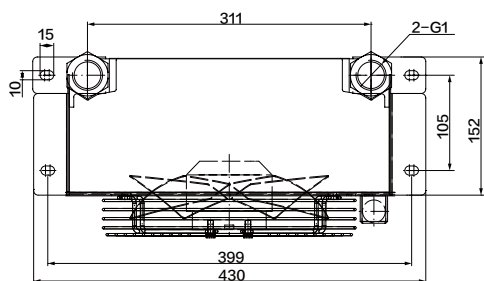
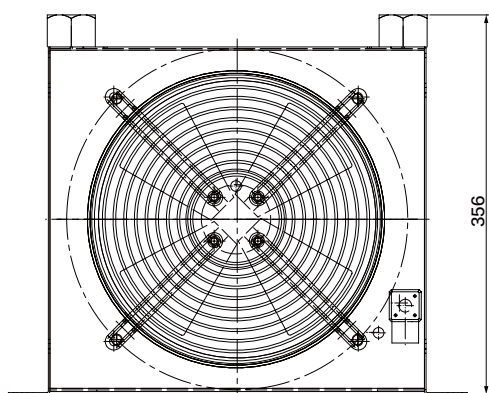

性能曲线 PERFORMANCE CURVE

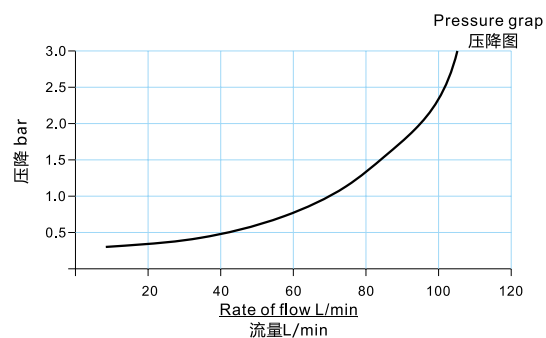
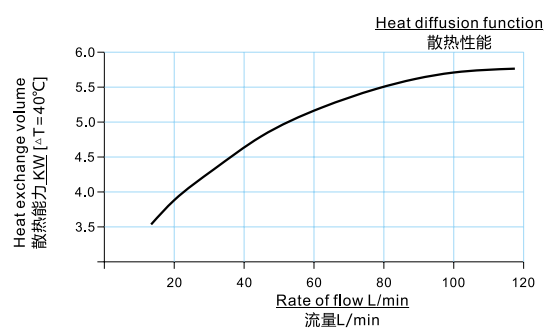

AJ 系列 X AJ SERIES

AF0510T-CA



风冷却器 AIR COOLER



产品配置 PRODUCT CONFIGURATION			
形式 Form	AF0510T-CA	冷却能力 Cooling capacity	1.2KW
流量 Flow	10L/min	重量 Weight	2KG
工作压力 Working pressure	≤ 1MPa	包装尺寸 Package size	24.5*12.5*22cm
风扇功率 Fan power	34W	风扇电压 Fan voltage	AC110V/AC220V-240V/AC380V/ DC12V/DC24V/50HZ
外翅片散热面积 Fan power	0.9 m ²	注：特殊电压特殊尺寸可按要求定制 Special voltage size can be customized	

产品线图 PRODUCT LINE DIAGRAM

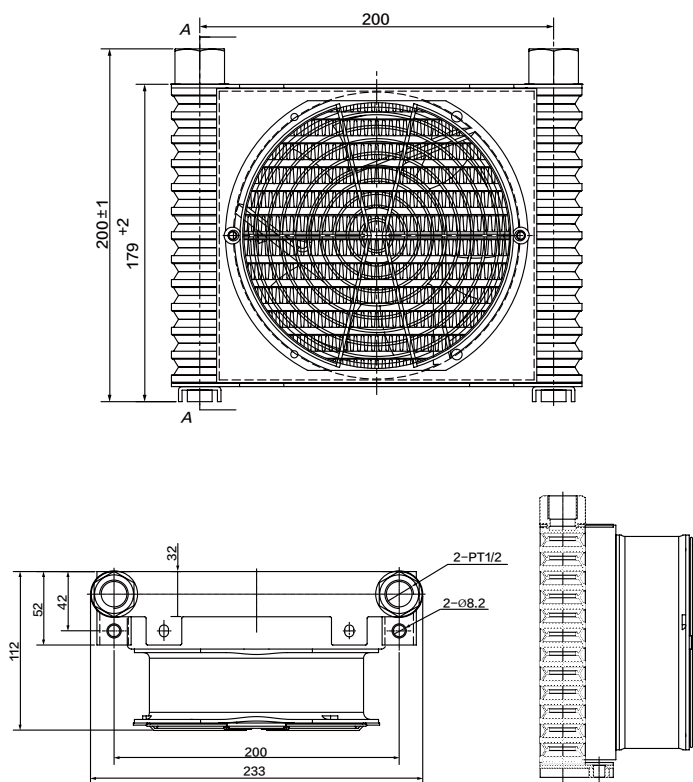

性能曲线 PERFORMANCE CURVE

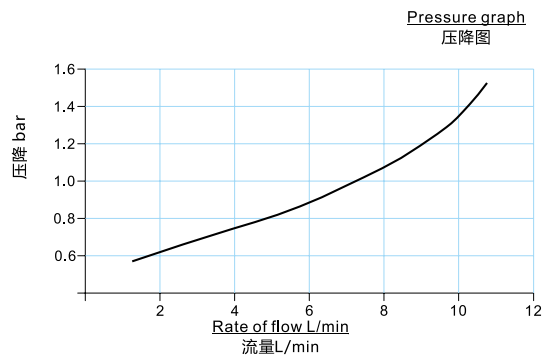
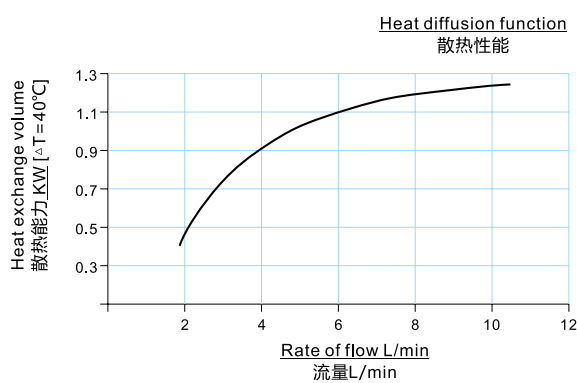

AF 系列 X AF SERIES

AF1025T-CA



风冷却器 AIR COOLER



产品配置 PRODUCT CONFIGURATION			
形式 Form	AF1025T-CA	冷却能力 Cooling capacity	1.35KW
流量 Flow	25L/min	重量 Weight	2.5KG
工作压力 Working pressure	≤ 1MPa	包装尺寸 Package size	26*12*26.5cm
风扇功率 Fan power	34W	风扇电压 Fan voltage	AC110V/AC220V-240V/AC380V/ DC12V/DC24V/50HZ
外翅片散热面积 Fan power	1.3 m ²	注：特殊电压特殊尺寸可按要求定制 Special voltage size can be customized	

产品线图 PRODUCT LINE DIAGRAM

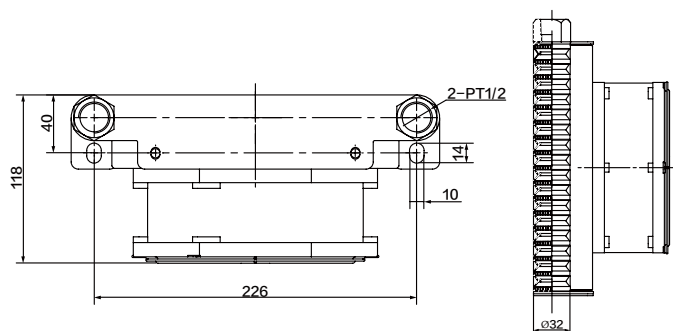
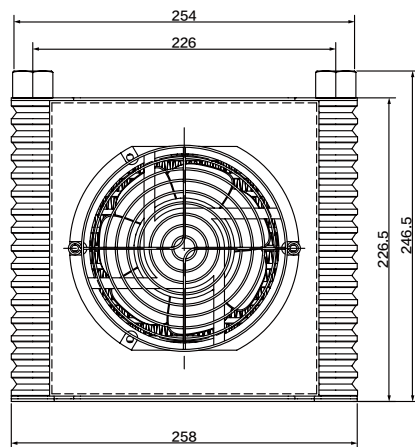

性能曲线 PERFORMANCE CURVE

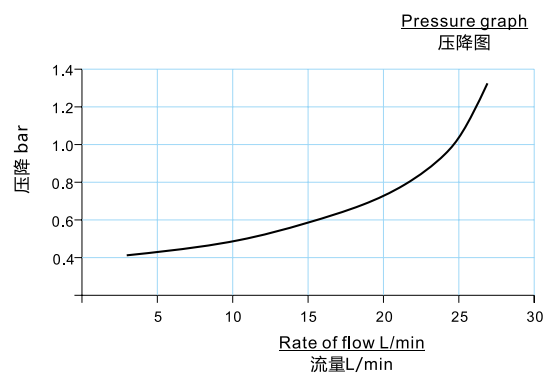
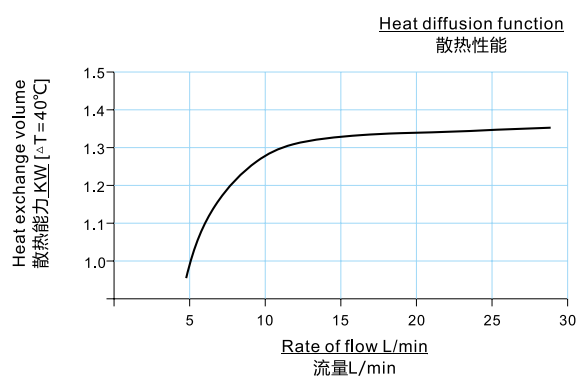

AL 系列 X AL SERIES

AL608T-CA



风冷却器 AIR COOLER



产品配置 PRODUCT CONFIGURATION			
形式 Form	AL608T-CA	冷却能力 Cooling capacity	0.8KW
流量 Flow	10L/min	重量 Weight	2KG
工作压力 Working pressure	≤ 1MPa	包装尺寸 Package size	26*12*22cm
风扇功率 Fan power	34W	风扇电压 Fan voltage	AC110V/AC220V-240V/AC380V/ DC12V/DC24V/50HZ
外翅片散热面积 Fan power	0.8 m ²	注：特殊电压特殊尺寸可按要求定制 Special voltage size can be customized	

产品线图 PRODUCT LINE DIAGRAM

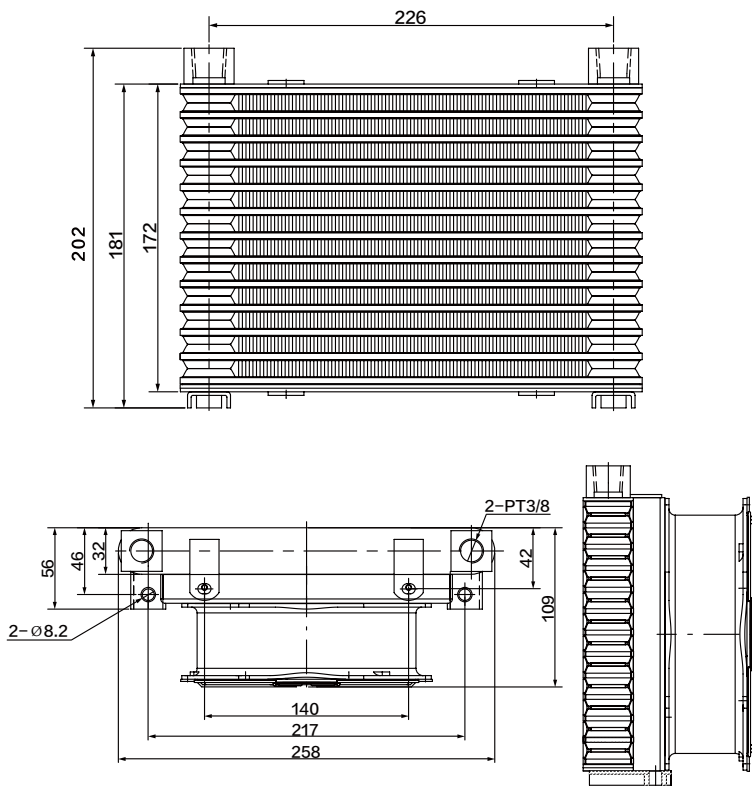

性能曲线 PERFORMANCE CURVE

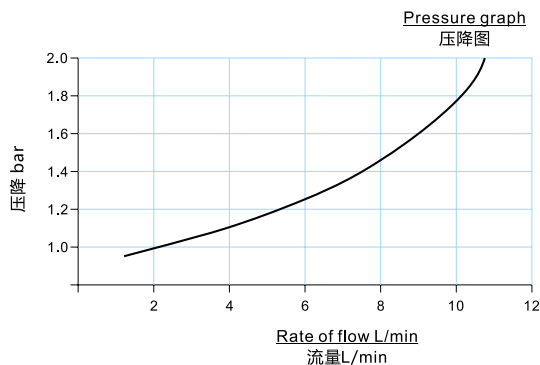
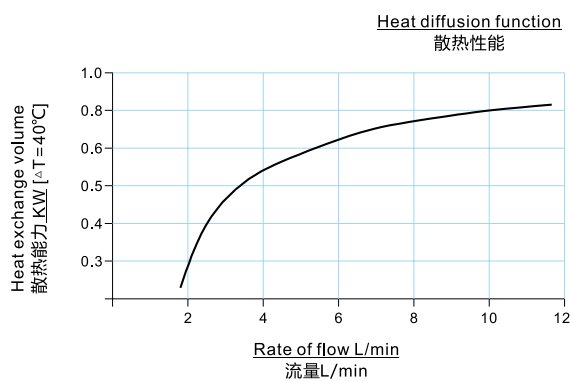

AL 系列 X AL SERIES

AL404T-CA



风冷却器 AIR COOLER



产品配置 PRODUCT CONFIGURATION			
形式 Form	AL404T-CA	冷却能力 Cooling capacity	1.2KW
流量 Flow	10L/min	重量 Weight	2.5KG
工作压力 Working pressure	≤ 1MPa	包装尺寸 Package size	26*13*22cm
风扇功率 Fan power	34W	风扇电压 Fan voltage	AC110V/AC220V-240V/AC380V/ DC12V/DC24V/50HZ
外翅片散热面积 Fan power	0.9 m ²	注：特殊电压特殊尺寸可按要求定制 Special voltage size can be customized	

产品线图 PRODUCT LINE DIAGRAM

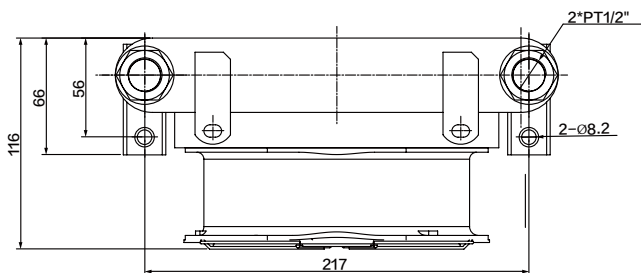
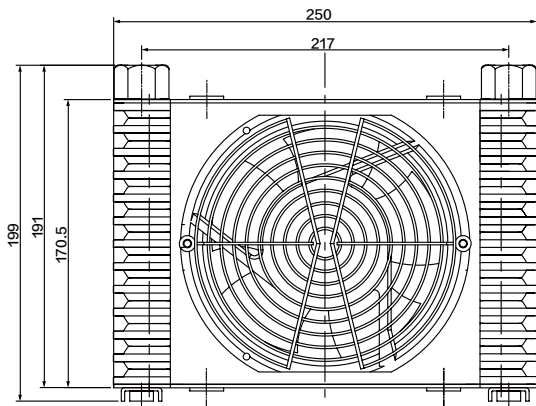

性能曲线 PERFORMANCE CURVE

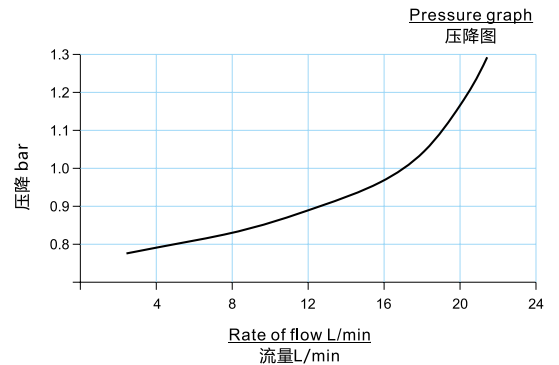
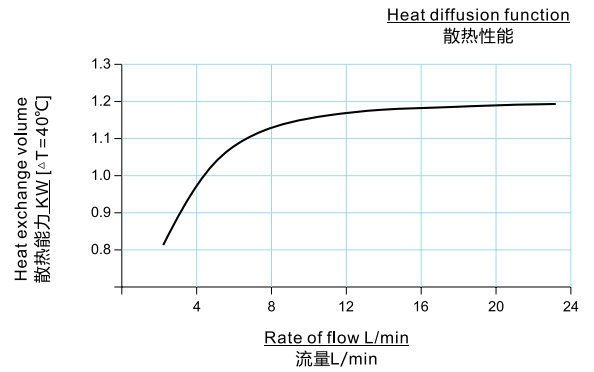

AH 系列 X AH SERIES

AH0607T-CA



风冷却器 AIR COOLER



产品配置 PRODUCT CONFIGURATION			
形式 Form	AH0607T-CA	冷却能力 Cooling capacity	1.05KW
流量 Flow	40L/min	重量 Weight	3.5KG
工作压力 Working pressure	≤ 2MPa	包装尺寸 Package size	28.5*14*22cm
风扇功率 Fan power	34W	风扇电压 Fan voltage	AC110V/AC220V-240V/AC380V/ DC12V/DC24V/50HZ
外翅片散热面积 Fan power	1m ²	注：特殊电压特殊尺寸可按要求定制 Special voltage size can be customized	

产品线图 PRODUCT LINE DIAGRAM

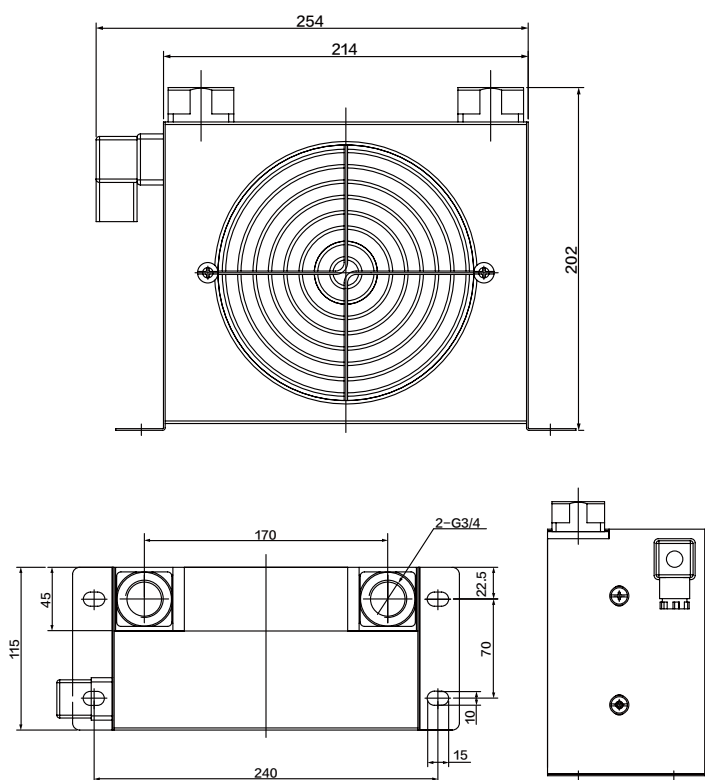

性能曲线 PERFORMANCE CURVE

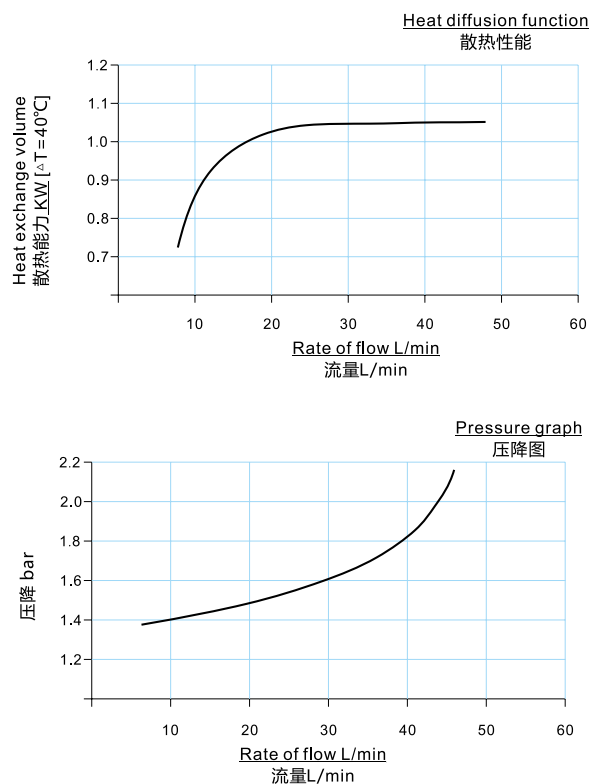

AH 系列 X AH SERIES

AH0608T-CA



风冷却器 AIR COOLER



产品配置 PRODUCT CONFIGURATION			
形式 Form	AH0608T-CA	冷却能力 Cooling capacity	1.8KW
流量 Flow	60L/min	重量 Weight	4KG
工作压力 Working pressure	≤ 2MPa	包装尺寸 Package size	35.5*14*21.5cm
风扇功率 Fan power	34W	风扇电压 Fan voltage	AC110V/AC220V-240V/AC380V/ DC12V/DC24V/50HZ
外翅片散热面积 Fan power	1.3 m ²	注：特殊电压特殊尺寸可按要求定制 Special voltage size can be customized	

产品线图 PRODUCT LINE DIAGRAM

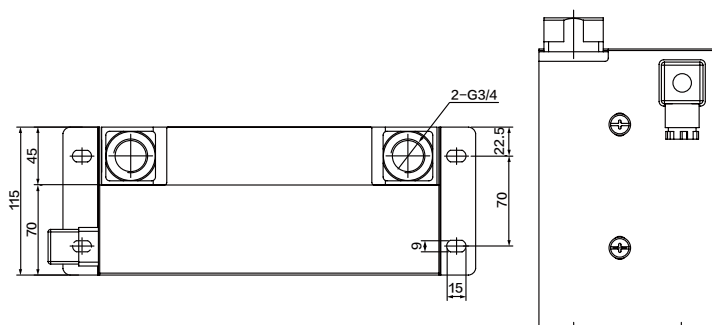
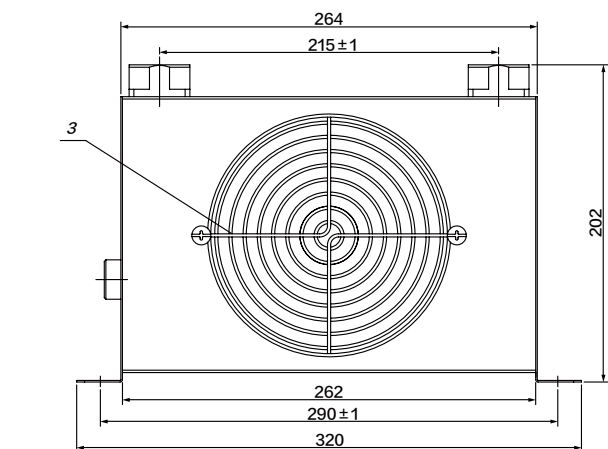

性能曲线 PERFORMANCE CURVE

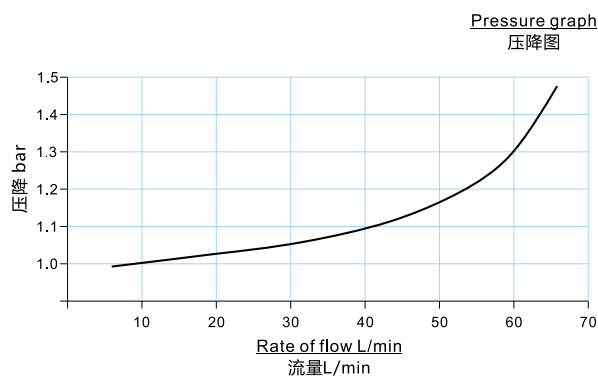
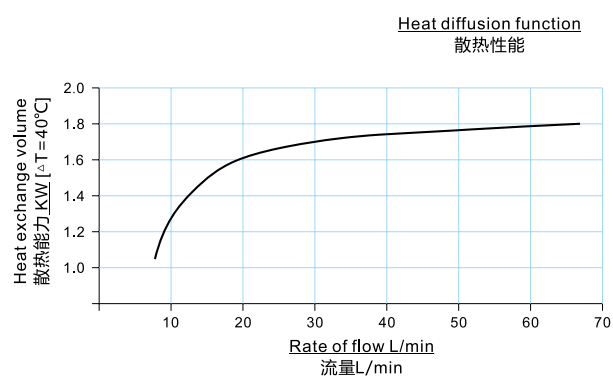

AH 系列 X AH SERIES

AH0608TL-CA



风冷却器 AIR COOLER



产品配置 PRODUCT CONFIGURATION			
形式 Form	AH0608TL-CA	冷却能力 Cooling capacity	2.4KW
流量 Flow	60L/min	重量 Weight	6KG
工作压力 Working pressure	≤ 2MPa	包装尺寸 Package size	44*14*21.5cm
风扇功率 Fan power	68W	风扇电压 Fan voltage	AC110V/AC220V-240V/AC380V/ DC12V/DC24V/50HZ
外翅片散热面积 Fan power	1.8 m ²	注：特殊电压特殊尺寸可按要求定制 Special voltage size can be customized	

产品线图 PRODUCT LINE DIAGRAM

性能曲线 PERFORMANCE CURVE

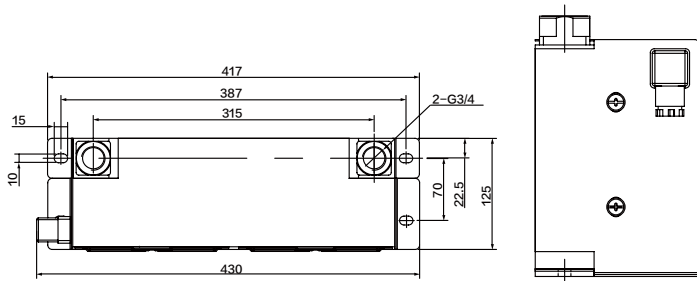
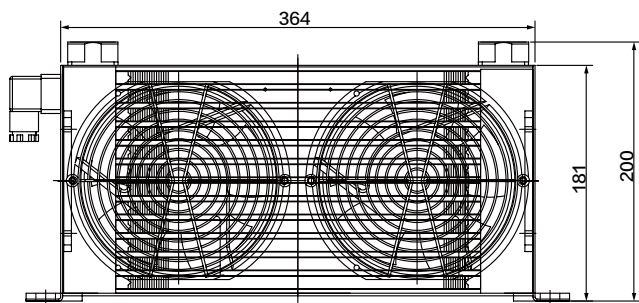

Heat diffusion function
散热性能

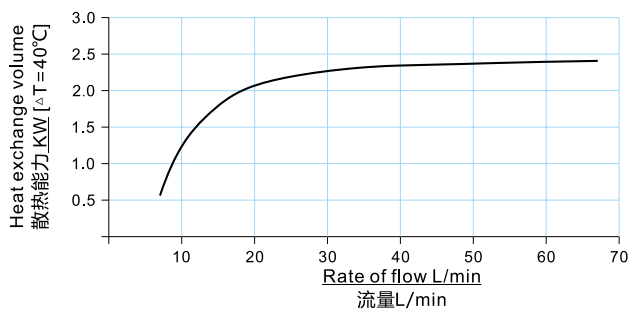

Pressure graph
压降图

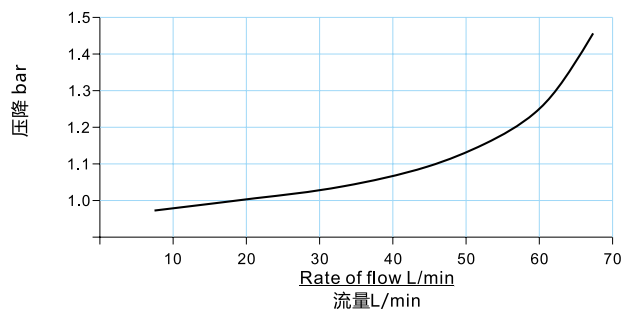

AH 系列 X AH SERIES

AH1012T



风冷却器 AIR COOLER

产品配置 PRODUCT CONFIGURATION			
形式 Form	AH1012T	冷却能力 Cooling capacity	5.8KW
流量 Flow	100L/min	重量 Weight	9.5KG
工作压力 Working pressure	≤ 2MPa	包装尺寸 Package size	45*22*37cm
风扇功率 Fan power	45/52W	风扇电压 Fan voltage	AC110V/AC220V-240V/AC380V/ DC12V/DC24V/50HZ
外翅片散热面积 Fan power	3.2 m ²	注：特殊电压特殊尺寸可按要求定制 Special voltage size can be customized	



产品线图 PRODUCT LINE DIAGRAM

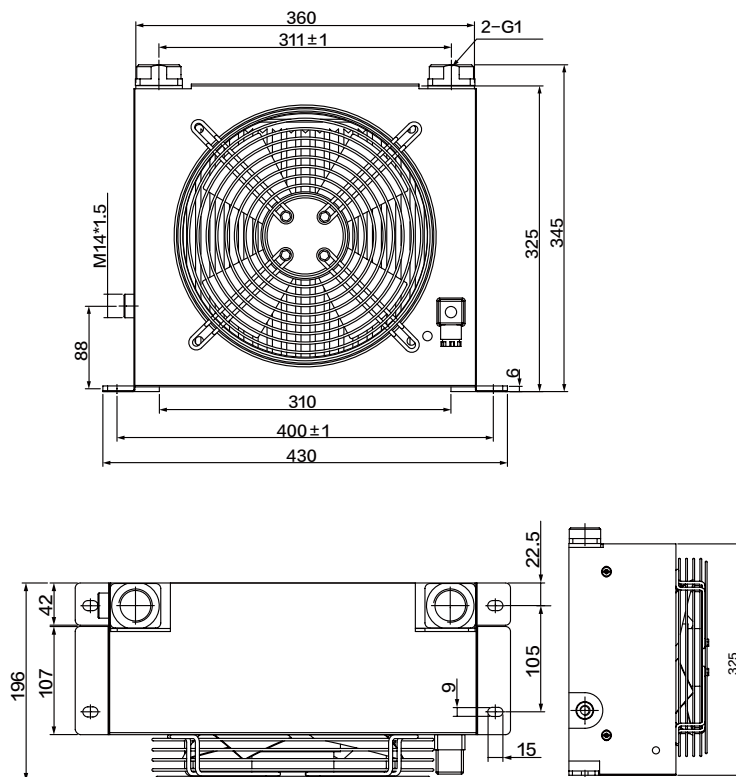

性能曲线 PERFORMANCE CURVE

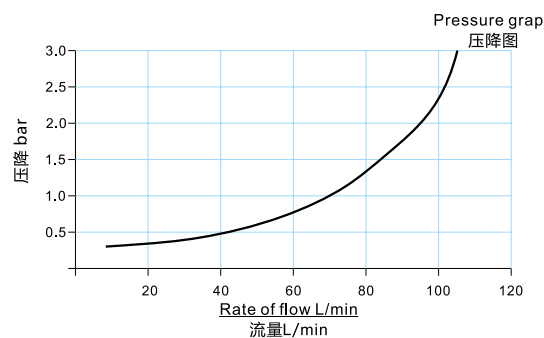
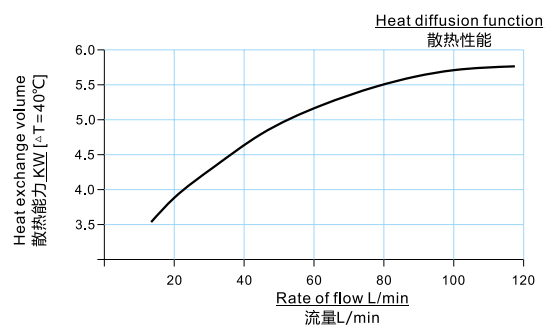

AH 系列 X AH SERIES

AH1012T1



风冷却器 AIR COOLER



产品配置 PRODUCT CONFIGURATION			
形式 Form	AH1012T1	冷却能力 Cooling capacity	5.8KW
流量 Flow	50L/min	重量 Weight	9.5KG
工作压力 Working pressure	≤ 2MPa	包装尺寸 Package size	45*22*35cm
风扇功率 Fan power	45/52W	风扇电压 Fan voltage	AC110V/AC220V-240V/AC380V/ DC12V/DC24V/50HZ
外翅片散热面积 Fan power	3.2 m ²	注：特殊电压特殊尺寸可按要求定制 Special voltage size can be customized	



产品线图 PRODUCT LINE DIAGRAM

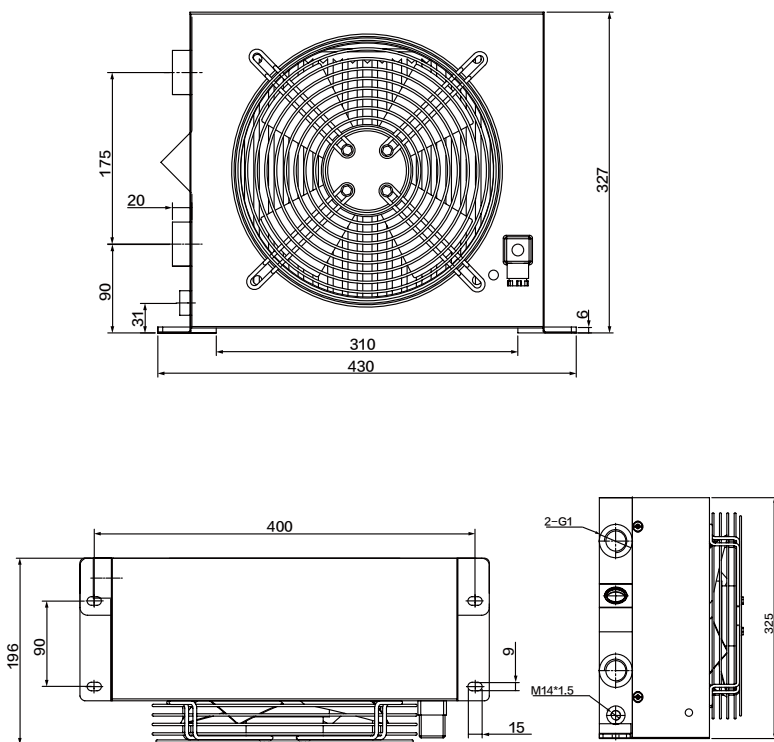

性能曲线 PERFORMANCE CURVE

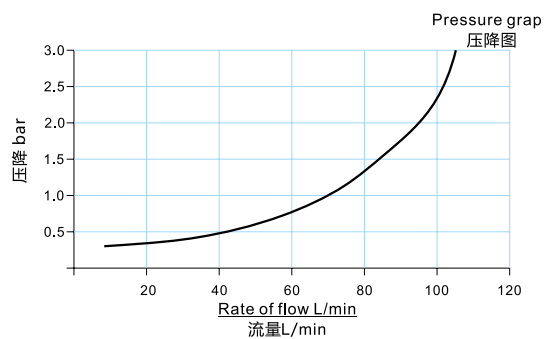
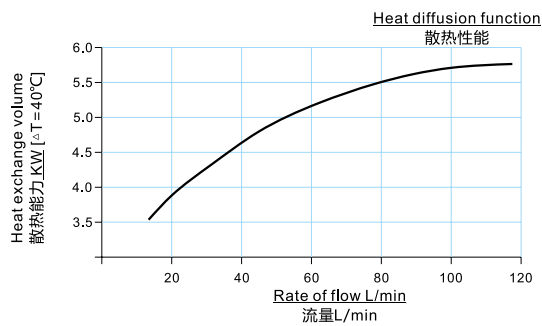



AH 系列 X AH SERIES

AH1012TB



风冷却器 AIR COOLER



产品配置 PRODUCT CONFIGURATION			
形式 Form	AH1012TB	冷却能力 Cooling capacity	5.8KW
流量 Flow	100L/min	重量 Weight	9.5KG
工作压力 Working pressure	≤ 2MPa	包装尺寸 Package size	45*22*37cm
风扇功率 Fan power	45W/52W	风扇电压 Fan voltage	AC110V/AC220V-240V/AC380V/ DC12V/DC24V/50HZ
外翅片散热面积 Fan power	3.2 m ²	注：特殊电压特殊尺寸可按要求定制 Special voltage size can be customized	

产品线图 PRODUCT LINE DIAGRAM

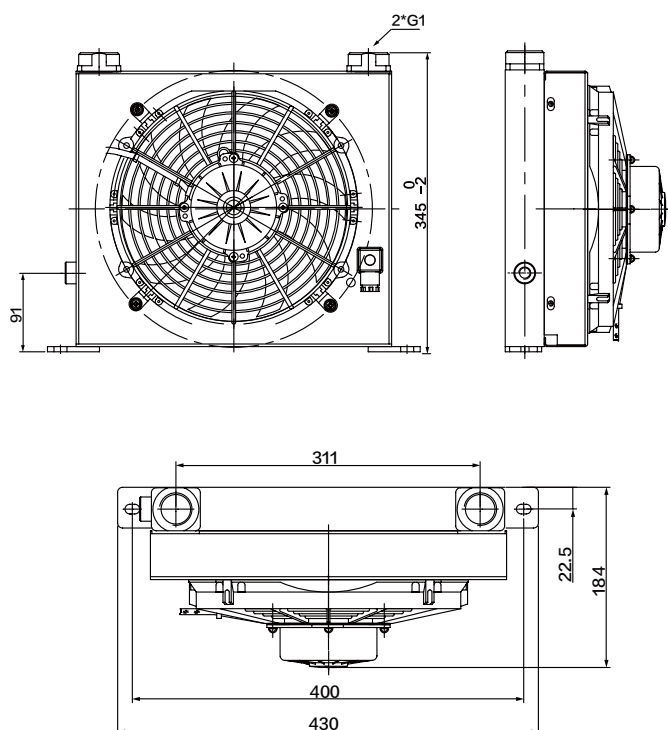

性能曲线 PERFORMANCE CURVE

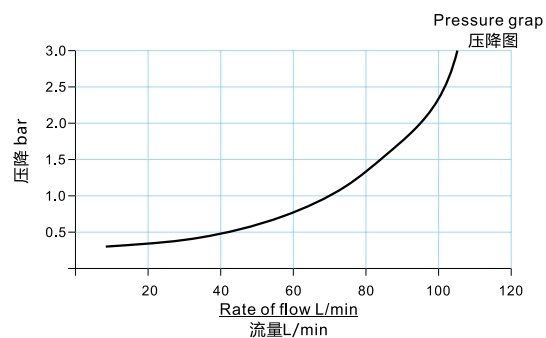
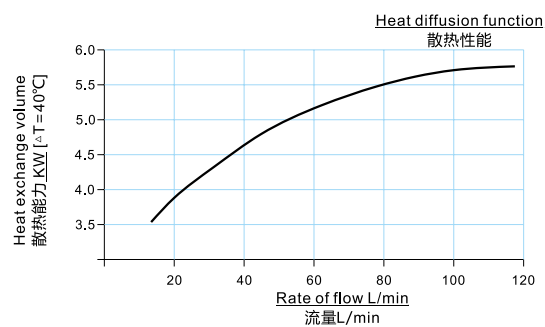

AH 系列 X AH SERIES

AH1417T-CA



风冷却器 AIR COOLER



产品配置 PRODUCT CONFIGURATION			
形式 Form	AH1417T-CA	冷却能力 Cooling capacity	8KW
流量 Flow	150L/min	重量 Weight	20.5KG
工作压力 Working pressure	≤ 2MPa	包装尺寸 Package size	58.5*35*41cm
风扇功率 Fan power	142W/135W	风扇电压 Fan voltage	AC110V/AC220V-240V/AC380V/ DC12V/DC24V/50HZ
外翅片散热面积 Fan power	6.2 m ²	注：特殊电压特殊尺寸可按要求定制 Special voltage size can be customized	

产品线图 PRODUCT LINE DIAGRAM

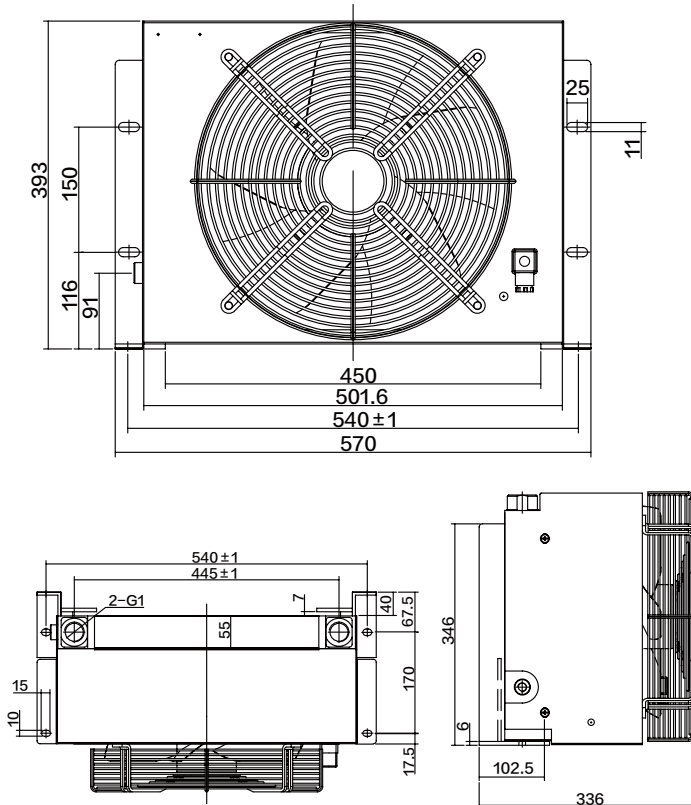

性能曲线 PERFORMANCE CURVE

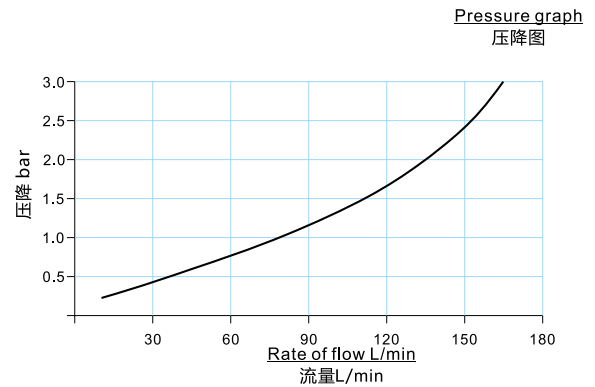
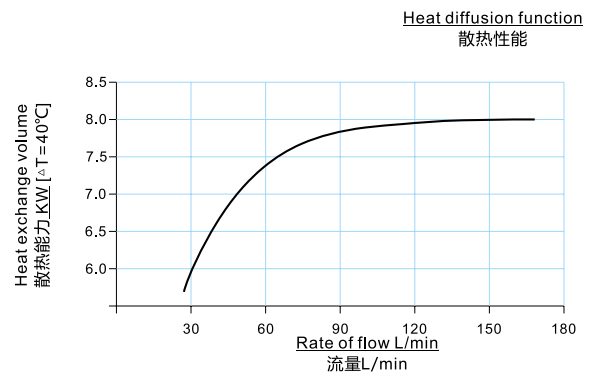

AH 系列 X AH SERIES

AH1417TB



风冷却器 AIR COOLER



产品配置 PRODUCT CONFIGURATION			
形式 Form	AH1417TB	冷却能力 Cooling capacity	8KW
流量 Flow	150L/min	重量 Weight	14.5KG
工作压力 Working pressure	≤ 2MPa	包装尺寸 Package size	58.5*35*41cm
风扇功率 Fan power	142W/135W	风扇电压 Fan voltage	AC110V/AC220V-240V/AC380V/ DC12V/DC24V/50HZ
外翅片散热面积 Fan power	6.2 m ²	注：特殊电压特殊尺寸可按要求定制 Special voltage size can be customized	

产品线图 PRODUCT LINE DIAGRAM

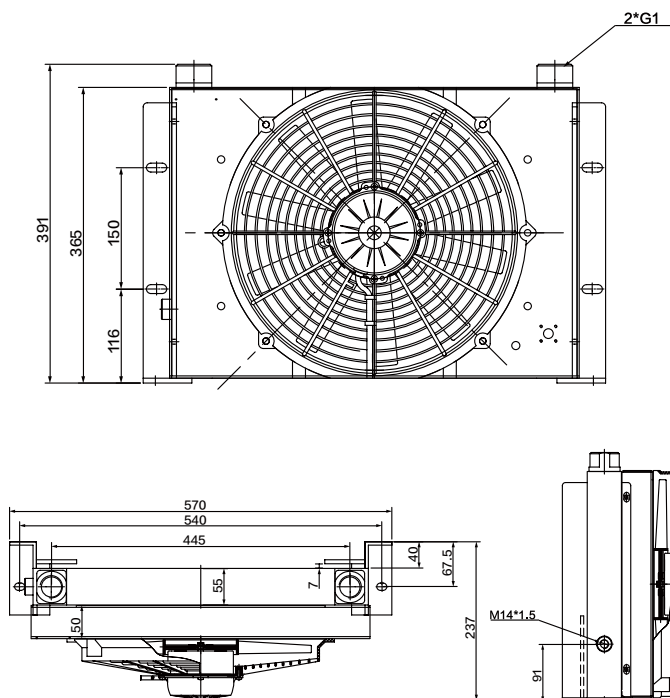

性能曲线 PERFORMANCE CURVE

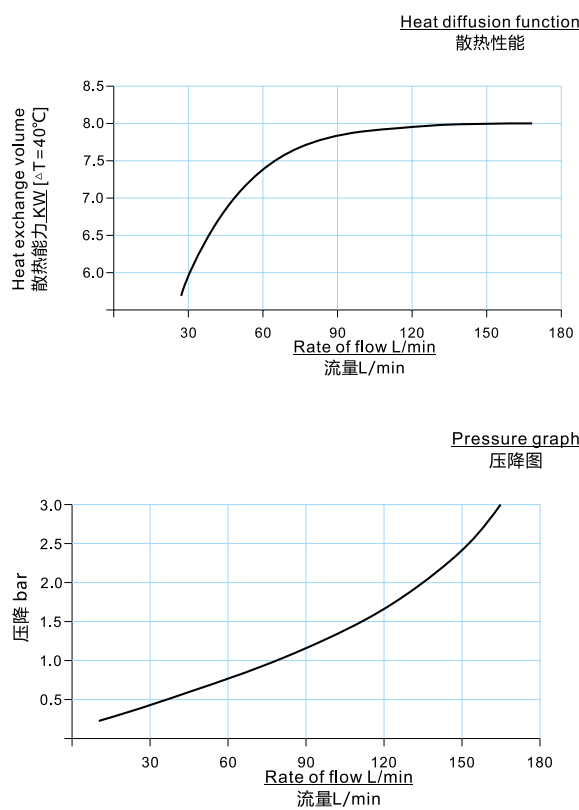

AH 系列 X AH SERIES

AH1470TB



风冷却器 AIR COOLER



产品配置 PRODUCT CONFIGURATION			
形式 Form	AH1470TB	冷却能力 Cooling capacity	8.8KW
流量 Flow	200L/min	重量 Weight	16KG
工作压力 Working pressure	≤ 2MPa	包装尺寸 Package size	59*36.5*41cm
风扇功率 Fan power	142W/135W	风扇电压 Fan voltage	AC110V/AC220V-240V/AC380V/ DC12V/DC24V/50HZ
外翅片散热面积 Fan power	8.3 m ²	注：特殊电压特殊尺寸可按要求定制 Special voltage size can be customized	

产品线图 PRODUCT LINE DIAGRAM

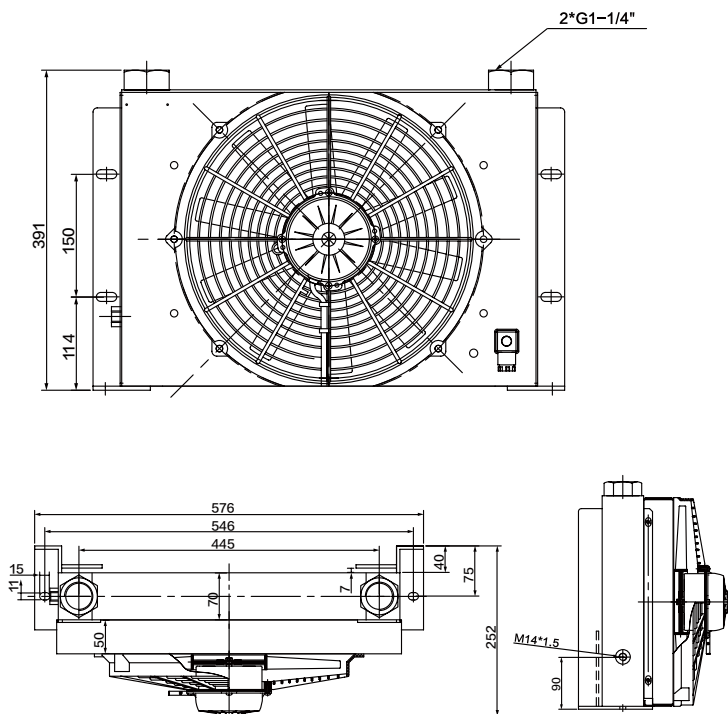

性能曲线 PERFORMANCE CURVE

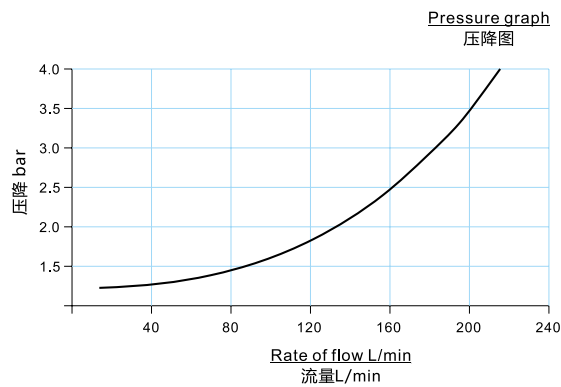
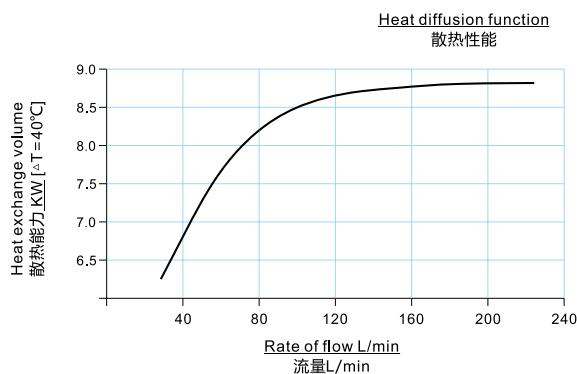

AH 系列 X AH SERIES

AH1470T-AC



风冷却器 AIR COOLER



产品配置 PRODUCT CONFIGURATION			
形式 Form	AH1470T-AC	冷却能力 Cooling capacity	8.8KW
流量 Flow	200L/min	重量 Weight	21.5KG
工作压力 Working pressure	≤ 2MPa	包装尺寸 Package size	59*36.5*41cm
风扇功率 Fan power	142W/135W	风扇电压 Fan voltage	AC110V/AC220V-240V/AC380V/ DC12V/DC24V/50HZ
外翅片散热面积 Fan power	8.3 m ²	注：特殊电压特殊尺寸可按要求定制 Special voltage size can be customized	

产品线图 PRODUCT LINE DIAGRAM

性能曲线 PERFORMANCE CURVE

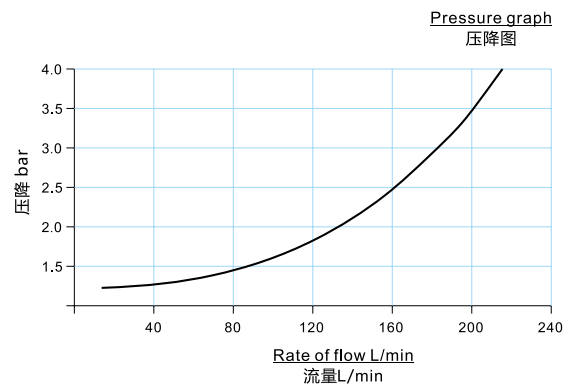
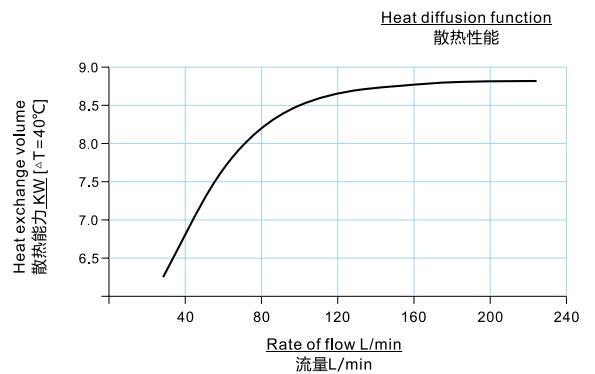
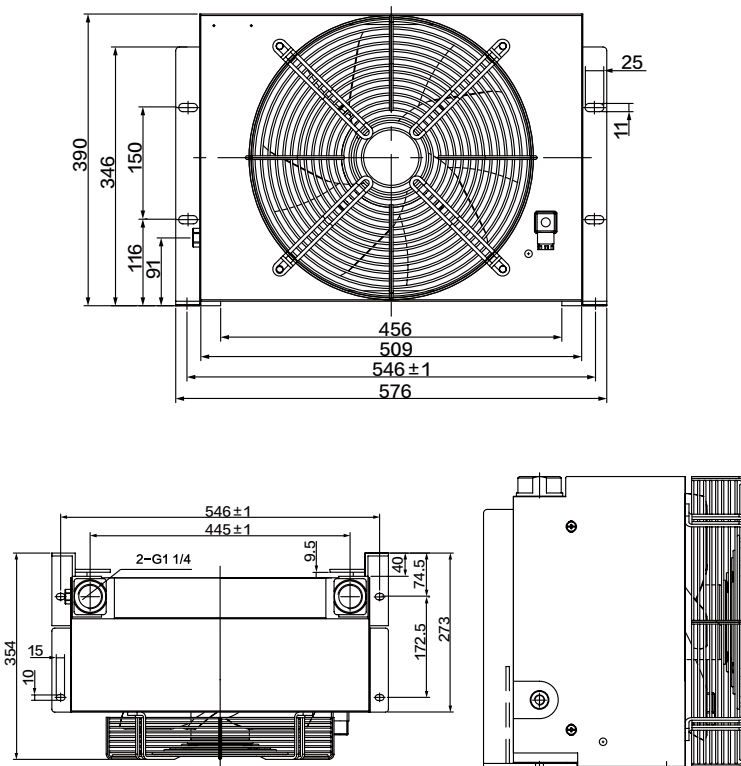

AH 系列 X AH SERIES

AH1490T-CA



风冷却器 AIR COOLER



产品配置 PRODUCT CONFIGURATION			
形式 Form	AH1490T-CA	冷却能力 Cooling capacity	11.5KW
流量 Flow	250L/min	重量 Weight	23KG
工作压力 Working pressure	≤ 2MPa	包装尺寸 Package size	59*38.5*41cm
风扇功率 Fan power	142W/135W	风扇电压 Fan voltage	AC110V/AC220V-240V/AC380V/ DC12V/DC24V/50HZ
外翅片散热面积 Fan power	10.5 m ²	注：特殊电压特殊尺寸可按要求定制 Special voltage size can be customized	

产品线图 PRODUCT LINE DIAGRAM

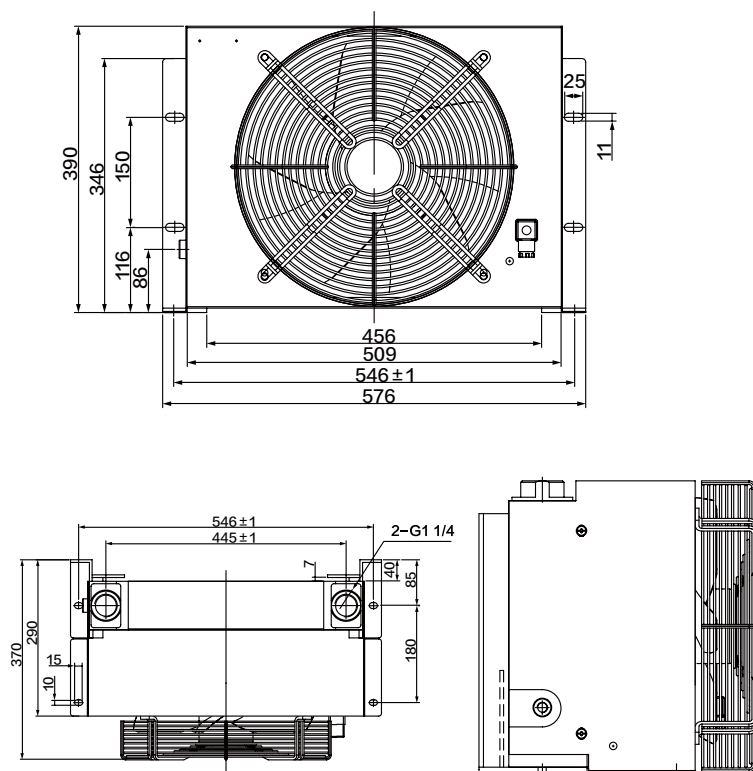

性能曲线 PERFORMANCE CURVE

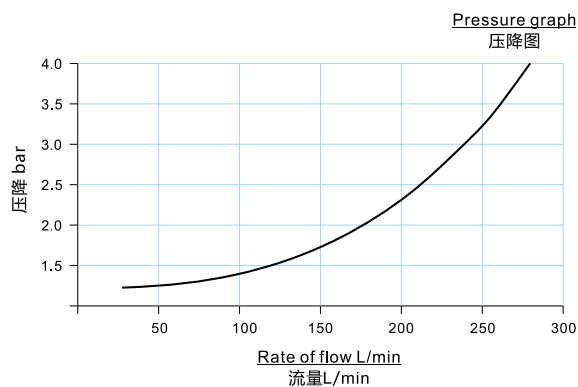
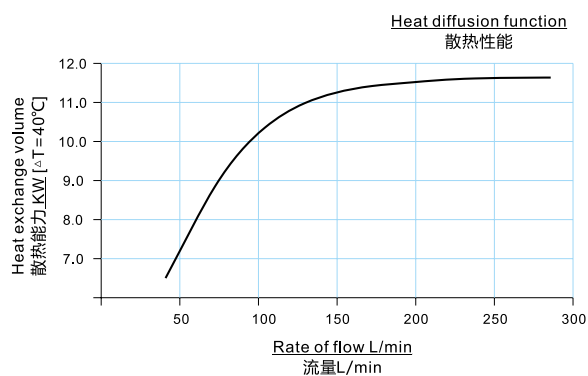

AH 系列 X AH SERIES

AH1490TB



风冷却器 AIR COOLER



产品配置 PRODUCT CONFIGURATION			
形式 Form	AH1490TB	冷却能力 Cooling capacity	11.5KW
流量 Flow	250L/min	重量 Weight	18KG
工作压力 Working pressure	≤ 2MPa	包装尺寸 Package size	59*36.5*41cm
风扇功率 Fan power	142W/135W	风扇电压 Fan voltage	AC110V/AC220V-240V/AC380V/ DC12V/DC24V/50HZ
外翅片散热面积 Fan power	10.5 m ²	注：特殊电压特殊尺寸可按要求定制 Special voltage size can be customized	

产品线图 PRODUCT LINE DIAGRAM

性能曲线 PERFORMANCE CURVE

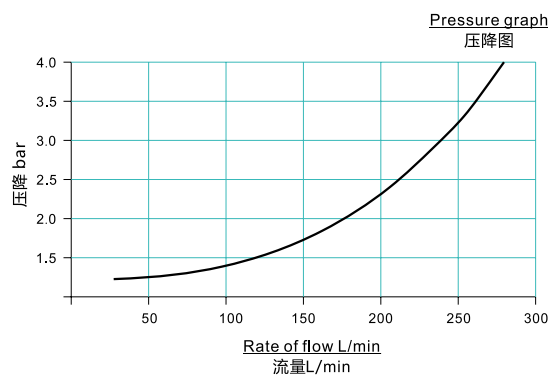
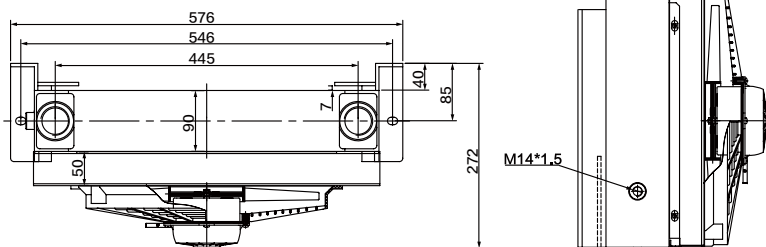
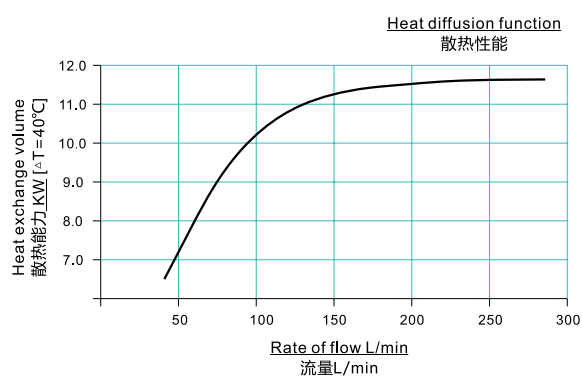
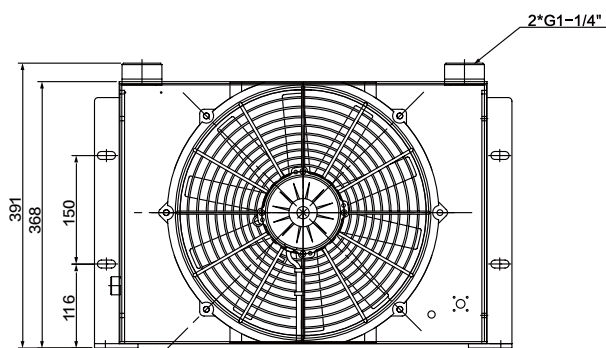

AH 系列 X AH SERIES

AH1680T-CA



风冷却器 AIR COOLER



产品配置 PRODUCT CONFIGURATION			
形式 Form	AH1680T-CA	冷却能力 Cooling capacity	19KW
流量 Flow	300L/min	重量 Weight	51KG
工作压力 Working pressure	≤ 2MPa	包装尺寸 Package size	82*42*66cm
风扇功率 Fan power	423W/448W	风扇电压 Fan voltage	AC220V-240V/AC380V/50HZ
外翅片散热面积 Fan power	14 m ²	注：特殊电压特殊尺寸可按要求定制 Special voltage size can be customized	

产品线图 PRODUCT LINE DIAGRAM

性能曲线 PERFORMANCE CURVE

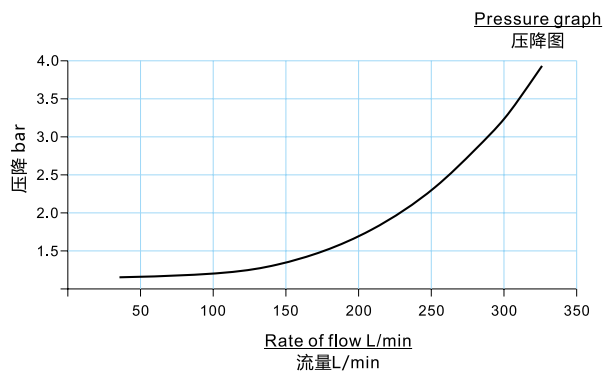
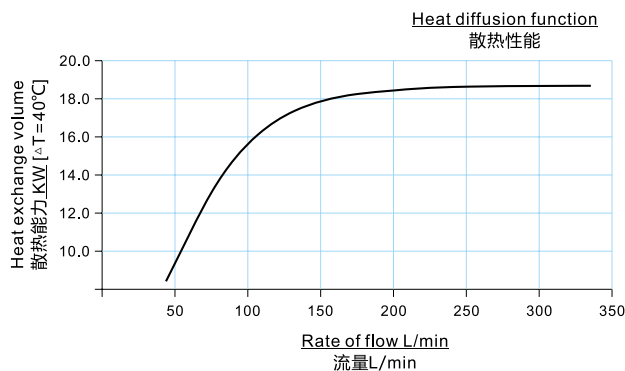
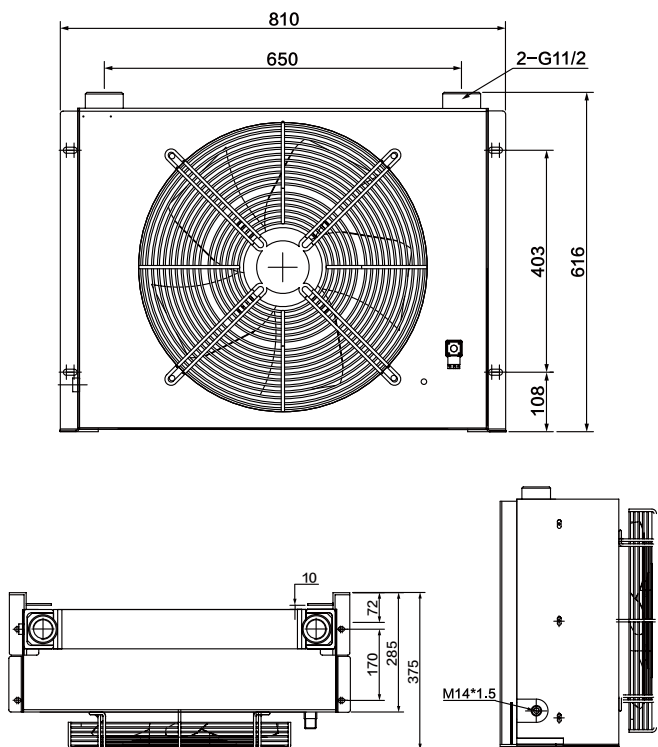

AH 系列 X AH SERIES

AH2431T-CA



风冷却器 AIR COOLER



产品配置 PRODUCT CONFIGURATION			
形式 Form	AH2431T-CA	冷却能力 Cooling capacity	34KW
流量 Flow	450L/min	重量 Weight	73KG
工作压力 Working pressure	≤ 2MPa	包装尺寸 Package size	92*46*84cm
风扇功率 Fan power	836W	风扇电压 Fan voltage	AC380V/50HZ
外翅片散热面积 Fan power	33.2 m ²	注：特殊电压特殊尺寸可按要求定制 Special voltage size can be customized	

产品线图 PRODUCT LINE DIAGRAM

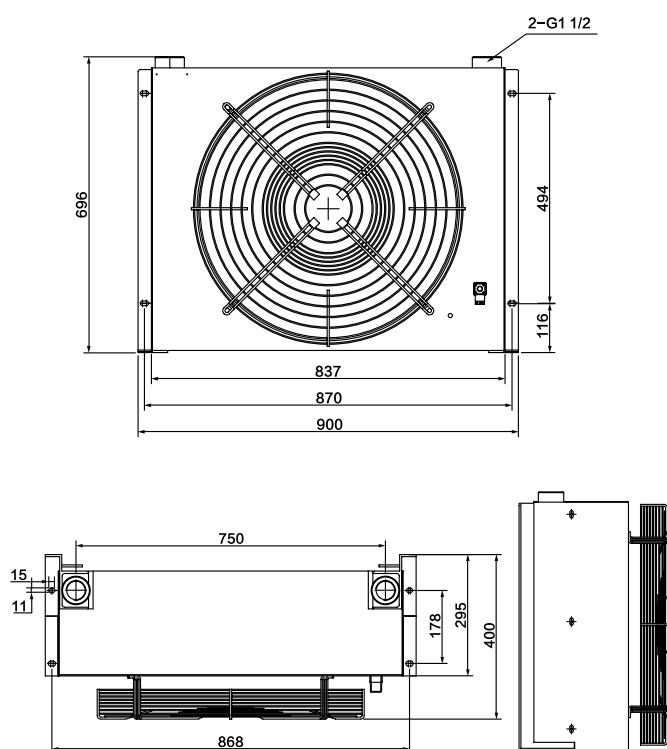

性能曲线 PERFORMANCE CURVE

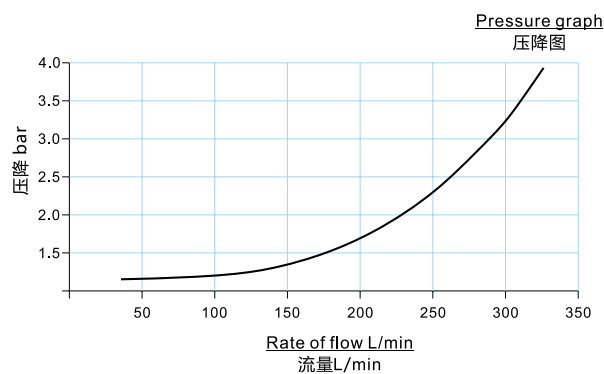
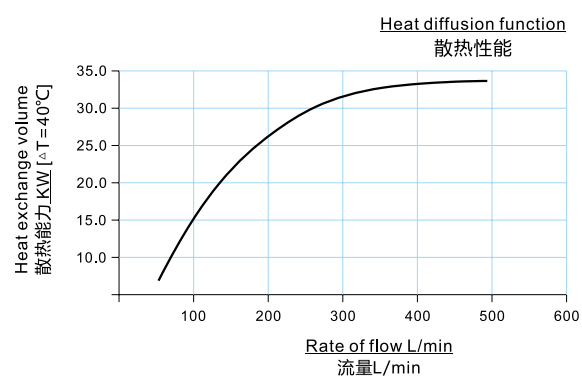

AH 系列 X AH SERIES

AH3818T-CA



风冷却器 AIR COOLER



产品配置 PRODUCT CONFIGURATION			
形式 Form	AH3818T-CA	冷却能力 Cooling capacity	58KW
流量 Flow	600L/min	重量 Weight	105KG
工作压力 Working pressure	≤ 2MPa	包装尺寸 Package size	96*57.5*112cm
风扇功率 Fan power	1494W	风扇电压 Fan voltage	AC220V-240V/AC380V/50HZ
外翅片散热面积 Fan power	48.2 m ²	注：特殊电压特殊尺寸可按要求定制 Special voltage size can be customized	

产品线图 PRODUCT LINE DIAGRAM

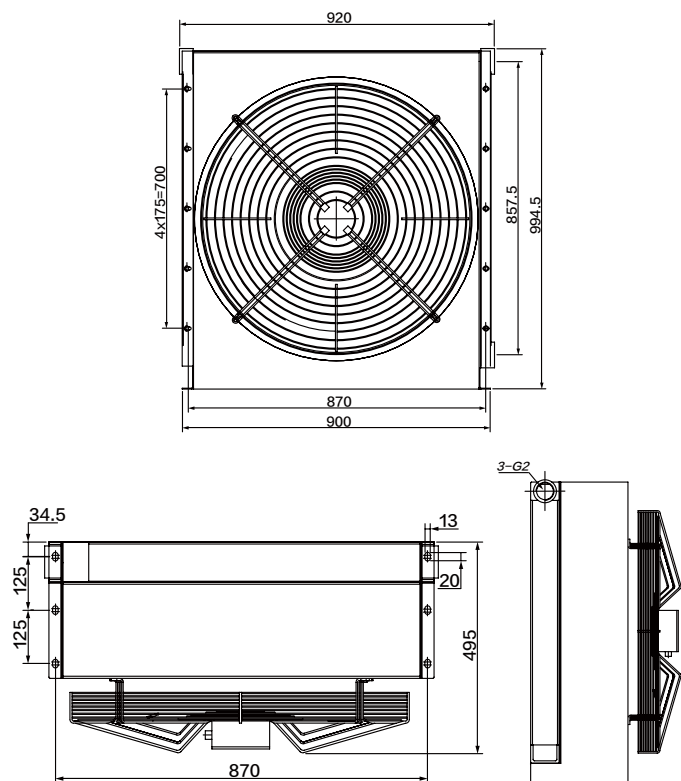

性能曲线 PERFORMANCE CURVE

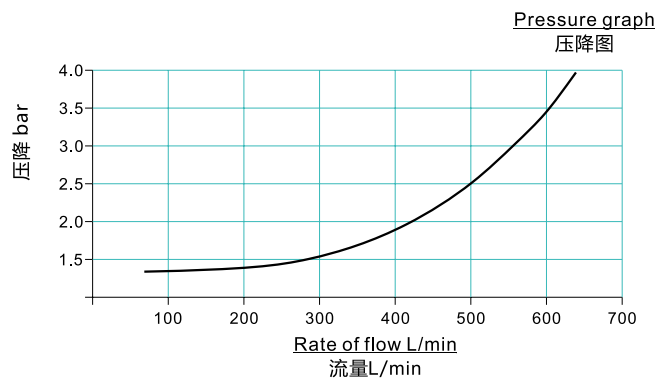
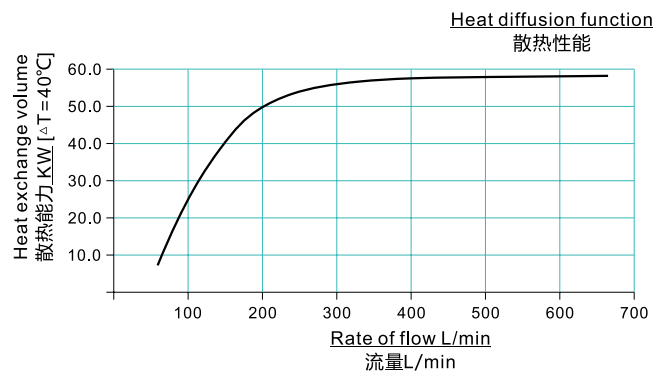

AJ 系列 X AJ SERIES

AJ5435T-36



矿机散热器 MINING MACHING HEAT SPREADER



产品配置 PRODUCT CONFIGURATION			
形式 Form	AJ5435T-36	冷却能力 Cooling capacity	10KW
流量 Flow	30L/min	重量 Weight	8KG
工作压力 Working pressure	≤ 2MPa	包装尺寸 Package size	55*39*18cm
风扇功率 Fan power	168W	风扇电压 Fan voltage	DC24V/AC220V-240V/AC380V/50HZ
外翅片散热面积 Fan power	5.7 m ²	注：特殊电压特殊尺寸可按要求定制 Special voltage size can be customized	

产品线图 PRODUCT LINE DIAGRAM

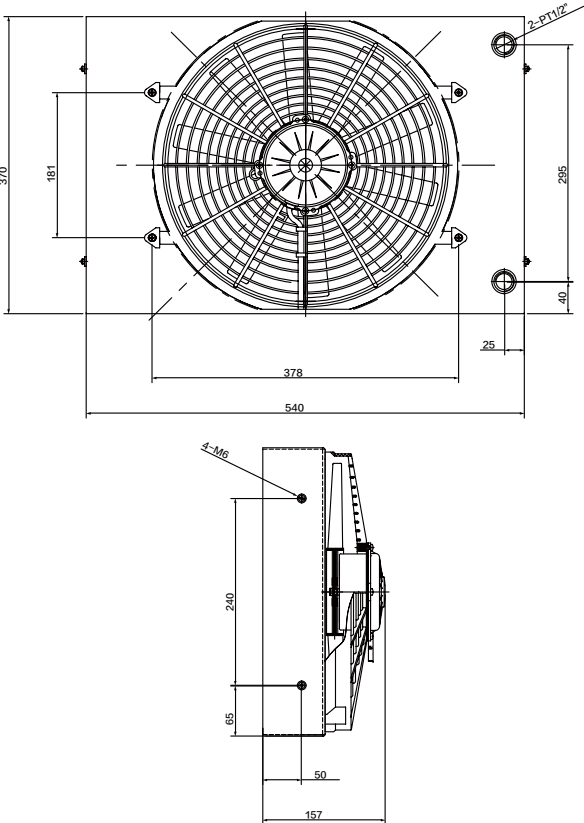

性能曲线 PERFORMANCE CURVE

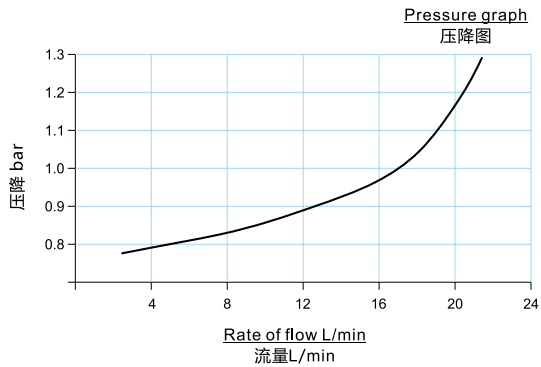
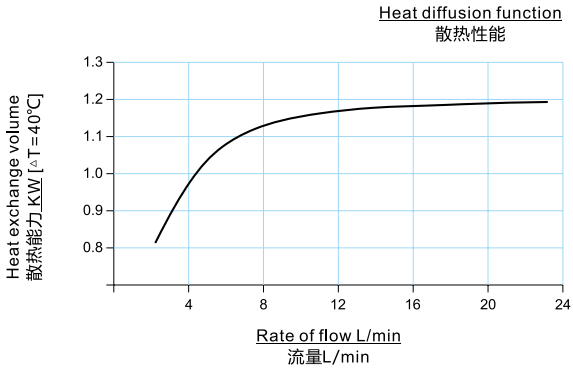

HPW-5A 系列 x HPW-5A SERIES

HPW-5A



热交换器 HEAT EXCHANGER

产品线图 PRODUCT LINE DIAGRAM

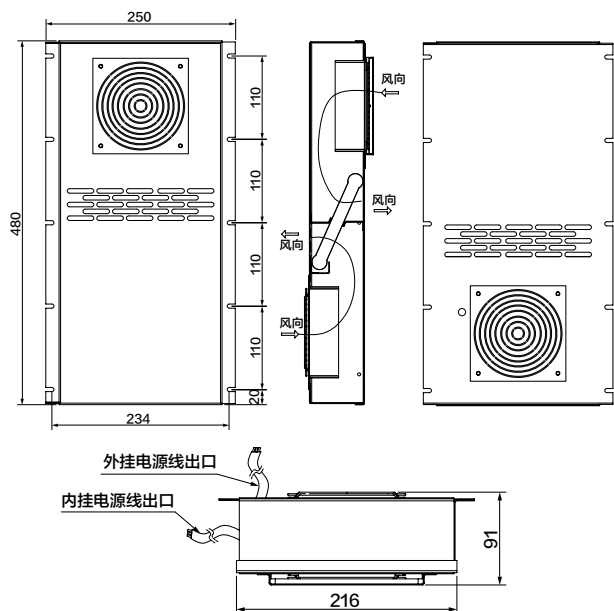

HPW-10A x HPW-10A SERIES

HPW-10A

产品线图 PRODUCT LINE DIAGRAM

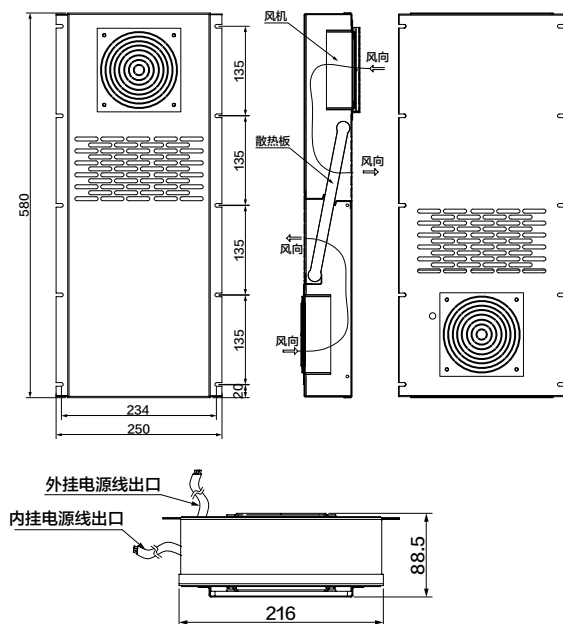

HPW-15A x HPW-5A SERIES

HPW-15A



热交换器 HEAT EXCHANGER

产品线图 PRODUCT LINE DIAGRAM

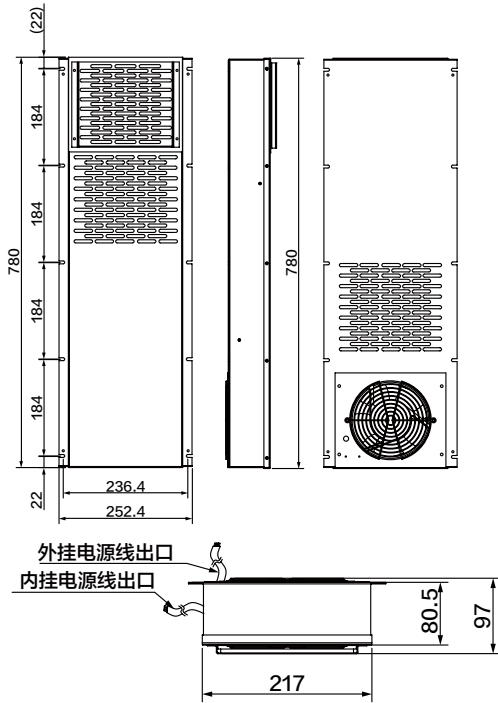

HPW-25A x HPW-5A SERIES

HPW-25A

产品线图 PRODUCT LINE DIAGRAM

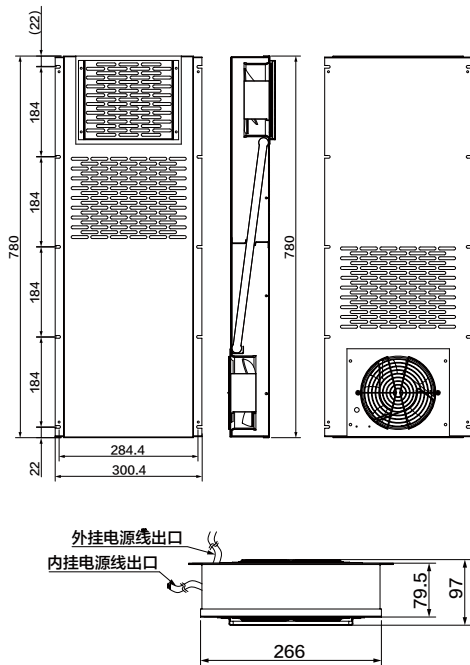

TOC 系列 X TOC SERIES

汽车变速箱油冷

TOC (AUTOMOTIVE)



改装车发动机油冷器

Engine Oil Cooler of modified car

内部湍流结构通道，外部波浪百叶窗散热带；

全铝合金一体钎焊制造、轻质耐用；

加装油冷器后降低波箱油温 5-15 摄氏度，快速换挡变速；

提升加速马力及省油效果，提高 ATF 自排油及变速箱寿命；

Internal turbulence channel with efficient external wavy fin radiator.

Made with Aluminum alloy, light and durable.

Drop the oil temperature in 5-15° C to run at high speed.

Engine temperature drop down directly, improve the viscosity of lubricating oil to be more lubrication performance.

Protect the engine, save fuel oil and enhance dynamic endurance.



变速箱油冷 TOC- 零件

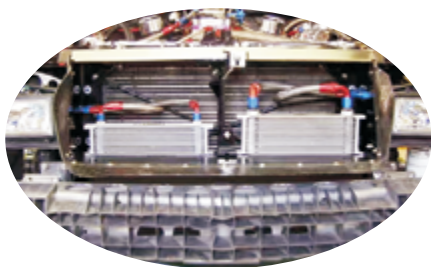

加装到发动机



产品线图 PRODUCT LINE DIAGRAM

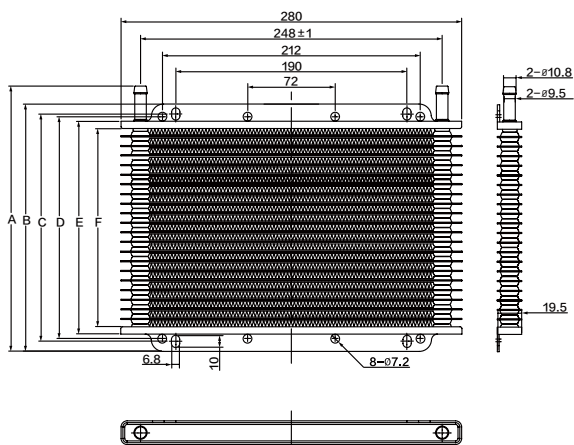

产品配置 PRODUCT CONFIGURATION

TOC-30P	30	298	284	268	263	255	242
TOC-24P	24	247	233	217	212	204	191
TOC-23P	26	243	229	213	208	200	187
TOC-21P	22	227	213	197	192	184	171
TOC-20P	20	220	206	190	185	177	164
TOC-12P	12	156	142	126	121	113	100
规格/型号	流道层数	A	B	C	D	E	F

AF261T 系列 X TOC SERIES

汽车发动机油冷

EOC (AUTOMOTIVE)

改装车发动机油冷器

Transmission oil cooler of modified car

内部湍流结构通道，外部波浪百叶窗散热带；

全铝合金一体钎焊制造、轻质耐用；

加装油冷器后降低波箱油温 5-15 摄氏度，快速换挡变速；

提升加速马力及省油效果，提高 ATF 自排油及变速箱寿命；

Internal turbulence channel with efficient external wavy fin radiator.

Made with Aluminum alloy, light and durable.

Drop the oil temperature in 5-15°C to run at high speed, make the gear-shift change quickly.

Save fuel oil and enhance dynamic endurance, improve ATF self-draining oil and longer the gearbox life.

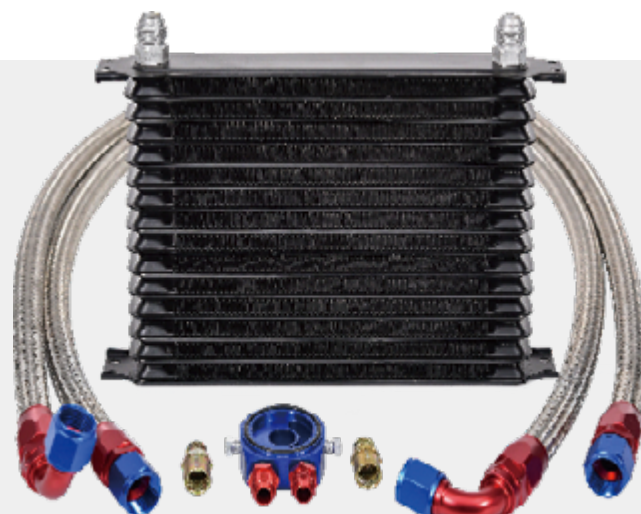

发动机油冷 261- 零件



加装到发动机



产品线图 PRODUCT LINE DIAGRAM

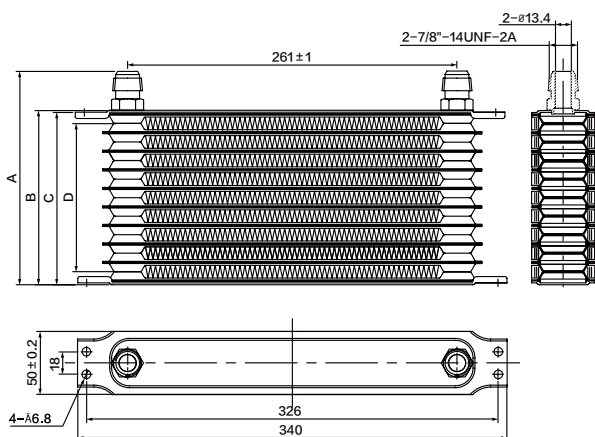

产品配置 PRODUCT CONFIGURATION

规格/型号	流道层数	A	B	C	D
AF261T-19P	17	295	267	266	246
AF261T-15P	15	240	211	210	190
AF261T-13P	13	210	182	180	160
AF261T-10P	10	165	136	134	116
AF261T-7P	7	123	94	93	73

矿山机械系列 X MINING MACHINERY SERIES

RS1500-KS



风冷却器 AIR COOLER

型号 Model	RS700-KS	RS1000-KS	RS1500-KS
流量 Flow	700L/min	1000L/min	1500L/min
最高工作压力 Working pressure	≤ 2MPa	≤ 2MPa	≤ 2MPa
冷却能力 Cooling capacity	140KW	260KW	430KW
风扇功率 Fan power	5.5KW	5.5KW	5.5KW
风扇电压 Fan Voltage	AC110V/ AC220V-240V/ AC380V/ 50HZ		

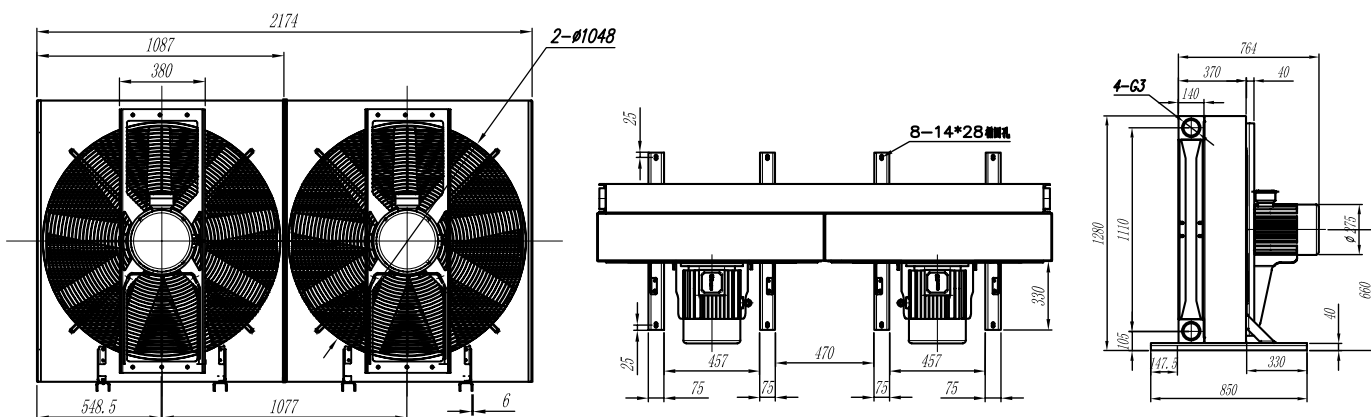

油缸

OIL CYLINDER

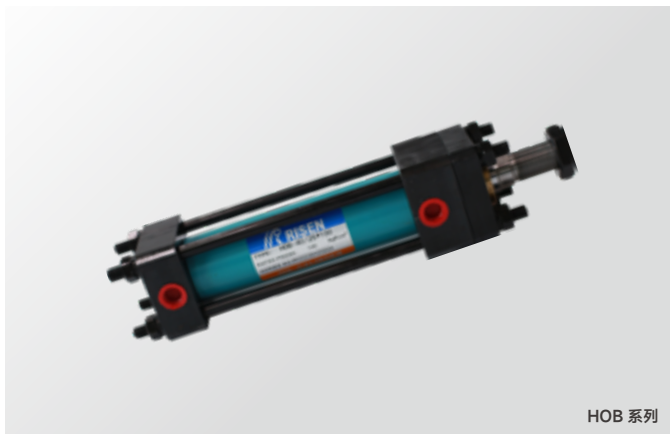

MINGING MACHINE, SEVER ETC. NON-STANDARD CUSTOMIZED



矿机、服务器等非标定制

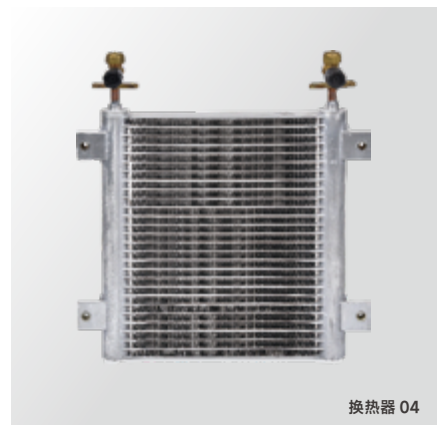
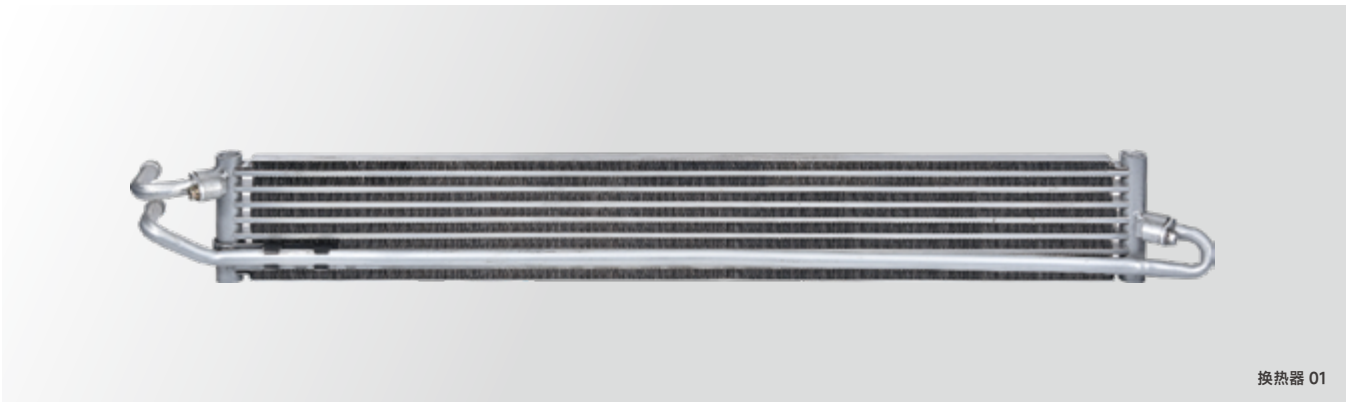
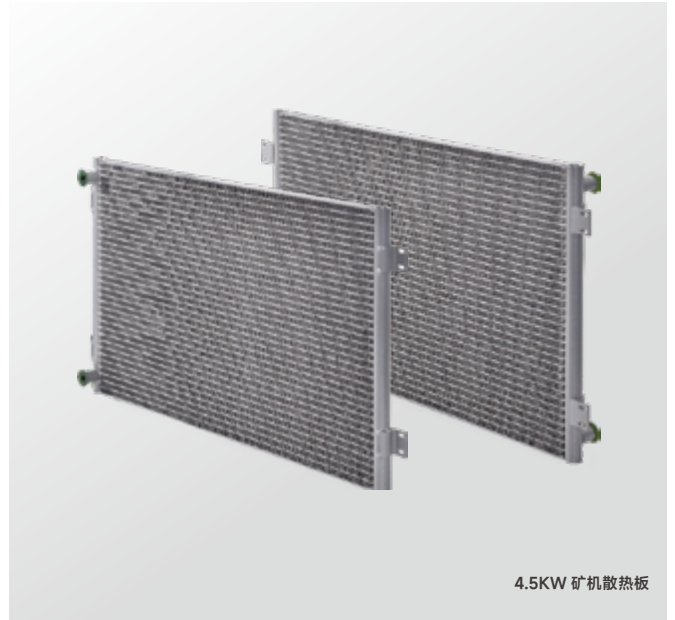
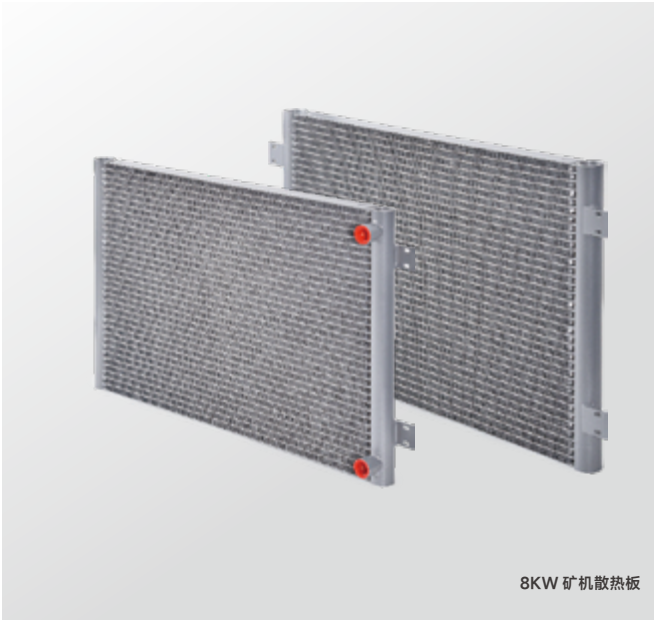

工程案例系列 × ENGINEERING CASE SERIES
工程案例

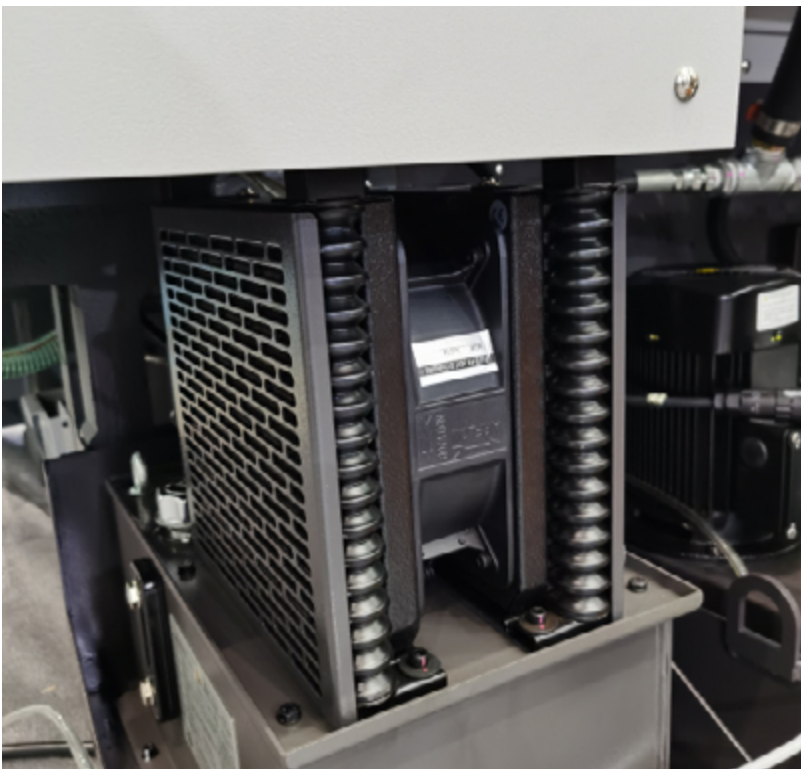

工程案例系列 X ENGINEERING CASE SERIES

工程案例

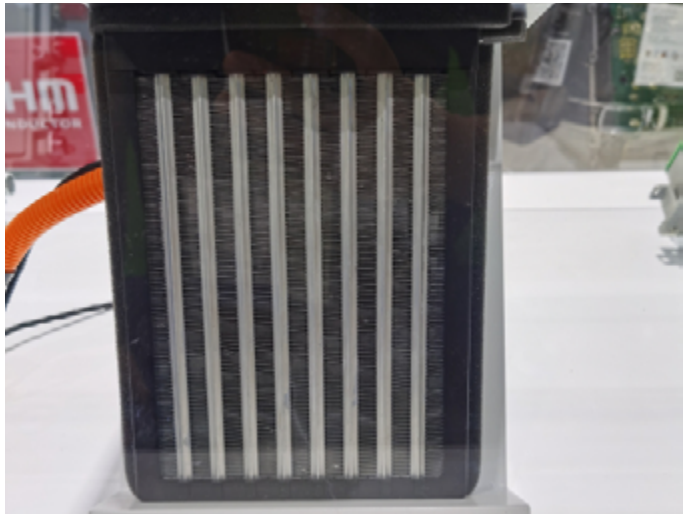

工程案例系列 × ENGINEERING CASE SERIES

工程案例



工程案例系列 X ENGINEERING CASE SERIES

工程案例

