



Amy: +86 13032642700



Lucy: +86 15232126215



Helen: +86 15232123715



Zhongchuang Hydraulics

CUSTOM SOLUTIONS FOR HYDRAULIC CYLINDERS

Good cylinder creation
Zhongchuang Manufacturing



High quality start with the details
Professional and ingenious manufacturing



Hebei Zhongchuang Hydraulic Machinery Co., Ltd.

HEBEI ZHONGCHUANG HYDRAULIC MACHINERY CO., LTD.

Company Address: Room 912, Building B, Hongsheng Business Plaza, Zhaiying South Street, Yuhua District,
Shijiazhuang City, Hebei Province, China

Factory Address: City level Industrial Zone, Dalucun Town, Ningjin County, Xingtai City, Hebei Province, China

Phone:0319-5661666 Fax:0319-5661888

Website: www.zy-hydrauliccylinder.com

E-mail: Gavin@zy-hydrauliccylinder.com sales1@zy-hydrauliccylinder.com

sales2@zy-hydrauliccylinder.com sales3@zy-hydrauliccylinder.com

sales4@zy-hydrauliccylinder.com



COMPANY PROFILE

Hebei Zhong chuang Hydraulic Machinery Co., Ltd. is located in the Ningjin Industrial Park, a famous hydraulic city in China. It is adjacent to National Highway 308 and 50 kilometers away from the provincial capital Shijiazhuang. To the west is the Beijing Hong Kong Macao Expressway and the Beijing Guangzhou Railway, while to the east is the Da Guang Expressway and the Beijing Kowloon Railway. The Qingyin Expressway runs through the east and west, providing a superior environment and convenient transportation.

Hebei Zhong chuang Hydraulic Technology Co., Ltd. is a technical enterprise specializing in the manufacturing of hydraulic cylinders, with an annual output of 200000 sets. It mainly supports various types of hydraulic cylinders for various vehicles and machinery, including welded single acting, double acting, and high-pressure cylinders. According to customer

needs, hydraulic cylinders with a maximum diameter of 380mm and a maximum stroke of 10 meters can be customized.

The company relies on advanced processing equipment, rigorous process control, and precise testing methods to ensure high-quality and reliable product quality! The young and capable production team ensures timely and efficient delivery! Perfect design, integrating cutting-edge domestic and international technologies, Zhong chuang Hydraulic will serve customers better with higher technological content!

Make friends from all over the world and strive for harmonious development. Zhong chuang Hydraulic is willing to sincerely cooperate with you, work hand in hand, and create brilliance together!

CORPORATE HONOR

Honor is a kind of responsibility, unity is a kind of strength, cooperation is our choice, running in the ideal direction, to achieve common goals, we hand in hand, create infinite brilliance!



PRODUCT DISPLAY

Zhong chuang Hydraulic payattention to product quality,continue to deepen, so that products are more perfect and rigorous professional and sophisticated products through the authoritative testing center verification,so that every user friend rest assured !

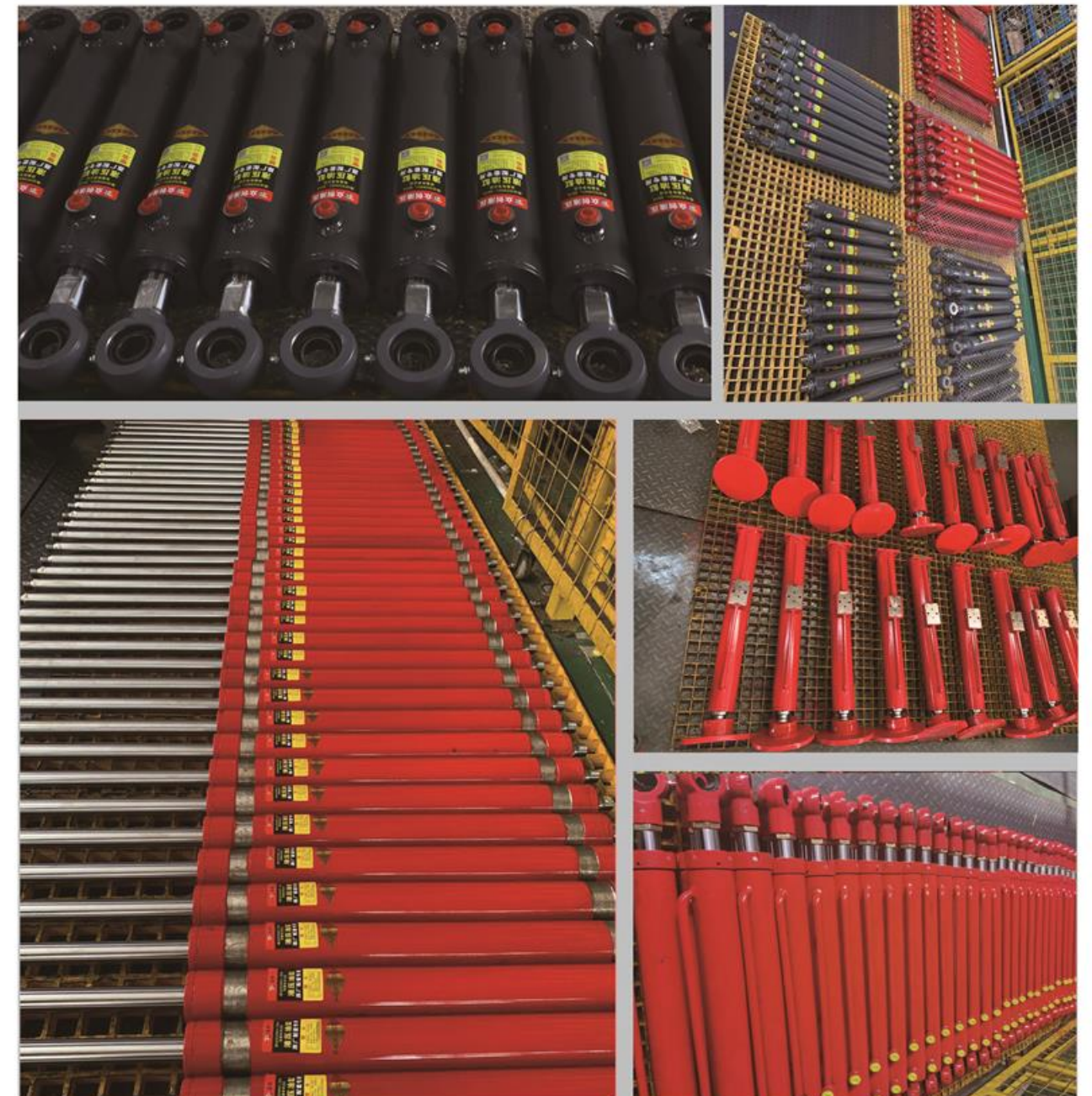



ZHONGCHUANG HYDRAULICS

CORE ADVANTAGES

With the established policy of integrating various information technologies and resources in an orderly and step-by-step manner, ZhongchuangHydraulic Technology Co., Ltd. provides hydraulic cylinder quality competitiveness by relying on advanced production and processing equipment !

Zhongchuang Hydraulic Oil Pressure Testing Bench



Ten thousand times pressure maintaining top detection platform



Fine tuned control



Cyclic salt spray test



Hardness testing of piston rod

Inspection of piston rod coating

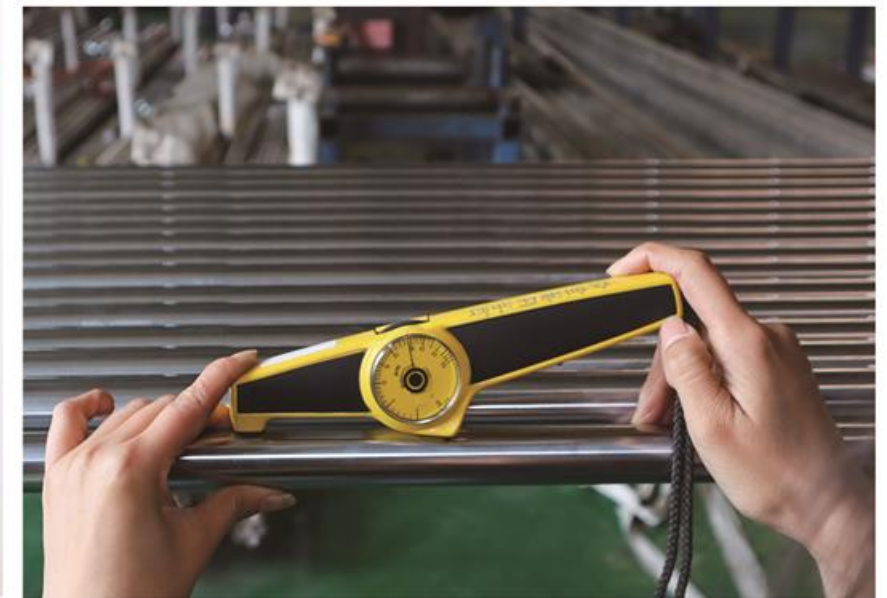

Service hotline: : 0319-5661666



ZHONGCHUANG HYDRAULICS



CNC machining center/CNC lathe

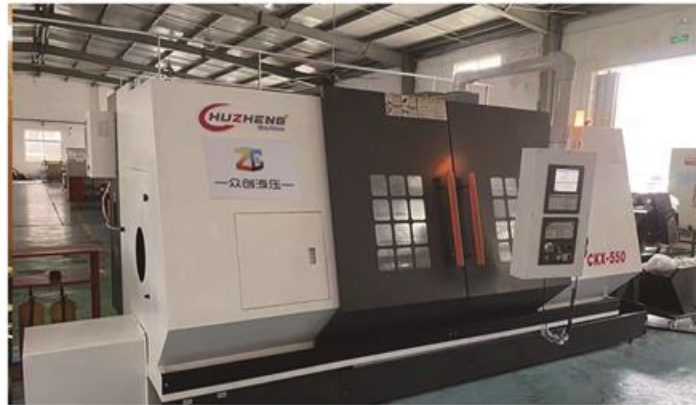

Ultra long deep hole hydraulic cylinder honing roller press

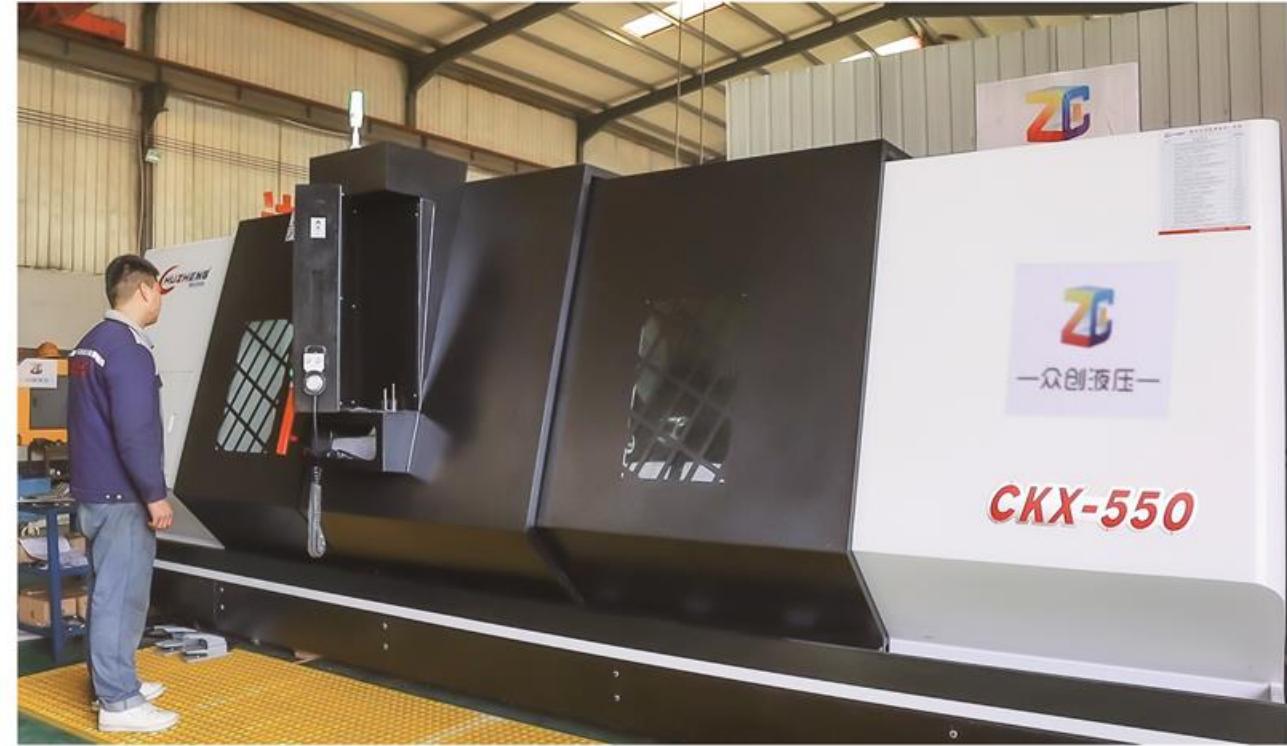

Precision machinery ensures quality

INGENUITY INNOVATE

Zhong chuang Hydraulic has high standards and strict requirements for the production and processing indicators and processes of hydraulic cylinders.

We customize durable and economical hydraulic cylinders for every customer, with high precision and efficiency. We are a high-quality hydraulic cylinder manufacturer that you can trust !

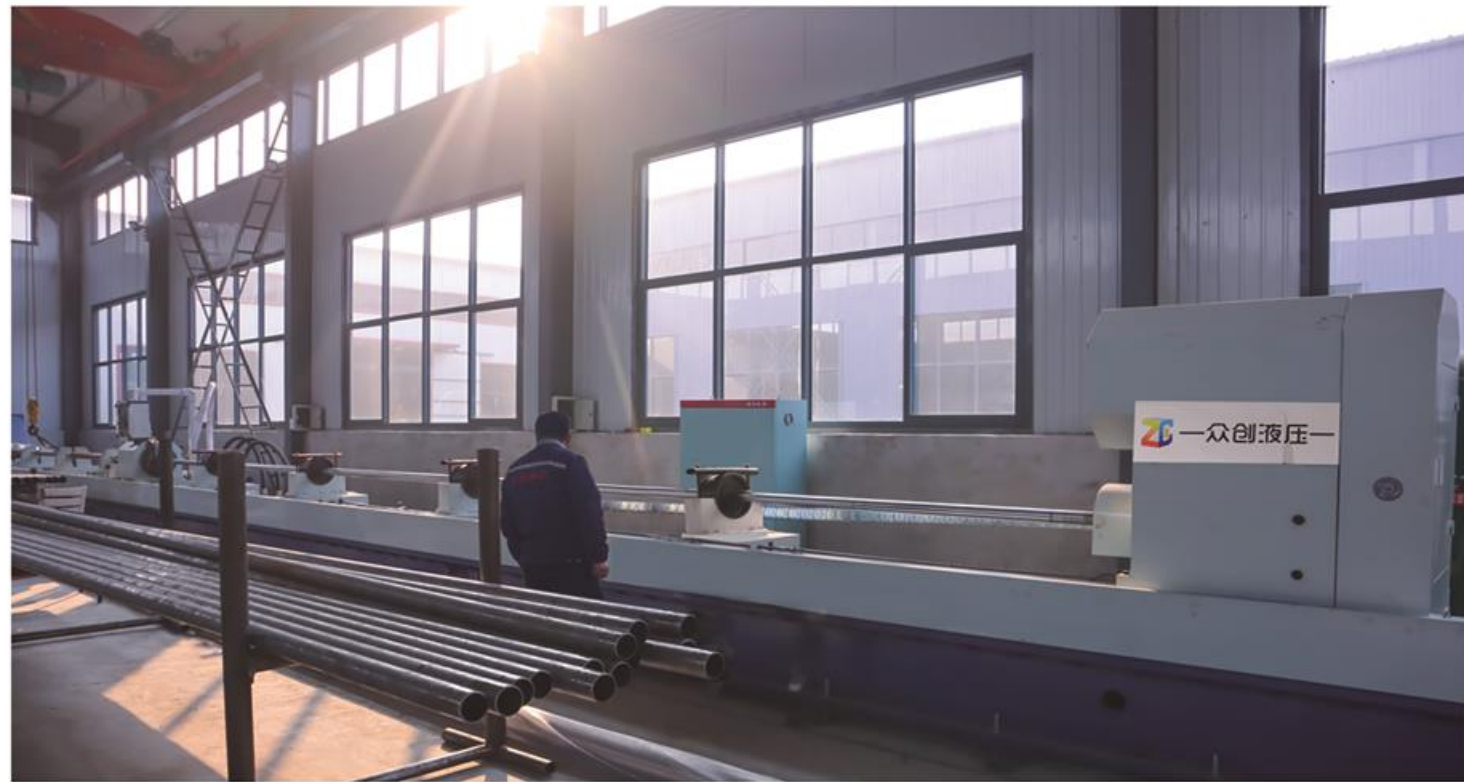

Fully automatic spraying line

Service hotline: 0319-5661666



CORPORATE CULTURE

- [Corporate spirit]: Loyalty, strictness, and continuous learning.
- [Corporate slogan]: Professional, quality wins the market.
- [Corporate purpose]: to provide users with products and services.
- [Business Policy]: new technology ,quality high efficiency and fast ,perfect service
- [Enterprise goals]: Create a perfect image of customers and enterprises, and enhance the brand effect of their own enterprises.
- [Corporate ideology]: There is nothing that can it be done today. do tomorrow is things today and think today.
- [Service Purpose]: open up the market with quality, develop and grow with sincerity.



Service hotline: : **0319-5661666**



All-around service and win-win cooperation .

Precise positioning, make every effort to do a good job of quality brand strategy, and enhance brand quality influence with different entry points



CORPORATE STYLE 展会风采

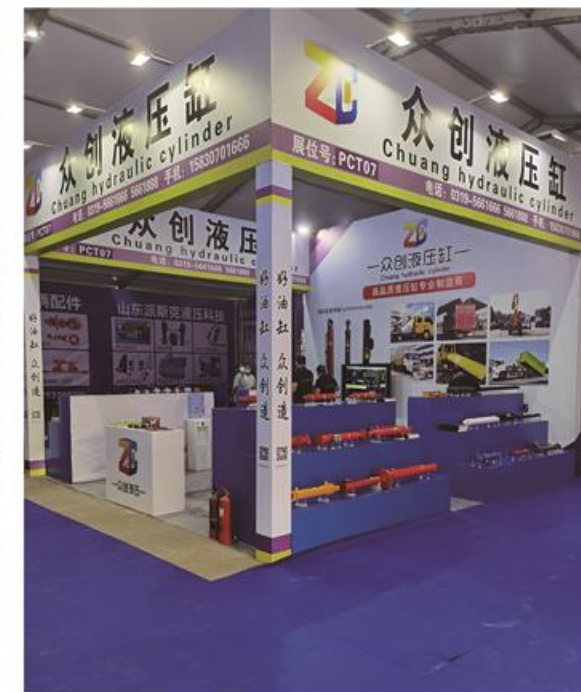
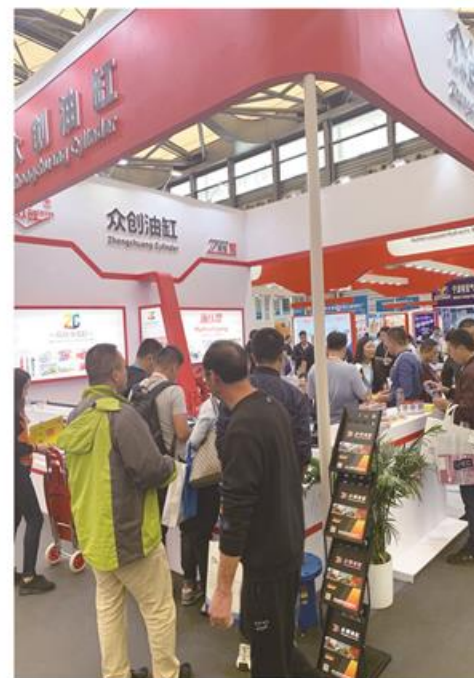
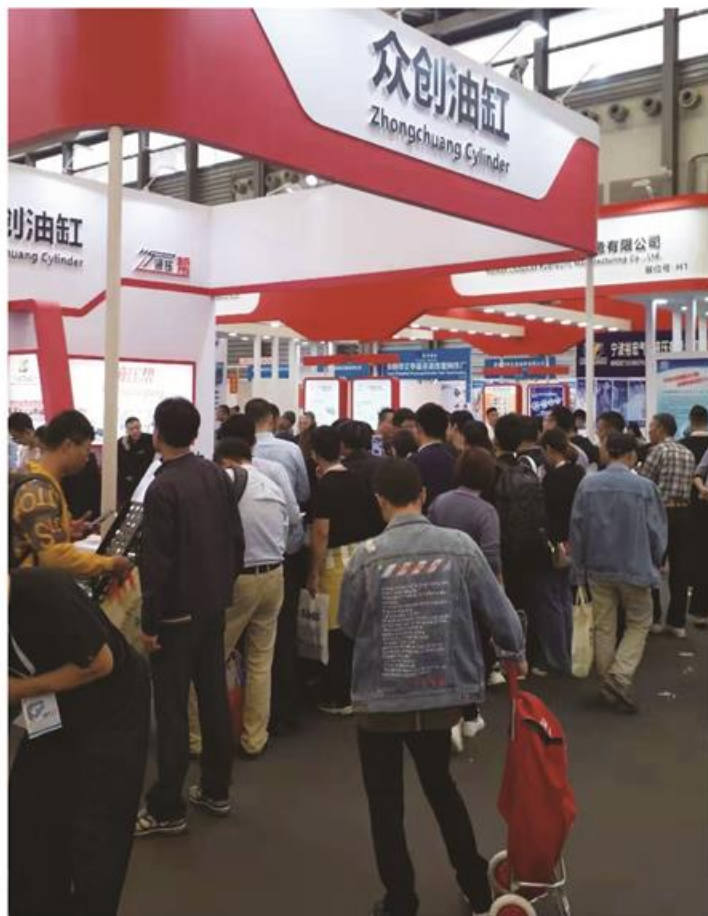

All-around service and win-win cooperation .

Precise positioning, make every effort to do a good job of quality brand strategy, and enhance brand quality influence with different entry points



The Car model is equipped with hydraulic cylinder



high-quality Excelsior DO A GOOD JOB OF OIL CYLINDER

Starting from the details Hebei Zhongchuang Hydraulic Machinery Co., Ltd.



The sanitation vehicle is equipped with Hydraulic cylinder



high-quality Excelsior DO A GOOD JOB OF OIL CYLINDER

Starting from the details Hebei Zhongchuang Hydraulic Machinery Co., Ltd.





Supporting oil cylinder for the exhibition wing model

high-quality Excelsior DO A GOOD JOB OF OIL CYLINDER

Starting from the details Hebei Zhongchuang Hydraulic Machinery Co., Ltd.



high-quality Excelsior DO A GOOD JOB OF OIL CYLINDER

Starting from the details Hebei Zhongchuang Hydraulic Machinery Co., Ltd.



Oil cylinder for fog cannon



high-quality Excelsior DO A GOOD JOB OF OIL CYLINDER

Starting from the details Hebei Zhongchuang Hydraulic Machinery Co., Ltd.



The wrecker is equipped with a hydraulic cylinder



high-quality Excelsior DO A GOOD JOB OF OIL CYLINDER

Starting from the details Hebei Zhongchuang Hydraulic Machinery Co., Ltd.





ZHONGCHUANG HYDRAULICS

Professional production of high-quality oil cylinders

TEL:0319-5661666

Supporting hydraulic cylinders for the Fangyan vehicle model



high-quality Excelsior DO A GOOD JOB OF OIL CYLINDER

Starting from the details Hebei Zhongchuang Hydraulic Machinery Co., Ltd.



ZHONGCHUANG HYDRAULICS

Website: www.zy-hydrauliccylinder.com

E-mail: sales1@zy-hydrauliccylinder.com



Hydraulic tailboard models equipped with hydraulic cylinders



high-quality Excelsior DO A GOOD JOB OF OIL CYLINDER

Starting from the details Hebei Zhongchuang Hydraulic Machinery Co., Ltd.





Crane models equipped with hydraulic cylinders



high-quality Excelsior DO A GOOD JOB OF OIL CYLINDER

Starting from the details Hebei Zhongchuang Hydraulic Machinery Co., Ltd.



Cover type matching hydraulic cylinder for dump truck

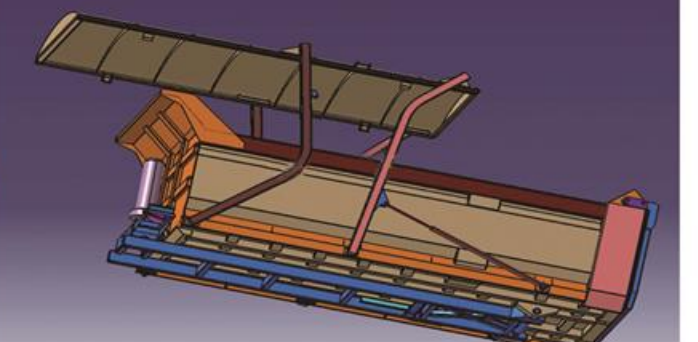

high-quality Excelsior DO A GOOD JOB OF OIL CYLINDER

Starting from the details Hebei Zhongchuang Hydraulic Machinery Co., Ltd.



Supporting hydraulic cylinders
for construction machinery



high-quality Excelsior **DO A GOOD JOB OF OIL CYLINDER**

Starting from the details Hebei Zhongchuang Hydraulic Machinery Co., Ltd.



Mini-excavator is equipped
with hydraulic cylinder



high-quality Excelsior **DO A GOOD JOB OF OIL CYLINDER**

Starting from the details Hebei Zhongchuang Hydraulic Machinery Co., Ltd.



Cylinder for lifting machine



high-quality Excelsior DO A GOOD JOB OF OIL CYLINDER

Starting from the details Hebei Zhongchuang Hydraulic Machinery Co., Ltd.



The drilling rig is equipped with a hydraulic cylinder



high-quality Excelsior DO A GOOD JOB OF OIL CYLINDER

Starting from the details Hebei Zhongchuang Hydraulic Machinery Co., Ltd.



Factory equipment matching hydraulic cylinder



high-quality Excelsior **DO A GOOD JOB OF OIL CYLINDER**

Starting from the details Hebei Zhongchuang Hydraulic Machinery Co., Ltd.



Forklift models are equipped with hydraulic cylinders



high-quality Excelsior **DO A GOOD JOB OF OIL CYLINDER**

Starting from the details Hebei Zhongchuang Hydraulic Machinery Co., Ltd.



Agricultural machinery type matching hydraulic cylinder



high-quality Excelsior **DO A GOOD JOB OF OIL CYLINDER**

Starting from the details Hebei Zhongchuang Hydraulic Machinery Co., Ltd.



Agricultural machinery
type matching hydraulic cylinder



high-quality Excelsior **DO A GOOD JOB OF OIL CYLINDER**

Starting from the details Hebei Zhongchuang Hydraulic Machinery Co., Ltd.



Equipped hydraulic cylinders
for road sweeping models



high-quality Excelsior **DO A GOOD JOB OF OIL CYLINDER**

Starting from the details Hebei Zhongchuang Hydraulic Machinery Co., Ltd.



Hydraulic cylinder for snow removal vehicle models



high-quality Excelsior **DO A GOOD JOB OF OIL CYLINDER**

Starting from the details Hebei Zhongchuang Hydraulic Machinery Co., Ltd.



Electric hydraulic lifting vehicle equipped with hydraulic cylinders



high-quality Excelsior DO A GOOD JOB OF OIL CYLINDER

Starting from the details Hebei Zhongchuang Hydraulic Machinery Co., Ltd.



Environmental sanitation equipment type matching hydraulic cylinder



high-quality Excelsior DO A GOOD JOB OF OIL CYLINDER

Starting from the details Hebei Zhongchuang Hydraulic Machinery Co., Ltd.



MOB mechanical equipment type matching hydraulic cylinder



high-quality Excelsior DO A GOOD JOB OF OIL CYLINDER

Starting from the details Hebei Zhongchuang Hydraulic Machinery Co., Ltd.



The company can customize irregular hydraulic cylinders according to customer needs
Processing range: stroke 5cm~10m, cylinder diameter 40mm~380mm



MOB mechanical equipment type matching hydraulic cylinder



high-quality Excelsior DO A GOOD JOB OF OIL CYLINDER

Starting from the details Hebei Zhongchuang Hydraulic Machinery Co., Ltd.

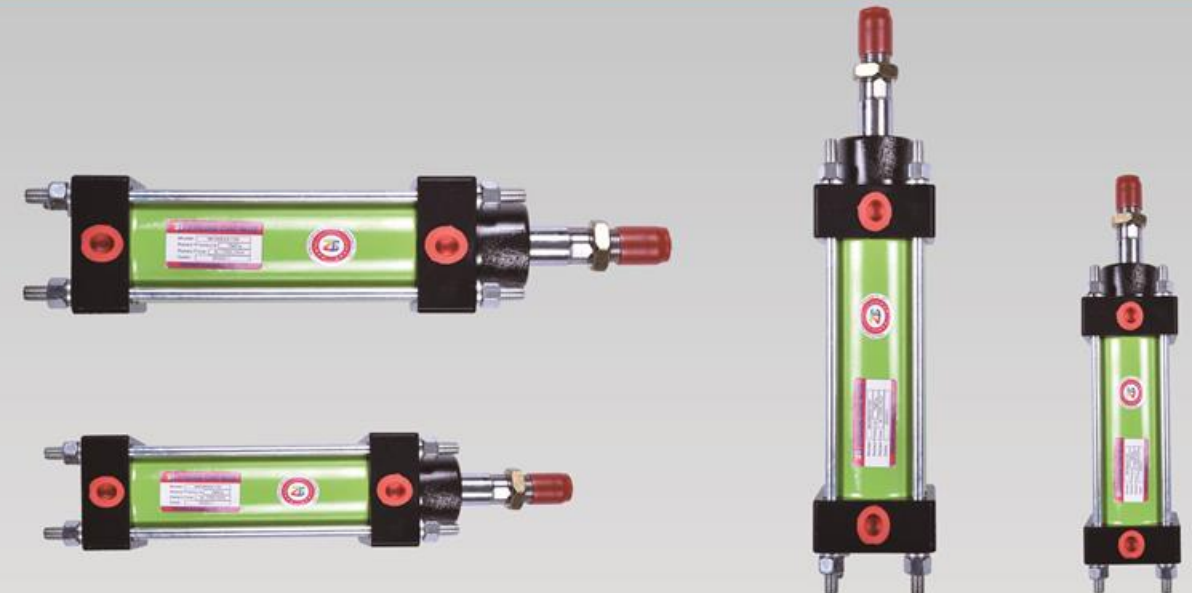

The company can customize irregular hydraulic cylinders according to customer needs
Processing range: stroke 5cm~10m, cylinder diameter 40mm~380mm



ZHONGCHUANG HYDRAULICS

Professional production of high-quality oil cylinders

TEL:0319-5661666

Other models are equipped with hydraulic cylinders



High-altitude tile-laying machine



Bridge maintenance vehicle



Guardrail cleaning vehicle

high-quality Excelsior DO A GOOD JOB OF OIL CYLINDER

Starting from the details Hebei Zhongchuang Hydraulic Machinery Co., Ltd.



ZHONGCHUANG HYDRAULICS

Website: www.zy-hydrauliccylinder.com

E-mail: sales1@zy-hydrauliccylinder.com



Supporting hydraulic cylinders for cloud ladder models



high-quality Excelsior DO A GOOD JOB OF OIL CYLINDER

Starting from the details Hebei Zhongchuang Hydraulic Machinery Co., Ltd.



APPLICATION FIELD OF HYDRAULIC PRODUCTS

- CONSTRUCTION MACHINERY
- LIFTING MACHINERY
- METALLURGICAL HEAVY INDUSTRY
- MARITIME VESSELS
- WATER CONSERVANCY AND HYDROPOWER
- LIGHT INDUSTRY MACHINERY
- MUNICIPAL ENGINEERING
- SPECIAL PURPOSE VEHICLES
- AEROSPACE
- MEDICAL DEVICES
- AGRICULTURAL MACHINERY
- MINING MACHINERY
- INDUSTRIAL MACHINERY



ZHONGCHUANG HYDRAULIC CYLINDER CUSTOMIZED PROGRAM AND PROCESSING RANGE

CUSTOMIZED PROGRAM FOR HYDRAULIC CYLINDERS

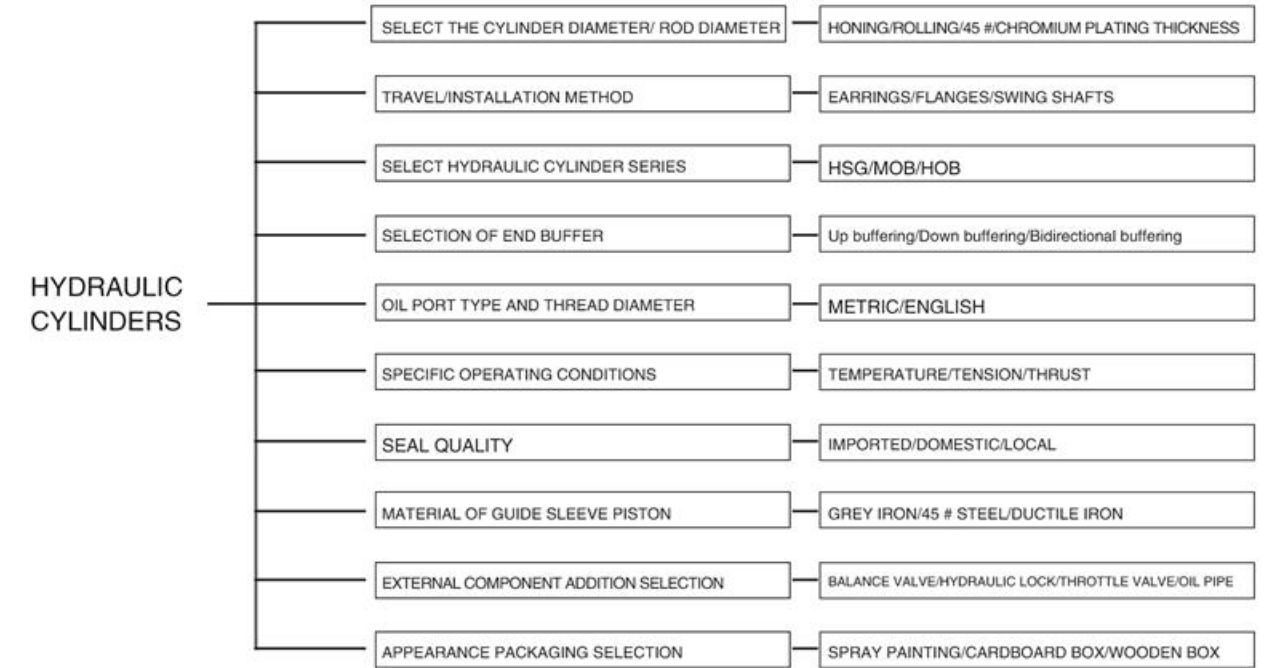

CUSTOMIZED PROCESSING SCOPE

stroke 5cm—10m

Cylinder diameter 40mm—380mm

CONSULTATION ON CUSTOMIZED TECHNOLOGY FOR IRREGULAR SHAPES



Amy: +86 13032642700



Lucy: +86 15232126215



Helen: +86 15232123715



BMR hydraulic motor

Technical Parameter:

排量 (ml/r)		50	63	80	100	125	160	200	250	315	400	500
流量 (LPM)	Cont	40	40	60	60	60	60	60	60	60	60	60
	Int	50	50	75	75	75	75	75	75	75	75	75
转速 (RPM)	Cont	755	630	750	600	475	375	300	240	190	160	110
	Int	970	790	940	750	600	470	375	300	240	200	128
压力 (MPA)	Cont	14	14	17.5	17.5	17.5	16.5	13	11	8.5	8.5	8
	Int	17.5	17.5	20	20	20	20	17.5	14	11.5	11.5	9
扭矩 (N*M)	Cont	100	124	190	240	292	363	358	352	360	420	464
	Int	126	156	220	280	340	430	448	470	470	548	580

Characteristic features:

- . It adapt the gerolor design. low pressure, high efficiency good performance.
- . Credible design for shaft seal ,which can bear high pressure and be used in parallel or in series.
- . Direction of shaft rotation and speed can be controlled easily and smoothly.
- . Linkage shaft specially designed,so it is the long life motor.
- . Best combination of efficacy and economy in medium load applications.
- . Structure is compact, easy installation.



BM3 hydraulic motor

Technical Parameter:

排量 (ml/r)		100	160	200	250	315	400
流量 (LPM)	Cont	58	58	58	58	58	58
	Int	68	68	68	68	68	68
转速 (RPM)	Cont	551	344	276	220	175	140
	Int	646	404	323	258	205	162
压力 (MPA)	Cont	14	14	12.5	11	9	9
	Int	17	17	15	13	11	10
扭矩 (N*M)	Cont	178	285	318	350	360	418
	Int	216	346	382	413	425	464

Characteristic features:

Bm3 motor is a spool valve with double ball-bearing type motor.

Characteristic features:

- . Supported by double ball-bearing, the shaft can carry bigger radial force.
- . Adopt gerolor design , low pressure high efficiency good performance.
- . Credible design for shaft seal , which can bear high pressure and be used in parallel or in series.
- . Direction of shaft rotation and speed can be controlled easily and smoothly.
- . Linkage shaft specially designed , soit is the long life motor.
- . Structure is compact, easy installation.



BM5 hydraulic motor

Technical Parameter:

排量 (ml/r)		80	100	125	160	200	250	280	305	400	500
流量 (LPM)	Cont	75	75	75	75	75	75	75	75	75	75
	Int	75	95	95	115	115	115	115	115	115	115
转速 (RPM)	Cont	799	742	576	460	365	294	270	246	183	148
	Int	908	924	720	713	577	462	420	365	287	230
压力 (MPA)	Cont	21	21	21	21	21	20	20	20	16	12
	Int	30	30	30	26	26	26	24	24	17	14
	Cont	30	30	30	30	30	30	30	30	20	17
扭矩 (N*M)	Int	235	295	385	460	550	650	720	750	800	830
	Cont	320	380	540	570	660	820	888	870	920	940
	Int	320	380	540	635	765	957	962	1000	1020	1057

Characteristic features:

Bm5 motor is a disc valve type gerolor motr.

- .Advanced design in disc distribution flow , which can provide imoroved performance at low speed.
- .The valve can automatically compensate for the wear ,so the volmetric efficiency is high.
- .Double taper roller bearings permit high radial loads,The motors can be used on heavier vehicles in traction drive applications.



Hydraulic synchronous diversion motor

Technical Parameter:

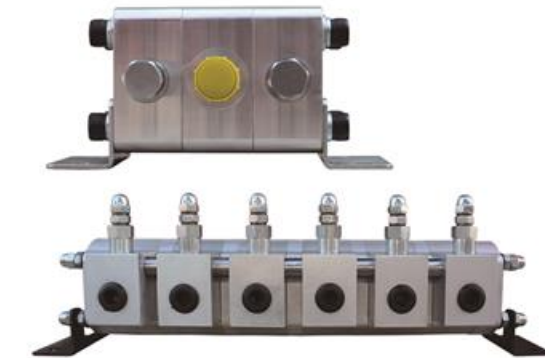

Characteristic features:

Hydraulic synchronous diversion motor, focusing on solving the operational accuracy of synchronous execution components such as oil cylinders or motors in hydraulic systems.

- .Enable multiple hydraulic cylinders to achieve the same lifting and lowering function, enabling various hydraulic platforms to operate synchronously, simultaneously, and smoothly.
- .The synchronization accuracy is as high as 99%.
- .It has the advantages of evenly distributed hydraulic oil circuit, easy installation, precise performance, no unbalanced load, multi cylinder synchronization, good integration performance, insensitivity to oil viscosity, and strong anti fouling ability.

BZZ1/2/3 hydraulic steering gear

BZZ series hydraulic steering gear size diagram

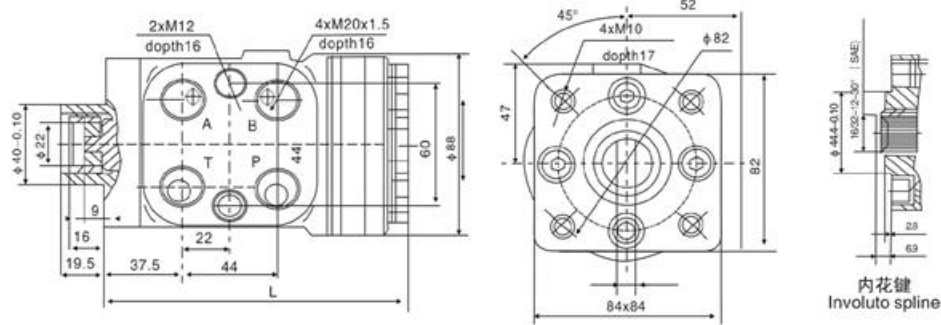

Characteristic features:

- .Eliminating mechanical linkage devices can reduce the cost of the host and provide a reliable and lightweight structure.
- .Flexible and effortless operation.
- .Emergency manual steering can be achieved when the engine is turned off.
- .Continuous and stepless control rotation can be achieved with very small torque.
- .Provide a wide range of options for control circuits and host sizes.
- .Can be connected to various oil pumps and hydraulic supply systems.

BZZ5 hydraulic steering gear

BZZ5 series hydraulic steering gear size diagram

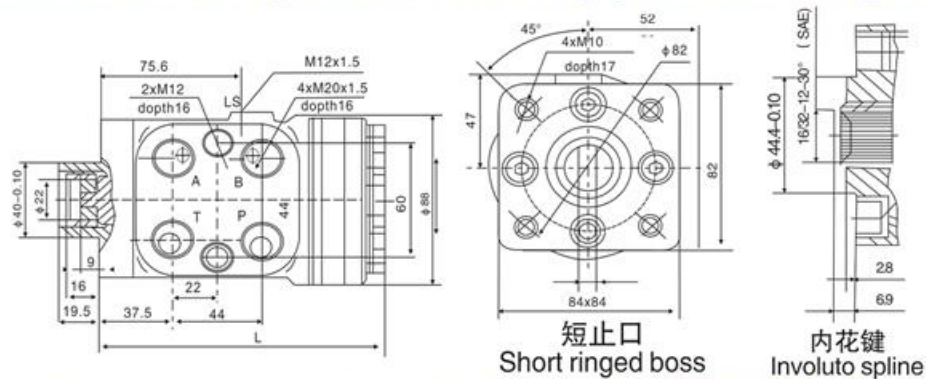

In addition to the advantages mentioned above, the BZZ5 hydraulic steering gear also has the following features:

- .Regardless of the load pressure or the speed of the steering wheel, the corresponding flow rate can be prioritized according to the requirements of the steering oil circuit to ensure reliable, sensitive, and lightweight steering.
- .The flow output of the oil pump, in addition to supplying the required flow to the steering system, can be used by the auxiliary oil circuit to eliminate power loss caused by excessive oil supply to the steering oil circuit and improve system efficiency.



BMM Micro High Speed Hydraulic Motor

Technical Parameter:



排量 Swept volume (min/r)		8	12.5	20	32	40	50
流量 (LPM)	cont	14	18	18	18	20	20
	int	20	25	25	25	52	25
转速 (RPM)	cont	1537	1256	814	513	452	360
	int	2450	1940	1250	800	630	500
压力 (MPa)	cont	10	10	10	10	9	7
	int	14	14	14	14	14	14
扭矩 (N·m)	cont	11	16	25	40	45	46
	int	15	23	35	57	70	88

Characteristic features:

- The BMM series cycloidal hydraulic motor is a miniature shaft distribution motor that adopts a column type fixed rotor pair and a 4/5 tooth structure. It has a compact structure, light weight, high power density, and can be used in a very small installation space
- .Optimized design of embedded column fixed rotor pairs, high efficiency and long service life.
- .Adopting high-pressure skeleton oil seal, with high pressure bearing capacity, it can be used in series and parallel.
- .Exquisite structural design and high power density.
- .The motor is equipped with a flushing function inside, which provides good heat dissipation.

LKF-Pressure Compensating Flow Control Valve



型号 Model	油口尺寸 Oil port	流量 Flow (gpm)	公称压力 (bar) Standard pressure
LKF-60	1/2-NPT	0-60L/min (0-16gpm)	210
LKF-110	3/4-NPT	0-110L/min (0-30gpm)	

Characteristic features:

- LKF is a full range pressure compensated variable flow control valve. After careful design, its throttle area will change with the rotation of the valve stem. No matter how the pressure of CF and EX ports changes, the flow rate of the control port remains stable and constant. It has an adjustable spring safety valve that allows the pressure to rise to the set safe pressure. The factory set pressure of the safety valve is 1500psi, with an adjustable range of 750-3000psi.



P40 Series Monoblock Direcontrol Control Valves

型号说明 / MODEL CODE



Nom. Pressure (MPa)	Max. Pressure (MPa)	Nom. Flow rate (L/min)	Max. Flow rate (L/min)	Back Pressure (MPa)	Hydraulic oil		
					Tem. rang (°C)	Visc. rang (mm ² /S)	Filtrating accuracy (µm)
20	31.5	40	40	≤1	-20~+80	10~400	≤10

Applications features:

- .P40 series valves with middle-high pressure monoblock construction is developed based on Europe technology.
- .Inner check valve: The check valve inside the valve body is to insure the hydraulic oil not to be returned.
- .Inner relief valve: The relief valve inside the valve body is able to adjust the hydraulic system working pressure.
- .Oil way: Parallel circuit, power beyond option
- .Control Way: Manual control, pneumatic control, hydraulic and electric control for optional.
- .Valve construction: monoblock construction, 1-7 levers.
- .Spool Function: O, Y, P, A.
- .Option: Hydraulic lock is available to be added on A and B port.
- .Available with manual, pneumatic control, electric and pneumatic control, hydraulic and electric control and etc.



P80 Series Monoblock Direcontrol Control Valves

型号说明 / MODEL CODE



Nom. Pressure (MPa)	Max. Pressure (MPa)	Nom. Flow rate (L/min)	Max. Flow rate (L/min)	Back Pressure (MPa)	Hydraulic oil		
					Tem. rang (°C)	Visc. rang (mm ² /S)	Filtrating accuracy (µm)
20	31.5	80	80	≤1	-20~+80	10~400	≤10

P80 series valves with middle-high pressure monoblock construction is developed based on Europe technology.

- .Inner check valve: The check valve inside the valve body is to insure the hydraulic oil not to be returned.
- .Inner relief valve: The relief valve inside the valve body is able to adjust the hydraulic system working pressure.
- .Oil way: Parallel circuit, power beyond option.
- .Control Way: Manual control, pneumatic control, hydraulic and electric control for optional.
- .Valve construction: monoblock construction, 1-6 levers.
- .Spool Function: O, Y, P, A.
- .Option: Hydraulic lock is available to be added on A and B port.
- .Available manual, pneumatic control, electric and pneumatic control, hydraulic and electric control and etc.



ZDa-L15 Series Pneumatic Hydraulic Directional Control Valves

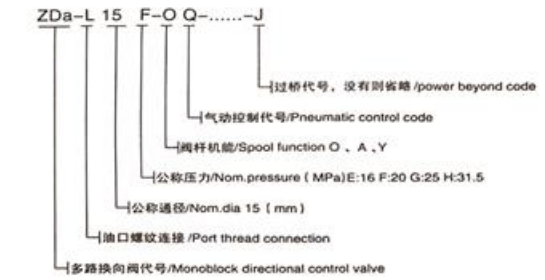

性能参数 / SPECIFICATIONS

公称压力 (MPa) Nom. Pressure	最大压力 (MPa) Max. Pressure	公称流量 (L/min) Nom. Flow rate	最大流量 (L/min) Max. Flow rate	中位背压 (MPa) Back Pressure	工作油液 hydraulic oil		
					温度范围 (°C) Tem. rang	粘度范围 (mm ² /S) Visc. rang	过滤精度 (µm) filtrating accuracy
20	31.5	50	60	≤1	-20~+80	10~400	≤10

Product Features:

- .Inner check valve: The check valve inside the valve body to insure the hydraulic oil not to be returned.
- .Inner relief valve: The relief valve inside the valve body is able to adjust the hydraulic system working pressure.
- .Oil way: Parallel circuit, with power beyond.
- .Control Way: pneumatic control, manual control.
- .Valve construction: monoblock construction, 1-7 levers are available to assembled as you requests.
- .Spool Function: O, A, Y etc.

Electromagnetic valve



- The main features of hydraulic solenoid valves include:
1. External leakage is blocked, internal leakage is easy to control, and safe to use.
 2. The system is simple, easy to maintain, and cost-effective.
 3. Fast action, low power, lightweight appearance.
 4. High control accuracy, flexible and reliable.
 5. More energy-efficient and environmentally friendly than mechanical control.

Characteristic features:

Hydraulic solenoid valve is an industrial equipment controlled by electromagnetism. It is an automatic basic element used to control fluid. It belongs to actuator and is used to adjust the direction, flow, speed and other parameters of hydraulic oil in the industrial control system. Electromagnetic valves can be used in conjunction with different circuits to achieve the desired control, while ensuring the accuracy and flexibility of the control. There are many types of solenoid valves, and different solenoid valves play a role in different positions of the control system. The most commonly used ones are one-way valves, safety valves, directional control valves, speed regulating valves, etc.



ZCY series hydraulic gear oil pump

Technical Parameter:

型号Model	排量 (ml/r)	压力 (Mpa)		转速 (r/min)		容积效率 (≥%) ve	旋向
		Rated	Max.	Rated	Max.		
ZCY-32BHH	32	20	25	600	3000	93	L/R
ZCY-40BHH	40						L/R
ZCY-50BHH	50						L/R
ZCY-63BHH	63						L/R
							L/R

Characteristic features:

- .ZCY type high-pressure gear pump adopts high-strength castings, radial seals use tooth top sweeping, and axial seals use floating pressure balanced side plates, thus achieving high efficiency.
- .This pump has the characteristics of small volume, light weight, good performance, and reliable operation.
- Widely used in specialized vehicles such as truck mounted cranes, obstacle clearing vehicles, high-pressure oil pumps, light trucks, dump trucks, and dump trucks.



CB-F series hydraulic gear pump

型号 Model	公称排量 Nominal displacement (ml/r)	压力 (MPa) Pressure		转速 (r/min) Speed		容积效率 Volumetric efficiency(%)	进油口 Inlet	出油口 Outlet	重量 Weight (kg)
		额定 Rated	最高 Max	额定 Rated	最高 Max				
CB-F580	80	20	25	2000	2500	92	G11/4	G1	6.7
CB-F563	63	20	25	2000	2500	92	G11/4	G1	6.2
CB-F550	50	20	25	2000	2500	92	G11/4	G1	5.8
CB-F540	40	20	25	2000	2500	92	G11/4	G1	5.3
CB-F532	32	20	25	2000	2500	92	G11/4	G1	4.9
CB-F525	25	20	25	2000	2500	92	G11/4	G1	4.5

CB-F Gear Pump Product Features:

- .High strength cast aluminum material with strong bearing capacity.
- .Patent technology, structural design, self-lubricating bearing application, working pressure of oil pump, Keep high volumetric efficiency;
- .The patented technology is adopted, and the service life of the side plate is extended.
- .Special structure design, lightweight, with the ability of resisting radial force and axial force.



HGP1A/2A/3A series gear pump



Technical Parameter:

Model	flow rate	psi		RPM			kg		
		Rp	Top	Rate	Max.	Min			
HGP-1A-F1	1	210 (3000)	250 (3500)	4500	1000	1			
HGP-1A-F2	2				600	1.05			
HGP-1A-F3	3				600	1.15			
HGP-1A-F4	4				600	1.18			
HGP-1A-F5	5				600	1.2			
HGP-1A-F6	6				600	1.3			
HGP-1A-F8	7.8			600	1.3				
HGP-2A-F2	2			175 (2500)	210 (3000)	1800	5000	900	1.63
HGP-2A-F3	3						5000	850	1.65
HGP-2A-F4	4						4500	800	1.67
HGP-2A-F6	6						3500	700	1.69
HGP-2A-F8	7.5						3000	600	1.72
HGP-2A-F9	9	2500	550				1.75		
HGP-2A-F11	10.5	2000	500			1.77			
HGP-2A-F12	12	2000	500			1.8			
HGP-3A-F6	6	210 (3000)	250 (3500)			3000	700	2.25	
HGP-3A-F8	8						600	2.4	
HGP-3A-F11	11						600	2.55	
HGP-3A-F13	13						600	2.7	
HGP-3A-F14	14.3			600	2.85				
HGP-3A-F17	16.5			600	3.05				
HGP-3A-F19	19.2			400	3.2				
HGP-3A-F23	23				3.35				
HGP-3A-F25	25				3.5				
HGP-3A-F28	28				3.6				
HGP-3A-F30	30				3.7				
					140 (2000)	175 (2500)			

Characteristic features:

- HGP-1A, HGP-2A, HGP-3A series single gear pumps. The pump body is made of high-strength aluminum alloy shell, with high-precision design and light weight. It is driven by alloy steel hard face gear for smooth transmission.



CBK series gear oil pump

型号Model	排量 (ml/r) Displacement	压力 (Mpa) Pressure		转速 (r/min) Speed		容积效率 (≥%) VE	L	重量 (kg) Weight
		额定 Rated	最高 Max.	额定 Rated	最高 Max.			
CBK-F0.8	0.8	21	25	2000	2500	≥90	82	0.55
CBK-F1.0	1						84.5	0.65
CBK-F1.3	1.3						85	0.67
CBK-F1.6	1.6						86.5	0.7
CBK-F2.1	2.1						88	0.73
CBK-F2.5	2.5						89.5	0.76
CBK-F3.2	3.2						91.5	0.8
CBK-F3.7	3.7						93.5	0.9
CBK-F4.2	4.2						95.5	1
CBK-F5.8	5.8						97	1.1
CBK-F6.0	6						103	1.2
CBK-F8.0	8						110	1.5

Characteristics of CBK gear pump:

1. Adopt high-strength aluminum alloy shell material.
2. The import and export of oil can be selected from methods such as rear inlet and front outlet, side inlet and side outlet, and rear inlet and rear outlet.
3. Axial clearance automatic compensation mechanism enables the oil pump to maintain high volumetric efficiency for a long time.
4. DU self-lubricating and other advanced technologies have the characteristics of high volumetric efficiency, high pressure, low noise, strong vibration resistance, and long service life.
5. Widely used in micro power unit hydraulic systems.