



# WOSERLD

HYDRAULIC ROCK DRILL

## 沃思德液压凿岩机



**江西沃思德凿岩液压有限公司**  
JIANGXI WOSERLD ROCK DRILLING HYDRAULIC CO.,LTD.

地址:江西省萍乡市经济技术开发区彭高镇上栗工业园  
电话:0799-3671000 手机:19907991000 热线电话:400-097-6818  
网址:www.woserld.com 邮箱:sales@woserld.com \* 2024年7月 印刷



关注微信公众号、抖音号了解更多详情

Address:Shangli Industrial Park, Penggao Town, Pingxiang City, Jiangxi Province.  
Telephone:0799-3671000 Mobile:19907991000 Hotline: 400-097-6818  
Web site:www.woserld.com Mailboxes:sales@woserld.com \* Printed in July 2024



# WVOSSEERLD

## 目录

### TABLE OF CONTENTS

企业简介	Company Introduction	01
生产车间	Production workshop	03
资质证书	Qualification certificate	07
<hr/>		
凿岩机技术参数	Rock drill technical data	11
凿岩机应用案例	Rock drill project case	49
<hr/>		
售后服务	After-sale service	53
<hr/>		

# COMPANY PROFILE

## 企业简介

“WOSERLD”源自瑞典知名液压凿岩机及钻具品牌。2019年招商引资入驻萍乡市国家级经济开发区工业园，成立江西沃思德凿岩液压有限公司。在中国实现品牌及技术输入同时，仍不断向更高技术领域探索。工厂一期占地面积110亩，厂房面积38000平方米，办公楼面积4500平方，现有员工300余人，二期占地面积120亩，2024年投入使用。主要从德国、日本、台湾引进200余台套生产及检测设备，生产全球主流液压凿岩机，已经成为中国目前品种全、产能大的专业凿岩机及其耗件制造企业。沃思德既立足为国内主机配套，又全球供应，已批量销往四十余个国家和地区。目前已为全球五十余家主机企业配套，同时有一百余家合作分销商，为全球终端客户及时提供产品和服务。

“WOSERLD” originates from a well-known Swedish brand specializing in hydraulic rock drills and drilling tools. In 2019, it attracted investment and settled in the national economic development zone industrial park of Pingxiang City, establishing Jiangxi WOSERLD Hydraulic Rock Drilling Co., Ltd. While bringing the brand and technology into China, it continues to explore higher technical fields. The first phase of the factory covers an area of 110 acres, with a plant area of 38,000 square meters and an office building area of 4,500 square meters. It currently employs more than 300 people. The second phase will cover an area of 120 acres and will be put into use in 2024. The company has imported more than 200 sets of production and testing equipment from Germany, Japan, and Taiwan, producing globally mainstream hydraulic rock drills. It has become a professional manufacturer of rock drills and their consumables in China with the most complete variety and largest production capacity. WOSERLD not only focuses on supporting domestic host machines but also supplies globally. Its products are now sold in batches to more than 40 countries and regions. It currently supports more than 50 host machine enterprises worldwide and has more than 100 cooperating distributors, providing products and services to global end customers in a timely manner.

### 为全球客户及时提供产品和服务

Timely provision of products and services for global customers.

40+

国家地区  
Country/Region

50+

全球服务配套商  
Global service provider

100+

合作分销商  
Cooperative distributor

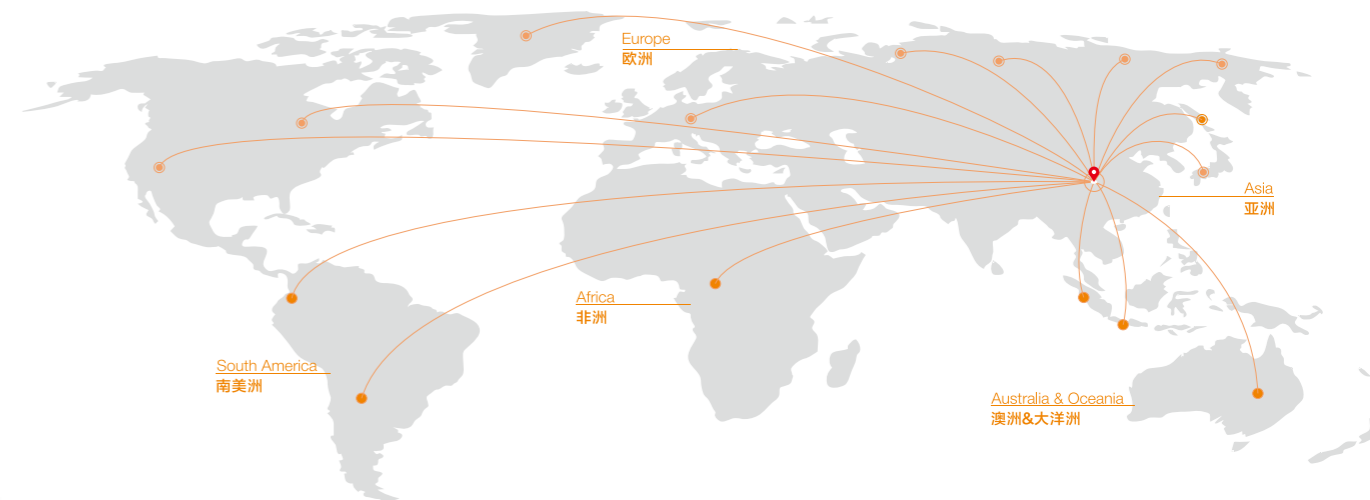

160000m<sup>2</sup>



# WORKSHOP SHOW

## 卓越品质之源 实力工厂铸就辉煌

公司以自主创新和引进吸收再创新相结合为主要手段，先后与北京科技大学、中南大学、中国矿业大学达成战略合作联盟。公司持续加大研发投入，保证研发投入支出占总销售收入的4%以上，投入1200万元用于技术成果产业化项目，开展凿岩机的缓冲系统技术、凿岩机冲击结构设计等各项研发工作，形成凿岩机全系列化产品体系，顺利实现年凿岩机设备总产量翻番。

The company combines independent innovation with the introduction, absorption, and re-innovation of advanced technologies. It has established strategic alliances with the University of Science and Technology Beijing, Central South University, and China University of Mining and Technology. The company continues to increase its R&D investment, ensuring that R&D expenditure accounts for more than 4% of total sales revenue. An investment of 12 million RMB has been allocated for the industrialization of technological achievements, focusing on various R&D projects such as rock drill buffer system technology and rock drill impact structure design. This effort has led to the development of a full range of rock drill products, successfully doubling the annual total production of rock drill equipment.



热处理车间 | Heat treatment workshop



热处理是机械制造中的重要工艺之一，公司拥有先进的热处理设备，由专业技术团队全程操作，保障产品的高质量。凿岩机冲击器零件的热处理在爱协林可控气氛多用炉生产线完成。该生产线能够实现多种热处理工艺的复合生产，如渗碳+油冷/气冷、碳氮共渗+油冷/气冷、表面无氧化调质及表面无氧化高温回火等工艺，各项参数控制准确、稳定。通过该生产线热处理的活塞杆，达到表面硬度高、耐磨损，芯部韧性高、耐冲击疲劳，使用寿命长的特点。

Heat treatment is one of the essential processes in mechanical manufacturing. The company has advanced heat treatment equipment operated by a professional technical team to ensure high product quality. The heat treatment of rock drill hammer parts is completed on an Ipsen controlled atmosphere multi-purpose furnace production line. This production line can achieve composite production of various heat treatment processes, such as carburizing + oil cooling/air cooling, carbonitriding + oil cooling/air cooling, surface oxidation-free quenching and tempering, and surface oxidation-free high-temperature tempering. The parameters are controlled accurately and stably. The piston rods treated by this production line feature high surface hardness, wear resistance, high core toughness, impact fatigue resistance, and long service life.



毛坯车间 | Blank Workshop



粗加工车间 | Rough Machining Workshop



检测中心 | Testing center

公司使用三坐标测量机、金相显微镜、杠杆式天平、硬度计、光洁度仪、高度仪、光谱仪等各类检测设备，严格检测各零部件。保证各个零部件的尺寸和精度与图纸一致，达到严格的出厂规格要求。

WOSERLD uses various types of inspection equipment such as coordinate measuring machines, metallographic microscopes, lever-type balances, hardness testers, surface roughness testers, height gauges, and spectrometers to rigorously inspect all components. This ensures that each component meets the specified dimensions, accuracy, and conforms to the drawings, achieving strict factory specifications.



精加工车间 | Finishing workshop



装配车间 | Rock drill assembling workshop



清洗区 | Cleaning workshop



超声波清洗 | Ultrasonic cleaning



# QUALIFICATION

## 荣誉资质证书



### 瑞典品牌证明 Swedish Brand Certification

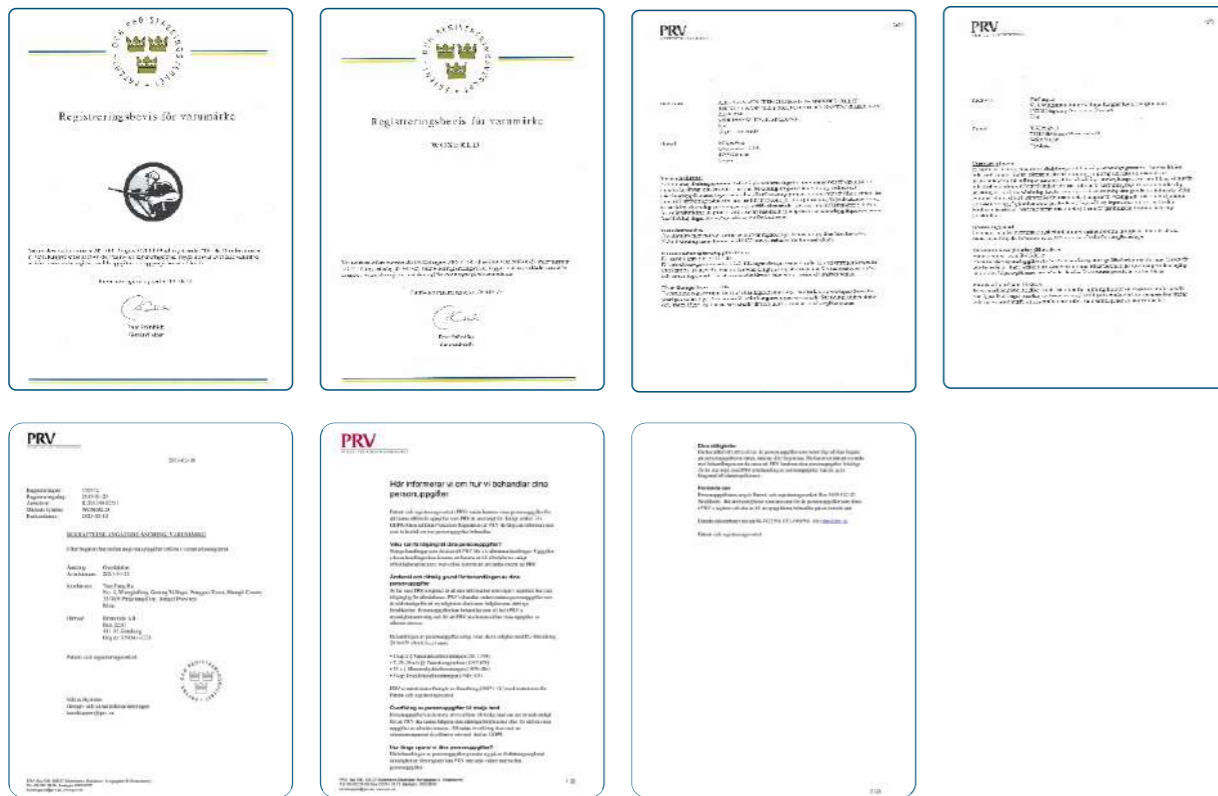

### 产品专利证明 Product Patent Certificate



# 沃思德液压凿岩机系列

液压凿岩机作为重要的工程设备之一，在矿山、公路、水电、铁路、建筑等领域的工程施工中不可或缺。它是一种用来直接开采石料的工具，通过在岩层上钻凿出炮眼，以便放入炸药炸开岩石，从而完成开采石料或其他石方工程。此外，凿岩机也可以改作破碎器，用来破碎混凝土等坚硬层。

Hydraulic rock drills are essential engineering equipment in fields such as mining, road construction, hydropower, railways, and building construction. They are used directly for quarrying stone by drilling blast holes into rock formations, allowing explosives to be inserted to break apart the rock, thereby facilitating tasks like stone extraction or other rock-related projects. Additionally, rock drills can be repurposed as demolition tools to break apart hard materials such as concrete.



# WOSERLD

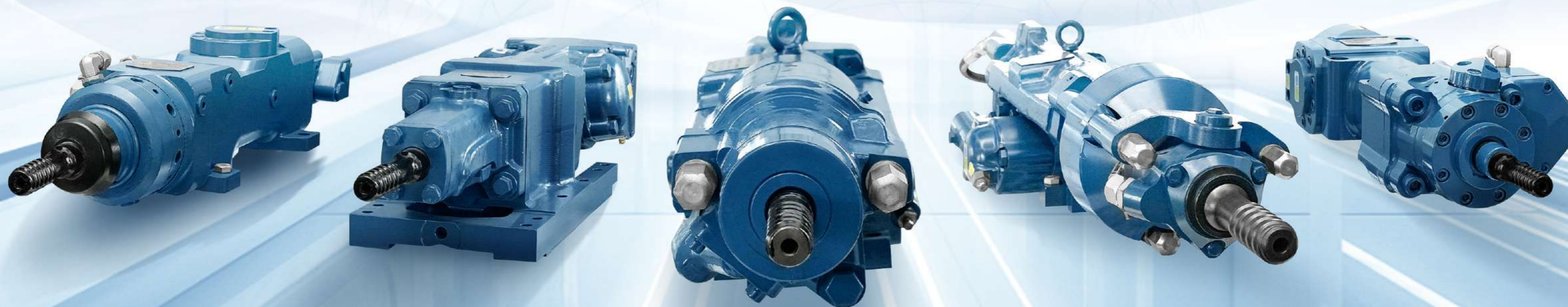

# A18D/L (YYG-18/1000) 液压凿岩机



## 设备视图

Overall dimension

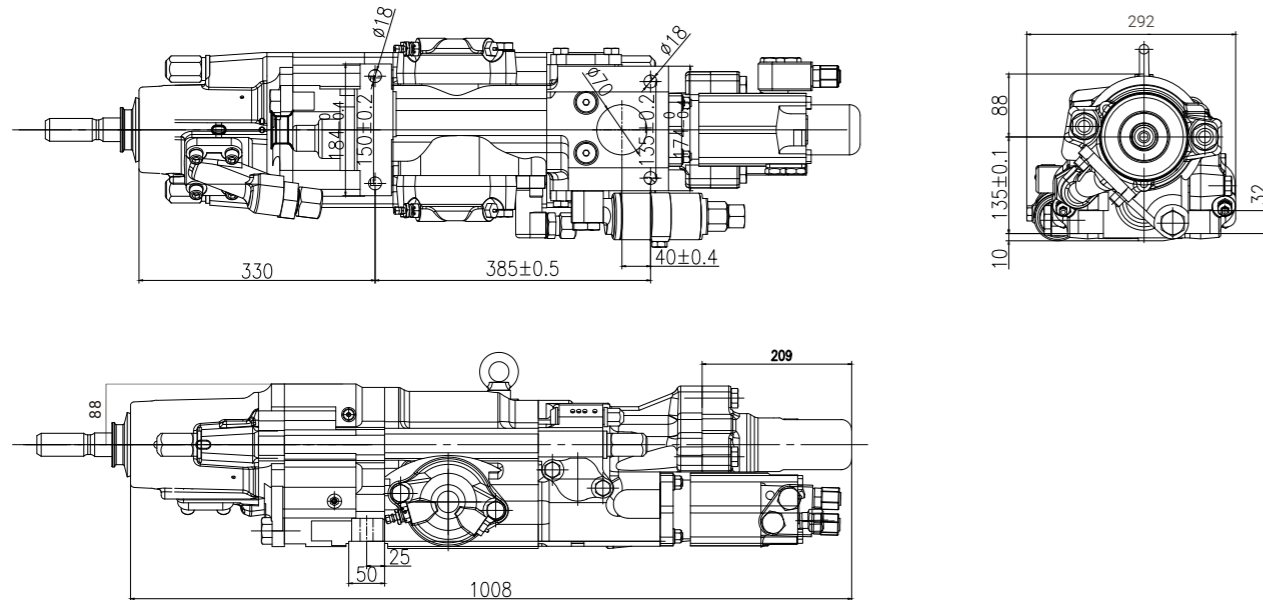

## A18D/L (YYG-18/1000) 液压凿岩机技术参数

A18D/L(YYG-18/1000) rock drill technical data

结构参数 Structure	外形尺寸 (不含钎尾) Overall dimension (Exclude shank adapter)	mm	1008X292X233
	重量 Weight	KG	170
	中心高 Center height	mm	88
	钎尾 Shank adapter	/	R32/T38/T45/T51/TC35(Φ52),R32/R38/T38/TC35/SR38(Φ38)
	凿孔直径 Hole dia.	mm	33-76
冲击性能参数 Impact	最大冲击功率 Max.impact power	KW	18
	最大冲击压力 Max.impact pressure	Bar	230
	冲击频率 Impact frequency	Hz	60
	流量 Flow	L/min	75-92
	冲击能 Impact energy	J	300
	开孔冲击压力 Open hole impact pressure	Bar	130
推进参数 Feed	工作推进力 Work feed force	N	12000-15000
	开孔推进力 Open hole feed force	N	9000
缓冲参数 Buffer	缓冲进油流量 Buffer oil flow	L/min	8
	空载缓冲压力 No-load-buffer pressure	Bar	35
	工作凿岩缓冲压力 Rock drilling buffer pressure	Bar	50-120
回转性能参数 Rotation	排量 Displacement	CC	80/100/125/160
	转速范围 Rotation speed	Rpm	370/340/275/215
	最大扭矩 Max.torque	Nm	440/640/820/1000
	最大进油压力 Max.oil inlet pressure	Bar	210
	流量 Flow	L/min	75
充气参数 Accumulators	高压氮气压力 High pressure nitrogen pressure	Bar	95
	缓冲氮气压力 Buffer nitrogen pressure	Bar	25
	回油氮气压力 Return oil nitrogen pressure	Bar	-
其他参数 Others	水压 Water pressure	Bar	5-25
	水流量 Water flow	L/min	40-120
	润滑气雾压力 Air lubrication pressure	Bar	3
	润滑气对应流量 Lubrication air flow	L/S	5



## A18D/LX (YYG-18/1000) 液压凿岩机



### 设备视图

► Overall dimension

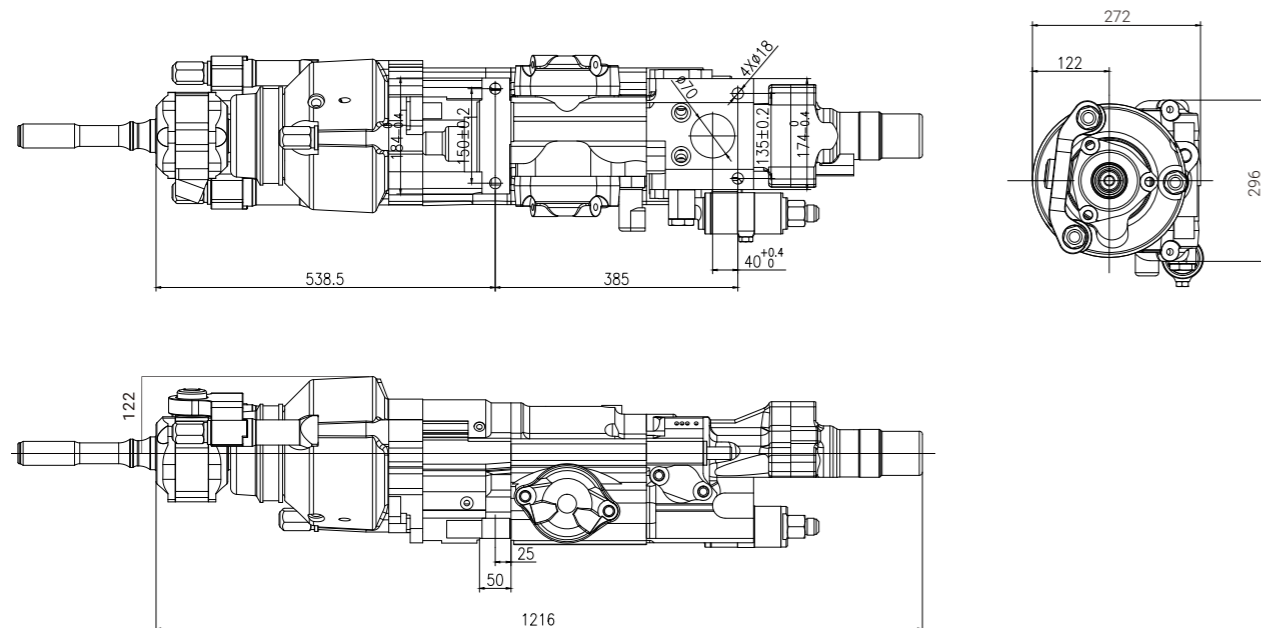

### A18D/LX (YYG-18/1000) 液压凿岩机技术参数

A18D/LX(YYG-18/1000) rock drill technical data

结构参数 Structure	外形尺寸 (不含钎尾) Overall dimension (Exclude shank adapter)	mm	1216X296X272
	重量 Weight	KG	225
	中心高 Center height	mm	122
	钎尾 Shank adapter	/	T38/T45
	凿孔直径 Hole dia.	mm	45-76
冲击性能参数 Impact	最大冲击功率 Max.impact power	KW	18
	最大冲击压力 Max.impact pressure	Bar	230
	冲击频率 Impact frequency	Hz	60
	流量 Flow	L/min	75-92
	冲击能 Impact energy	J	300
	开孔冲击压力 Open hole impact pressure	Bar	130
推进参数 Feed	工作推进力 Work feed force	N	12000-15000
	开孔推进力 Open hole feed force	N	9000
缓冲参数 Buffer	缓冲进油流量 Buffer oil flow	L/min	8
	空载缓冲压力 No-load-buffer pressure	Bar	35
	工作凿岩缓冲压力 Rock drilling buffer pressure	Bar	50-120
回转性能参数 Rotation	排量 Displacement	CC	160/250
	转速范围 Rotation speed	Rpm	215/135
	最大扭矩 Max.torque	Nm	1000/1550
	最大进油压力 Max.oil inlet pressure	Bar	210
	流量 Flow	L/min	75
充气参数 Accumulators	高压氮气压力 High pressure nitrogen pressure	Bar	95
	缓冲氮气压力 Buffer nitrogen pressure	Bar	25
	回油氮气压力 Return oil nitrogen pressure	Bar	-
其他参数 Others	水压 Water pressure	Bar	5-25
	水流量 Water flow	L/min	55-120
	润滑气雾压力 Air lubrication pressure	Bar	3
	润滑气对应流量 Lubrication air flow	L/S	5

## A18D+液压凿岩机



### 设备视图

► Overall dimension

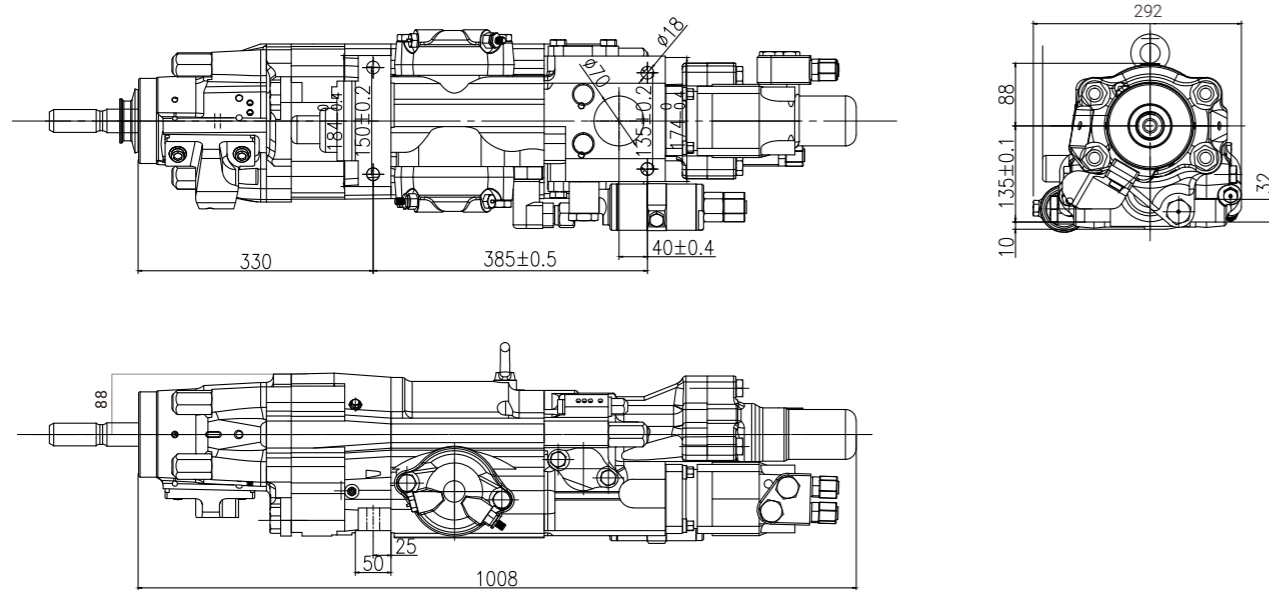

### A18D+ 液压凿岩机技术参数

A18D+ rock drill technical data

结构参数 Structure	外形尺寸 (不含钎尾) Overall dimension (Exclude shank adapter)	mm	1008X292X233
	重量 Weight	KG	175
	中心高 Center height	mm	88
	钎尾 Shank adapter	/	R32/R38/T38/SR38
	凿孔直径 Hole dia.	mm	38-64
冲击性能参数 Impact	最大冲击功率 Max.impact power	KW	18
	最大冲击压力 Max.impact pressure	Bar	230
	冲击频率 Impact frequency	Hz	60
	流量 Flow	L/min	75-92
	冲击能 Impact energy	J	300
	开孔冲击压力 Open hole impact pressure	Bar	130
推进参数 Feed	工作推进力 Work feed force	N	12000-15000
	开孔推进力 Open hole feed force	N	9000
缓冲参数 Buffer	缓冲进油流量 Buffer oil flow	L/min	8
	空载缓冲压力 No-load-buffer pressure	Bar	35
	工作凿岩缓冲压力 Rock drilling buffer pressure	Bar	50-120
回转性能参数 Rotation	排量 Displacement	CC	80/100/125/160
	转速范围 Rotation speed	Rpm	370/340/275/215
	最大扭矩 Max.torque	Nm	440/640/820/1000
	最大进油压力 Max.oil inlet pressure	Bar	210
	流量 Flow	L/min	75
充气参数 Accumulators	高压氮气压力 High pressure nitrogen pressure	Bar	95
	缓冲氮气压力 Buffer nitrogen pressure	Bar	25
	回油氮气压力 Return oil nitrogen pressure	Bar	-
其他参数 Others	水压 Water pressure	Bar	5-25
	水流量 Water flow	L/min	55-120
	润滑气雾压力 Air lubrication pressure	Bar	3
	润滑气对应流量 Lubrication air flow	L/S	5

# A20A (YYG-20/1550) 液压凿岩机



## 设备视图

► Overall dimension

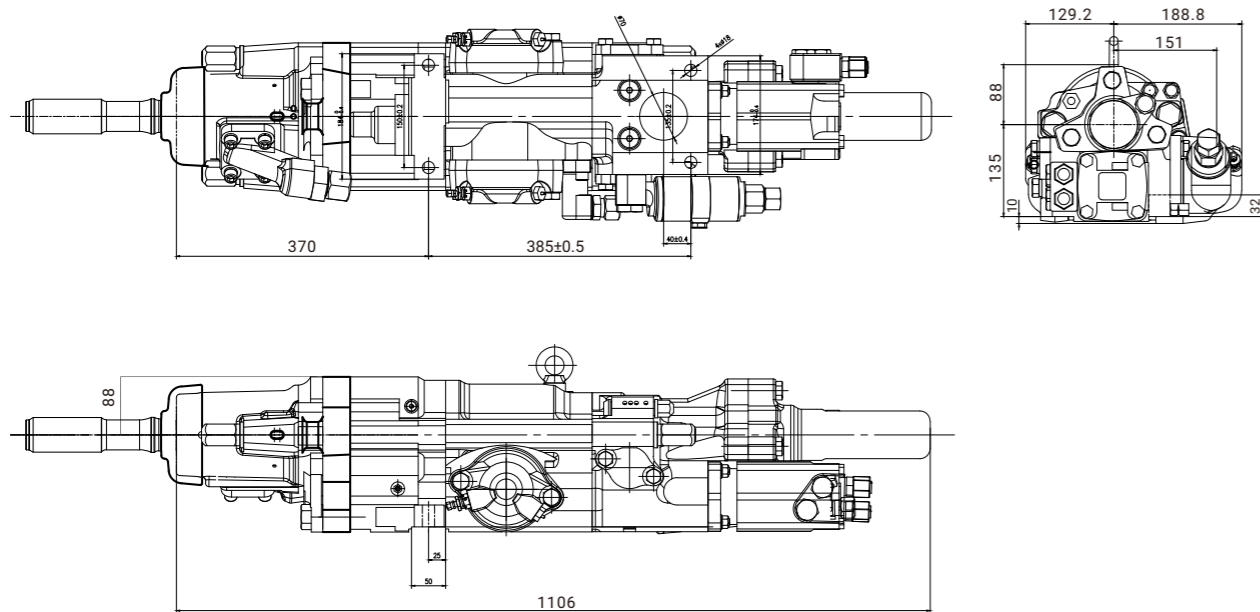

## A20A (YYG-20/1550) 液压凿岩机技术参数

A20A(YYG-20/1550) rock drill technical data

结构参数 Structure	外形尺寸 (不含钎尾) Overall dimension (Exclude shank adapter)	mm	1106X318X233
	重量 Weight	KG	190
	中心高 Center height	mm	88
	钎尾 Shank adapter	/	T38/T45/T51E
	凿孔直径 Hole dia.	mm	76-102
冲击性能参数 Impact	最大冲击功率 Max.impact power	KW	20
	最大冲击压力 Max.impact pressure	Bar	230
	冲击频率 Impact frequency	Hz	42-50
	流量 Flow	L/min	105
	冲击能 Impact energy	J	460-400
	开孔冲击压力 Open hole impact pressure	Bar	130
推进参数 Feed	工作推进力 Work feed force	N	12000-15000
	开孔推进力 Open hole feed force	N	9000
缓冲参数 Buffer	缓冲进油流量 Buffer oil flow	L/min	8
	空载缓冲压力 No-load-buffer pressure	Bar	35
	工作凿岩缓冲压力 Rock drilling buffer pressure	Bar	50-120
回转性能参数 Rotation	排量 Displacement	CC	160/200/250/315
	转速范围 Rotation speed	Rpm	215/170/135/110
	最大扭矩 Max.torque	Nm	1000/1240/1550/1970
	最大进油压力 Max.Oil inlet pressure	Bar	210/200
	流量 Flow	L/min	75
充气参数 Accumulators	高压氮气压力 High pressure nitrogen pressure	Bar	95
	缓冲氮气压力 Buffer nitrogen pressure	Bar	25
	回油氮气压力 Return oil nitrogen pressure	Bar	-
其他参数 Others	水压 Water pressure	Bar	5-25
	水流量 Water flow	L/min	55-120
	润滑气雾压力 Air lubrication pressure	Bar	3
	润滑气对应流量 Lubrication air flow	L/S	5.5
	排渣气压最大值 Max.pressure for slag discharge	Bar	12

## A20A/D液压凿岩机



### 设备视图

Overall dimension

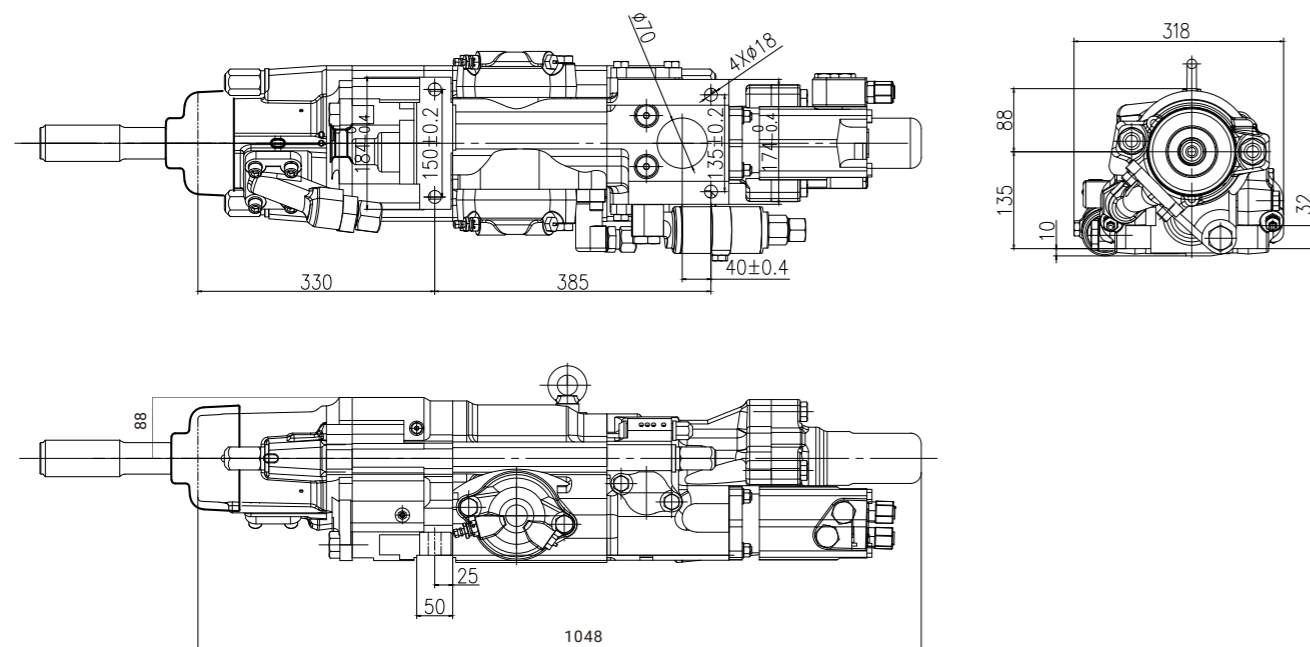

### A20A/D液压凿岩机技术参数

A20A/D rock drill technical data

结构参数 Structure	外形尺寸 (不含钎尾) Overall dimension (Exclude shank adapter)	mm	1048X318X233
	重量 Weight	KG	190
	中心高 Center height	mm	88
	钎尾 Shank adapter	/	R32/T38/T45/T51/TC35
	凿孔直径 Hole dia.	mm	76-102
冲击性能参数 Impact	最大冲击功率 Max.impact power	KW	20
	最大冲击压力 Max.impact pressure	Bar	230
	冲击频率 Impact frequency	Hz	42-50
	流量 Flow	L/min	105
	冲击能 Impact energy	J	460-400
	开孔冲击压力 Open hole impact pressure	Bar	140
推进参数 Feed	工作推进力 Work feed force	N	12000-15000
	开孔推进力 Open hole feed force	N	9000
缓冲参数 Buffer	缓冲进油流量 Buffer oil flow	L/min	8
	空载缓冲压力 No-load-buffer pressure	Bar	35
	工作凿岩缓冲压力 Rock drilling buffer pressure	Bar	50-120
回转性能参数 Rotation	排量 Displacement	CC	160/200/250/315
	转速范围 Rotation speed	Rpm	215/170/135/110
	最大扭矩 Max.torque	Nm	1000/1240/1550/1970
	最大进油压力 Max.Oil inlet pressure	Bar	210/200
	流量 Flow	L/min	75
	充气参数 Accumulators	高压氮气压力 High pressure nitrogen pressure	Bar
缓冲氮气压力 Buffer nitrogen pressure		Bar	25
回油氮气压力 Return oil nitrogen pressure		Bar	-
其他参数 Others	水压 Water pressure	Bar	5-25
	水流量 Water flow	L/min	105-165
	润滑气雾压力 Air lubrication pressure	Bar	3
	润滑气对应流量 Lubrication air flow	L/S	5
	排渣气压最大值 Max.pressure for slag discharge	Bar	12

# A22L/D (YVG-22/1550) 液压凿岩机



## 设备视图

Overall dimension

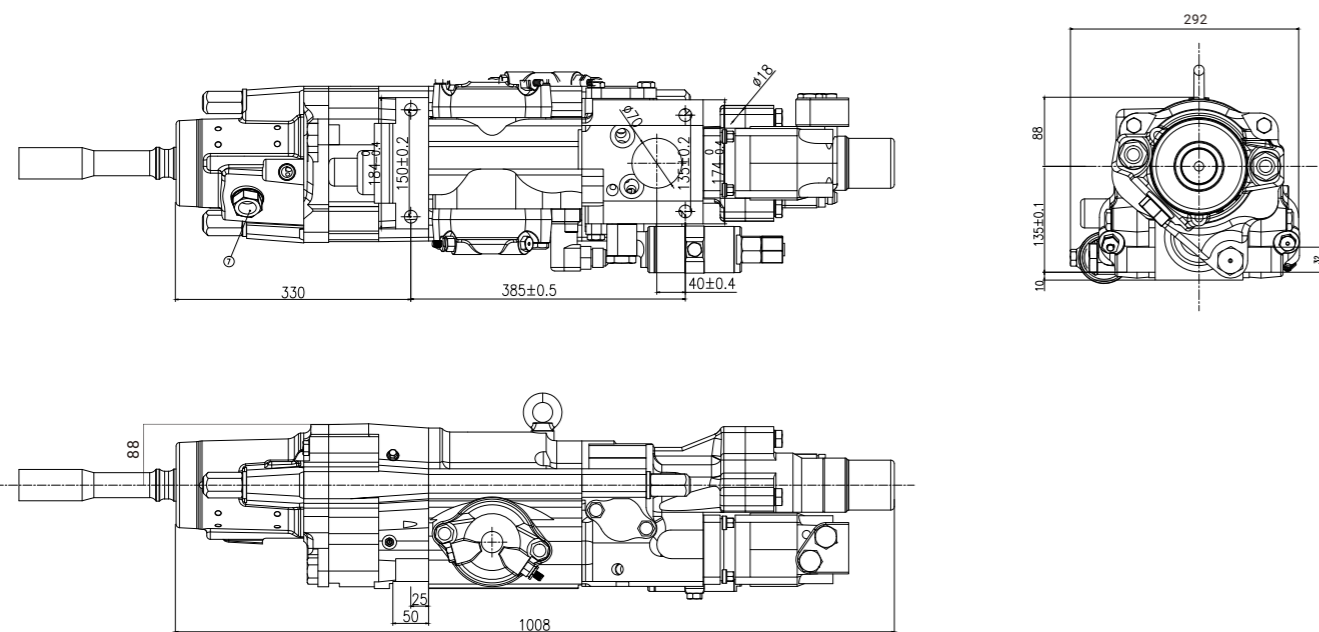

## A22L/D (YVG-22/1550) 液压凿岩机技术参数

A22L/D(YVG-22/1550) rock drill technical data

结构参数 Structure	外形尺寸 (不含钎尾) Overall dimension (Exclude shank adapter)	mm	1008X292X233
	重量 Weight	KG	180
	中心高 Center height	mm	88
	钎尾 Shank adapter	/	T38E/T45E
	凿孔直径 Hole dia.	mm	64-102
冲击性能参数 Impact	最大冲击功率 Max.impact power	KW	22
	最大冲击压力 Max.impact pressure	Bar	220
	冲击频率 Impact frequency	Hz	53
	流量 Flow	L/min	105
	冲击能 Impact energy	J	400
	开孔冲击压力 Open hole impact pressure	Bar	150
推进参数 Feed	工作推进力 Work feed force	N	12000-15000
	开孔推进力 Open hole feed force	N	9000
缓冲参数 Buffer	缓冲进油流量 Buffer oil flow	L/min	-
	空载缓冲压力 No-load-buffer pressure	Bar	-
	工作凿岩缓冲压力 Rock drilling buffer pressure	Bar	-
回转性能参数 Rotation	排量 Displacement	CC	160/250
	转速范围 Rotation speed	Rpm	0-215/0-135
	最大扭矩 Max.torque	Nm	1000/1550
	最大进油压力 Max.oil inlet pressure	Bar	210/200
	流量 Flow	L/min	75
充气参数 Accumulators	高压氮气压力 High pressure nitrogen pressure	Bar	90
	缓冲氮气压力 Buffer nitrogen pressure	Bar	25
	回油氮气压力 Return oil nitrogen pressure	Bar	-
其他参数 Others	水压 Water pressure	Bar	5-25
	水流量 Water flow	L/min	40-120
	润滑气雾压力 Air lubrication pressure	Bar	3
	润滑气对应流量 Lubrication air flow	L/S	7

## A22L/D+外缓冲 (YIG-22/1550) 液压凿岩机



### 设备视图

► Overall dimension

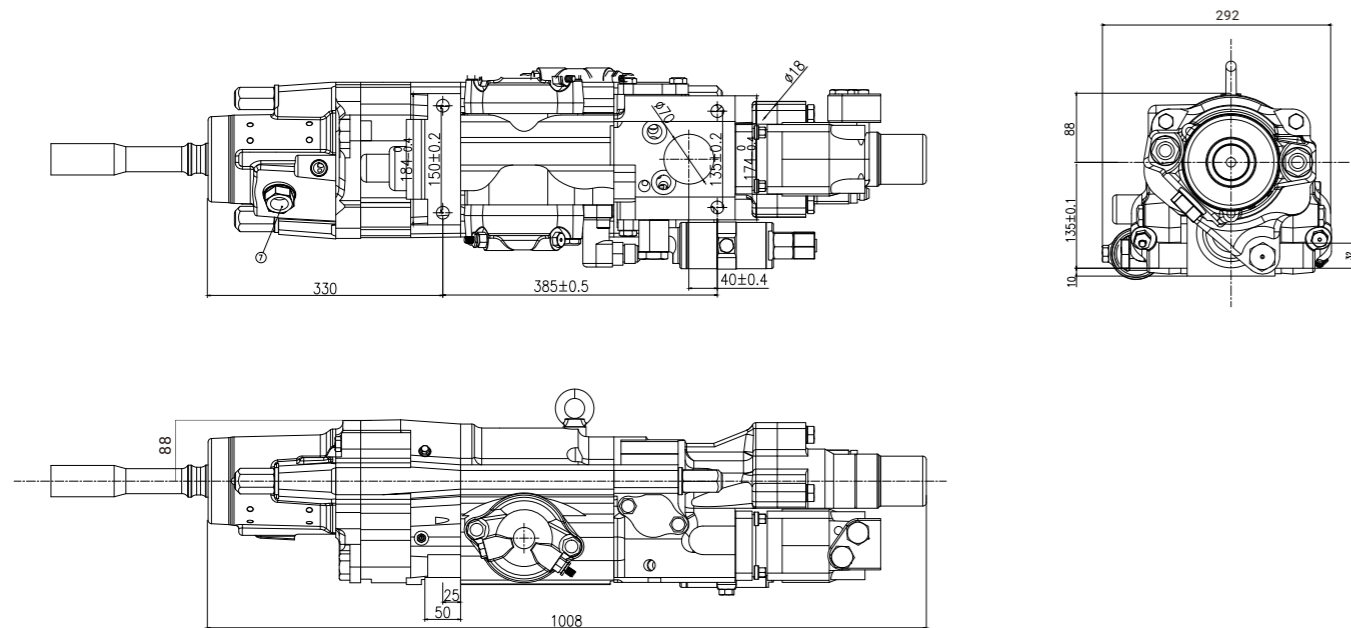

### A22L/D+外缓冲 (YIG-22/1550) 液压凿岩机技术参数

A22L/D+(YIG-22/1550) rock drill technical data

结构参数 Structure	外形尺寸 (不含钎尾) Overall dimension (Exclude shank adapter)	mm	1008X292X233
	重量 Weight	KG	180
	中心高 Center height	mm	88
	钎尾 Shank adapter	/	T38E/T45E
	凿孔直径 Hole dia.	mm	64-102
冲击性能参数 Impact	最大冲击功率 Max.impact power	KW	22
	最大冲击压力 Max.impact pressure	Bar	220
	冲击频率 Impact frequency	Hz	53
	流量 Flow	L/min	105
	冲击能 Impact energy	J	400
	开孔冲击压力 Open hole impact pressure	Bar	150
推进参数 Feed	工作推进力 Work feed force	N	12000-15000
	开孔推进力 Open hole feed force	N	9000
缓冲参数 Buffer	缓冲进油流量 Buffer oil flow	L/min	8
	空载缓冲压力 No-load-buffer pressure	Bar	35
	工作凿岩缓冲压力 Rock drilling buffer pressure	Bar	50-120
回转性能参数 Rotation	排量 Displacement	CC	160/250
	转速范围 Rotation speed	Rpm	0-215/0-135
	最大扭矩 Max.torque	Nm	1000/1550
	最大进油压力 Max.oil inlet pressure	Bar	210/200
	流量 Flow	L/min	75
充气参数 Accumulators	高压氮气压力 High pressure nitrogen pressure	Bar	95
	缓冲氮气压力 Buffer nitrogen pressure	Bar	25
	回油氮气压力 Return oil nitrogen pressure	Bar	-
其他参数 Others	水压 Water pressure	Bar	25
	水流量 Water flow	L/min	40-120
	润滑气雾压力 Air lubrication pressure	Bar	3
	润滑气对应流量 Lubrication air flow	L/S	7

## A25L (YVG-25/1550) 液压凿岩机



### 设备视图

► Overall dimension

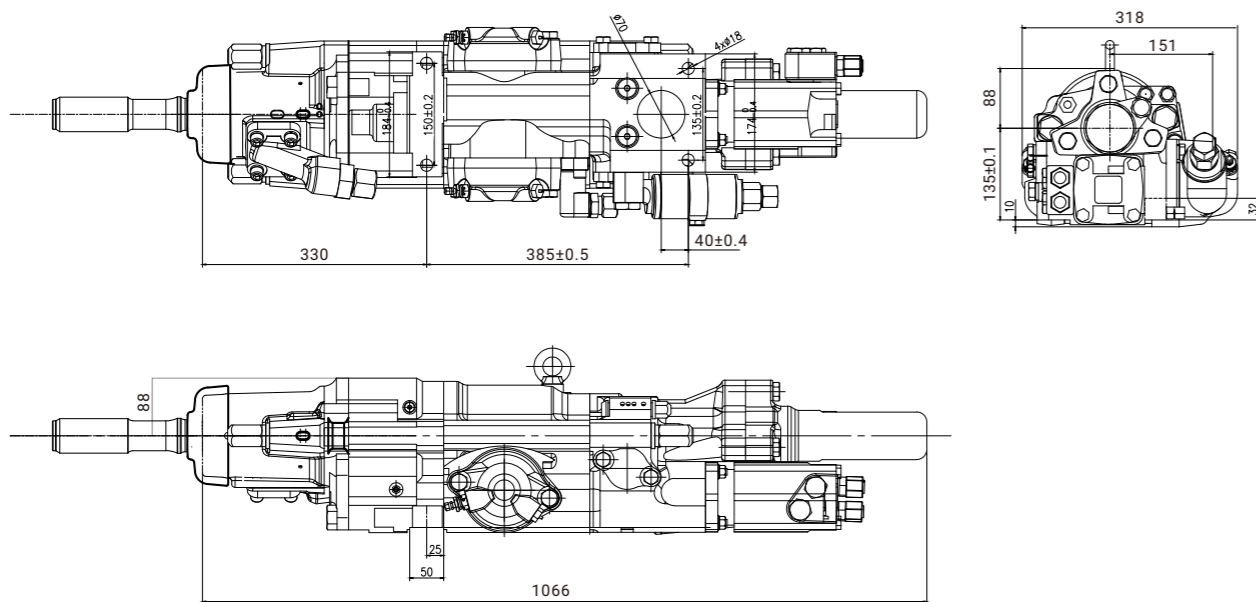

### A25L (YVG-25/1550) 液压凿岩机技术参数

A25L(YVG-25/1550) rock drill technical data

结构参数 Structure	外形尺寸 (不含钎尾) Overall dimension (Exclude shank adapter)	mm	1066X318X233
	重量 Weight	KG	180
	中心高 Center height	mm	88
	钎尾 Shank adapter	/	T45E/T51E
	凿孔直径 Hole dia.	mm	76-115
冲击性能参数 Impact	最大冲击功率 Max.impact power	KW	25
	最大冲击压力 Max.impact pressure	Bar	230
	冲击频率 Impact frequency	Hz	42/55
	流量 Flow	L/min	110
	冲击能 Impact energy	J	590/450
	开孔冲击压力 Open hole impact pressure	Bar	150
推进参数 Feed	工作推进力 Work feed force	N	12000-15000
	开孔推进力 Open hole feed force	N	9000
缓冲参数 Buffer	缓冲进油流量 Buffer oil flow	L/min	8
	空载缓冲压力 No-load-buffer pressure	Bar	35
	工作凿岩缓冲压力 Rock drilling buffer pressure	Bar	50-120
回转性能参数 Rotation	排量 Displacement	CC	250/315
	转速范围 Rotation speed	Rpm	135/110
	最大扭矩 Max.torque	Nm	1550/1970
	最大进油压力 Max.oil inlet pressure	Bar	210
	流量 Flow	L/min	75
充气参数 Accumulators	高压氮气压力 High pressure nitrogen pressure	Bar	95
	缓冲氮气压力 Buffer nitrogen pressure	Bar	25
	回油氮气压力 Return oil nitrogen pressure	Bar	-
其他参数 Others	水压 Water pressure	Bar	20
	水流量 Water flow	L/min	40-120
	润滑气雾压力 Air lubrication pressure	Bar	3
	润滑气对应流量 Lubrication air flow	L/S	5

# A25LX液压凿岩机



## 设备视图

► Overall dimension

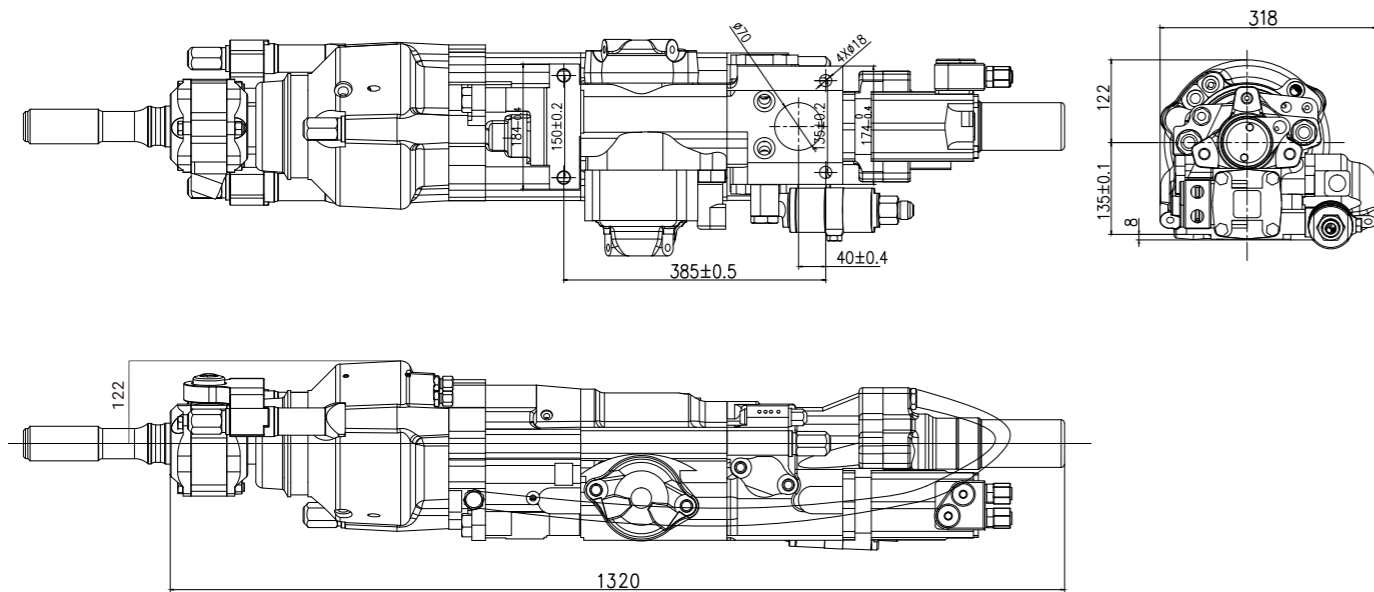

## A25LX液压凿岩机技术参数

A25LX rock drill technical data

结构参数 Structure	外形尺寸 (不含钎尾) Overall dimension (Exclude shank adapter)	mm	1320X318X265
	重量 Weight	KG	250
	中心高 Center height	mm	122
	钎尾 Shank adapter	/	T45E/T51E/TDS76
	凿孔直径 Hole dia.	mm	76-115
冲击性能参数 Impact	最大冲击功率 Max.impact power	KW	25
	最大冲击压力 Max.impact pressure	Bar	230
	冲击频率 Impact frequency	Hz	42/55
	流量 Flow	L/min	110
	冲击能 Impact energy	J	590/450
	开孔冲击压力 Open hole impact pressure	Bar	150
推进参数 Feed	工作推进力 Work feed force	N	12000-15000
	开孔推进力 Open hole feed force	N	9000
缓冲参数 Buffer	缓冲进油流量 Buffer oil flow	L/min	8
	空载缓冲压力 No-load-buffer pressure	Bar	35
	工作凿岩缓冲压力 Rock drilling buffer pressure	Bar	50-120
回转性能参数 Rotation	排量 Displacement	CC	250/315
	转速范围 Rotation speed	Rpm	135/110
	最大扭矩 Max.torque	Nm	1550/1970
	最大进油压力 Max.oil inlet pressure	Bar	210
	流量 Flow	L/min	75
充气参数 Accumulators	高压氮气压力 High pressure nitrogen pressure	Bar	95
	缓冲氮气压力 Buffer nitrogen pressure	Bar	25
	回油氮气压力 Return oil nitrogen pressure	Bar	-
其他参数 Others	水压 Water pressure	Bar	20
	水流量 Water flow	L/min	40-120
	润滑气雾压力 Air lubrication pressure	Bar	3
	润滑气对应流量 Lubrication air flow	L/S	5



# M8B/D (YYG-8/400) 液压凿岩机

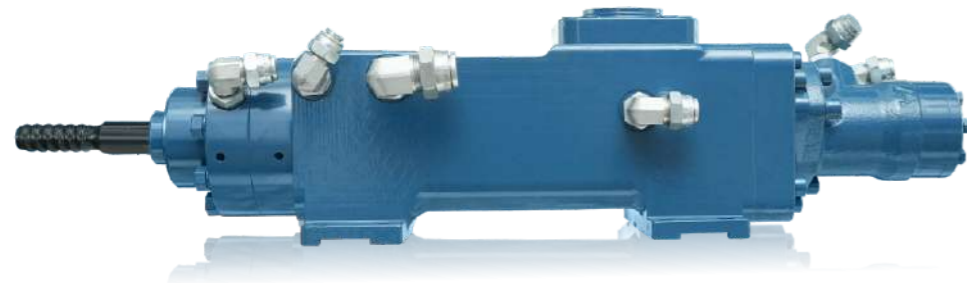

## 设备视图

► Overall dimension

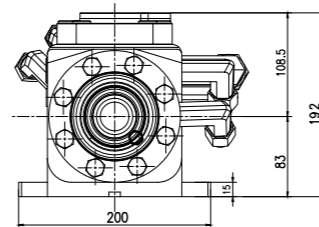
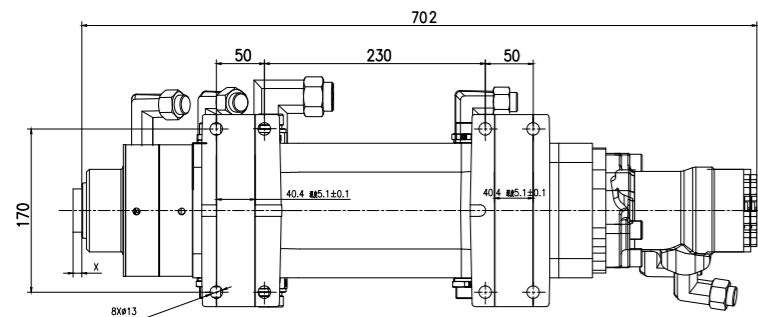

## M8B/D (YYG-8/400) 液压凿岩机技术参数

M8B/D(YYG-8/400) rock drill technical data

结构参数 Structure	外形尺寸 (不含钎尾) Overall dimension (Exclude shank adapter)	mm	702X200X192
	重量 Weight	KG	75
	中心高 Center height	mm	108.5
	钎尾 Shank adapter	/	H25F/R28F/R32F/R32/R38
	凿孔直径 Hole dia.	mm	32-51
冲击性能参数 Impact	最大冲击功率 Max.impact power	KW	8
	最大冲击压力 Max.impact pressure	Bar	110-150
	冲击频率 Impact frequency	Hz	55-65
	流量 Flow	L/min	55-65
	冲击能 Impact energy	J	86-117
	开孔冲击压力 Open hole impact pressure	Bar	80
推进参数 Feed	工作推进力 Work feed force	N	6000-9000
	开孔推进力 Open hole feed force	N	5000
缓冲参数 Buffer	缓冲进油流量 Buffer oil flow	L/min	-
	空载缓冲压力 No-load-buffer pressure	Bar	-
	工作凿岩缓冲压力 Rock drilling buffer pressure	Bar	-
回转性能参数 Rotation	排量 Displacement	CC	100/125/160
	转速范围 Rotation speed	Rpm	300
	最大扭矩 Max.torque	Nm	251/313/401
	最大进油压力 Max.oil inlet pressure	Bar	175
	流量 Flow	L/min	30/37.5/48
充气参数 Accumulators	高压氮气压力 High pressure nitrogen pressure	Bar	35
	缓冲氮气压力 Buffer nitrogen pressure	Bar	-
	回油氮气压力 Return oil nitrogen pressure	Bar	-
其他参数 Others	水压 Water pressure	Bar	10-15
	水流量 Water flow	L/min	20-50
	润滑气雾压力 Air lubrication pressure	Bar	2
	润滑气对应流量 Lubrication air flow	L/S	5

# M10B/D (YYG-10/480) 液压凿岩机



## 设备视图

► Overall dimension

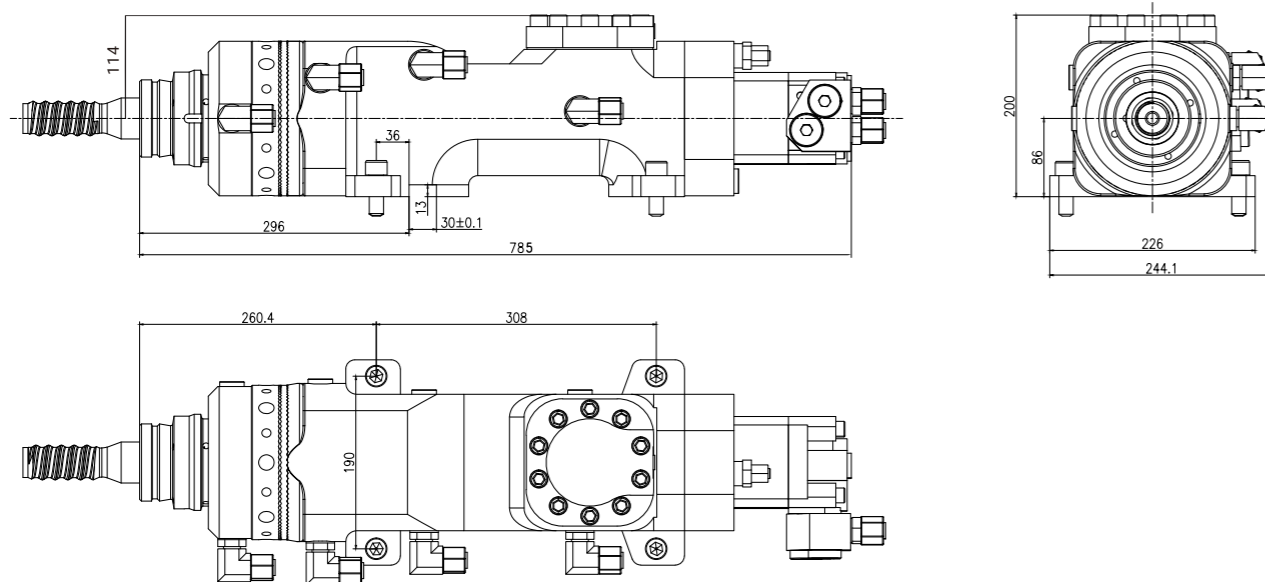

## M10B/D (YYG-10/480) 液压凿岩机技术参数

M10B/D(YYG-10/480) rock drill technical data

结构参数 Structure	外形尺寸 (不含钎尾) Overall dimension (Exclude shank adapter)	mm	785X226X200
	重量 Weight	KG	105
	中心高 Center height	mm	114
	钎尾 Shank adapter	/	H25F/R28F/R32F/R32/R38/T38
	凿孔直径 Hole dia.	mm	32-64
冲击性能参数 Impact	最大冲击功率 Max.impact power	KW	10
	最大冲击压力 Max.impact pressure	Bar	130-160
	冲击频率 Impact frequency	Hz	47-53
	流量 Flow	L/min	62-68
	冲击能 Impact energy	J	135-160
	开孔冲击压力 Open hole impact pressure	Bar	80
推进参数 Feed	工作推进力 Work feed force	N	6000-10000
	开孔推进力 Open hole feed force	N	5000
缓冲参数 Buffer	缓冲进油流量 Buffer oil flow	L/min	-
	空载缓冲压力 No-load-buffer pressure	Bar	-
	工作凿岩缓冲压力 Rock drilling buffer pressure	Bar	-
回转性能参数 Rotation	排量 Displacement	CC	100/125/160
	转速范围 Rotation speed	Rpm	300
	最大扭矩 Max.torque	Nm	485
	最大进油压力 Max.oil inlet pressure	Bar	210
	流量 Flow	L/min	48
充气参数 Accumulators	高压氮气压力 High pressure nitrogen pressure	Bar	60
	缓冲氮气压力 Buffer nitrogen pressure	Bar	-
	回油氮气压力 Return oil nitrogen pressure	Bar	-
其他参数 Others	水压 Water pressure	Bar	10-15
	水流量 Water flow	L/min	30-60
	润滑气雾压力 Air lubrication pressure	Bar	3
	润滑气对应流量 Lubrication air flow	L/S	5

# M13B/D (YVG-13/385) 液压凿岩机

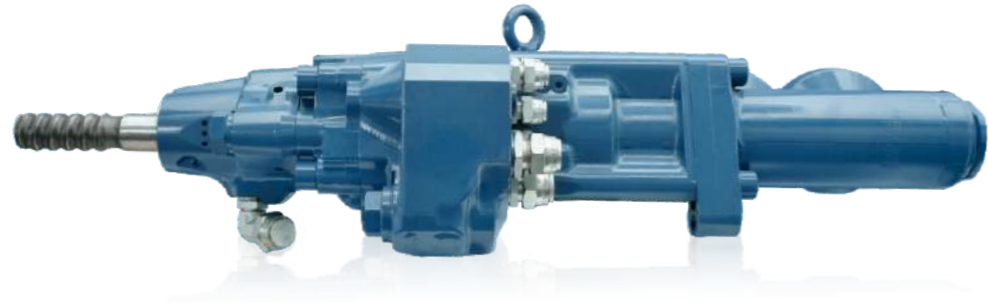

## 设备视图

► Overall dimension

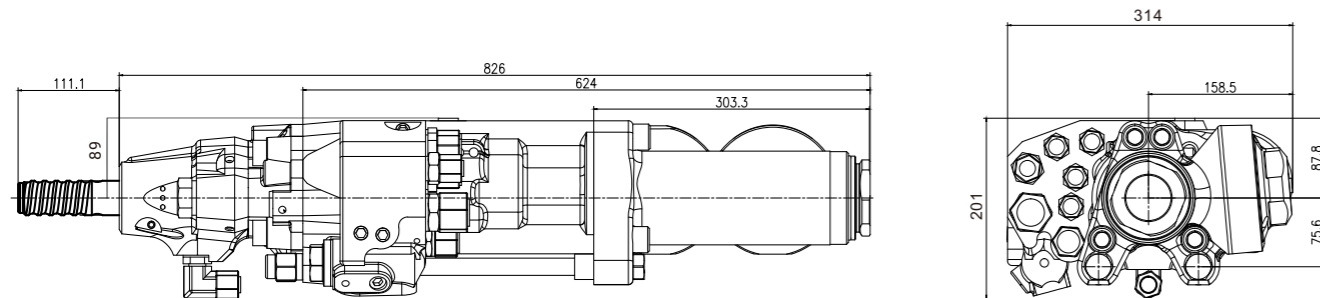

## M13B/D (YVG-13/385) 液压凿岩机技术参数

M13B/D(YVG-13/385) rock drill technical data

结构参数 Structure	外形尺寸 (不含钎尾) Overall dimension (Exclude shank adapter)	mm	826X314X201
	重量 Weight	KG	105
	中心高 Center height	mm	89
	钎尾 Shank adapter	/	H25F/R28F/R32F/R32/R38/T38
	凿孔直径 Hole dia.	mm	45-76
冲击性能参数 Impact	最大冲击功率 Max.impact power	KW	13
	最大冲击压力 Max.impact pressure	Bar	110-130
	冲击频率 Impact frequency	Hz	45-62.5
	流量 Flow	L/min	80-105
	冲击能 Impact energy	J	179-200
	开孔冲击压力 Open hole impact pressure	Bar	90
推进参数 Feed	工作推进力 Work feed force	N	8000-12000
	开孔推进力 Open hole feed force	N	7000
缓冲参数 Buffer	缓冲进油流量 Buffer oil flow	L/min	-
	空载缓冲压力 No-load-buffer pressure	Bar	-
	工作凿岩缓冲压力 Rock drilling buffer pressure	Bar	-
回转性能参数 Rotation	排量 Displacement	CC	031-043-055-067
	转速范围 Rotation speed	Rpm	235-209-193-237
	最大扭矩 Max.torque	Nm	226-305-385-466
	最大进油压力 Max.oil inlet pressure	Bar	140
	流量 Flow	L/min	25-30-35-52
充气参数 Accumulators	高压氮气压力 High pressure nitrogen pressure	Bar	35
	缓冲氮气压力 Buffer nitrogen pressure	Bar	4
	回油氮气压力 Return oil nitrogen pressure	Bar	-
其他参数 Others	水压 Water pressure	Bar	12-20
	水流量 Water flow	L/min	30-60
	润滑气雾压力 Air lubrication pressure	Bar	3
	润滑气对应流量 Lubrication air flow	L/S	5

# M21B/D液压凿岩机



## 设备视图

► Overall dimension

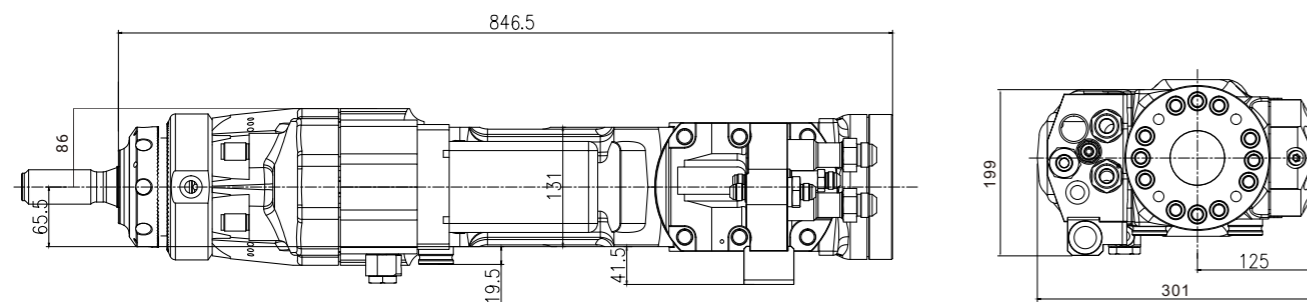

## M21B/D液压凿岩机技术参数

M21B/D rock drill technical data

结构参数 Structure	外形尺寸 (不含钎尾) Overall dimension (Exclude shank adapter)	mm	846.5X301X199
	重量 Weight	KG	175
	中心高 Center height	mm	86
	钎尾 Shank adapter	/	R32/R38/T38/T45/T38L/R38L
	凿孔直径 Hole dia.	mm	45-76
冲击性能参数 Impact	最大冲击功率 Max.impact power	KW	21
	最大冲击压力 Max.impact pressure	Bar	165-200
	冲击频率 Impact frequency	Hz	55-63
	流量 Flow	L/min	95-118
	冲击能 Impact energy	J	252-330
	开孔冲击压力 Open hole impact pressure	Bar	110
推进参数 Feed	工作推进力 Work feed force	N	11000-13000
	开孔推进力 Open hole feed force	N	9000
缓冲参数 Buffer	缓冲进油流量 Buffer oil flow	L/min	-
	空载缓冲压力 No-load-buffer pressure	Bar	-
	工作凿岩缓冲压力 Rock drilling buffer pressure	Bar	-
回转性能参数 Rotation	排量 Displacement	CC	100/125/160
	转速范围 Rotation speed	Rpm	303/303/296
	最大扭矩 Max.torque	Nm	477/597/764
	最大进油压力 Max.oil inlet pressure	Bar	210
	流量 Flow	L/min	48/60/75
充气参数 Accumulators	高压氮气压力 High pressure nitrogen pressure	Bar	60
	缓冲氮气压力 Buffer nitrogen pressure	Bar	-
	回油氮气压力 Return oil nitrogen pressure	Bar	5
	水压 Water pressure	Bar	14-24
其他参数 Others	水流量 Water flow	L/min	60-120
	润滑气雾压力 Air lubrication pressure	Bar	3
	润滑气对应流量 Lubrication air flow	L/S	5

# M27D液压凿岩机



## 设备视图

Overall dimension

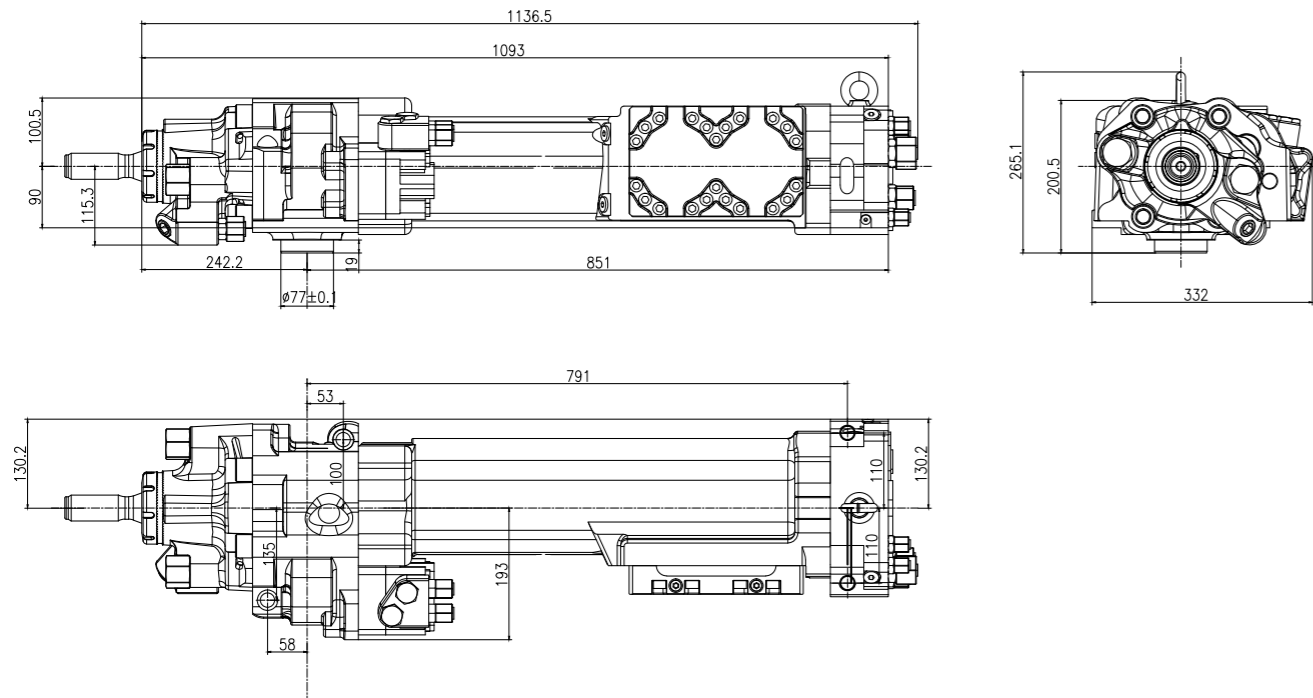

## M27D液压凿岩机技术参数

M27D rock drill technical data

结构参数 Structure	外形尺寸 (不含钎尾) Overall dimension (Exclude shank adapter)	mm	1093X332X200.5
	重量 Weight	KG	215
	中心高 Center height	mm	100.5
	钎尾 Shank adapter	/	R38/T38/T45
	凿孔直径 Hole dia.	mm	51-89
冲击性能参数 Impact	最大冲击功率 Max.impact power	KW	27
	最大冲击压力 Max.impact pressure	Bar	165-190
	冲击频率 Impact frequency	Hz	63-72
	流量 Flow	L/min	150-170
	冲击能 Impact energy	J	329-380
	开孔冲击压力 Open hole impact pressure	Bar	90
推进参数 Feed	工作推进力 Work feed force	N	14000-17000
	开孔推进力 Open hole feed force	N	8000
缓冲参数 Buffer	缓冲进油流量 Buffer oil flow	L/min	5
	空载缓冲压力 No-load-buffer pressure	Bar	-
	工作凿岩缓冲压力 Rock drilling buffer pressure	Bar	180-200
回转性能参数 Rotation	排量 Displacement	CC	80/100/160
	转速范围 Rotation speed	Rpm	292/269/175
	最大扭矩 Max.torque	Nm	671/838/1342
	最大进油压力 Max.oil inlet pressure	Bar	210
	流量 Flow	L/min	65/75/78
充气参数 Accumulators	高压氮气压力 High pressure nitrogen pressure	Bar	60
	缓冲氮气压力 Buffer nitrogen pressure	Bar	-
	回油氮气压力 Return oil nitrogen pressure	Bar	5
其他参数 Others	水压 Water pressure	Bar	20-30
	水流量 Water flow	L/min	90-130
	润滑气雾压力 Air lubrication pressure	Bar	3
	润滑气对应流量 Lubrication air flow	L/S	5

# S14B/D液压凿岩机

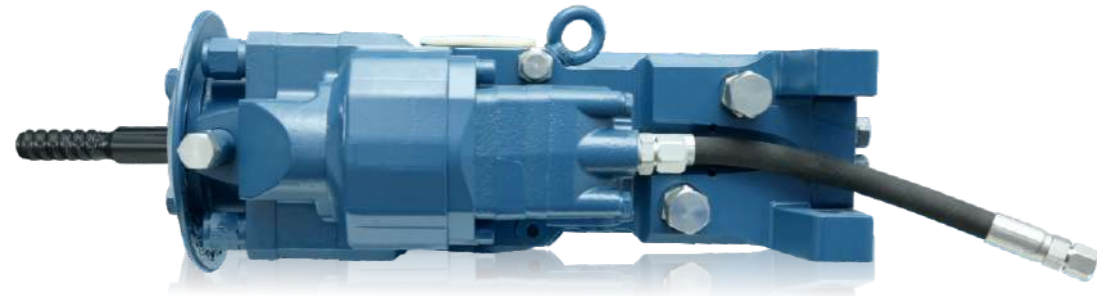

## 设备视图

► Overall dimension

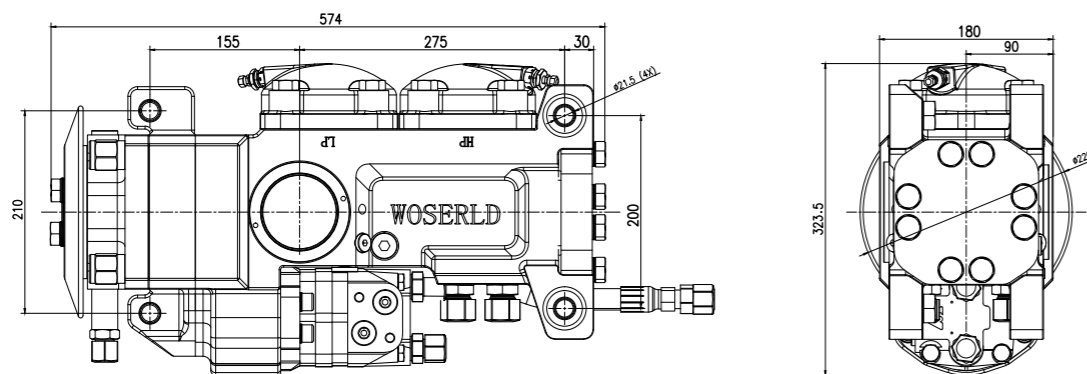

## S14B/D液压凿岩机技术参数

S14B/D rock drill technical data

结构参数 Structure	外形尺寸 (不含钎尾) Overall dimension (Exclude shank adapter)	mm	574X323.5X180
	重量 Weight	KG	127
	中心高 Center height	mm	90
	钎尾 Shank adapter	/	R32F/R32/T38
	凿孔直径 Hole dia.	mm	33-51
冲击性能参数 Impact	最大冲击功率 Max.impact power	KW	14
	最大冲击压力 Max.impact pressure	Bar	180
	冲击频率 Impact frequency	Hz	110
	流量 Flow	L/min	90
	冲击能 Impact energy	J	127
	开孔冲击压力 Open hole impact pressure	Bar	100
推进参数 Feed	工作推进力 Work feed force	N	6000-9000
	开孔推进力 Open hole feed force	N	5000
缓冲参数 Buffer	缓冲进油流量 Buffer oil flow	L/min	-
	空载缓冲压力 No-load-buffer pressure	Bar	-
	工作凿岩缓冲压力 Rock drilling buffer pressure	Bar	-
回转性能参数 Rotation	排量 Displacement	CC	100/125
	转速范围 Rotation speed	Rpm	550/440
	最大扭矩 Max.torque	Nm	340/420
	最大进油压力 Max.oil inlet pressure	Bar	175
	流量 Flow	L/min	75
充气参数 Accumulators	高压氮气压力 High pressure nitrogen pressure	Bar	40
	缓冲氮气压力 Buffer nitrogen pressure	Bar	-
	回油氮气压力 Return oil nitrogen pressure	Bar	4
其他参数 Others	水压 Water pressure	Bar	10-15
	水流量 Water flow	L/min	30-50
	润滑气雾压力 Air lubrication pressure	Bar	4-5
	润滑气对应流量 Lubrication air flow	L/S	15-25

## S20D/L液压凿岩机

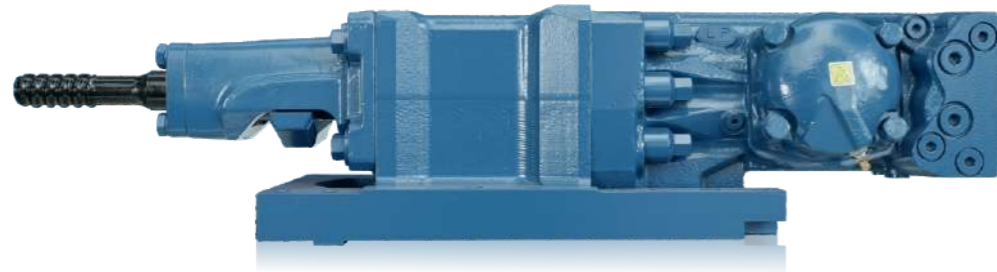

### 设备视图

► Overall dimension

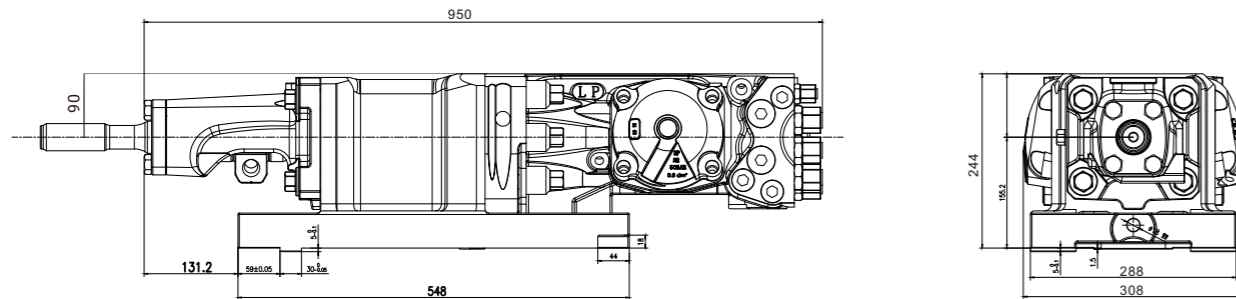

### S20D/L液压凿岩机技术参数

S20D/L rock drill technical data

结构参数 Structure	外形尺寸 (不含钎尾) Overall dimension (Exclude shank adapter)	mm	950X308X244
	重量 Weight	KG	210
	中心高 Center height	mm	90
	钎尾 Shank adapter	/	R32/R38/T38/T45
	凿孔直径 Hole dia.	mm	43-65
冲击性能参数 Impact	最大冲击功率 Max.impact power	KW	20
	最大冲击压力 Max.impact pressure	Bar	220
	冲击频率 Impact frequency	Hz	67
	流量 Flow	L/min	95
	冲击能 Impact energy	J	295
	开孔冲击压力 Open hole impact pressure	Bar	90
推进参数 Feed	工作推进力 Work feed force	N	12000-15000
	开孔推进力 Open hole feed force	N	9000
缓冲参数 Buffer	缓冲进油流量 Buffer oil flow	L/min	-
	空载缓冲压力 No-load-buffer pressure	Bar	-
	工作凿岩缓冲压力 Rock drilling buffer pressure	Bar	-
回转性能参数 Rotation	排量 Displacement	CC	125
	转速范围 Rotation speed	Rpm	0-250
	最大扭矩 Max.torque	Nm	780
	最大进油压力 Max.oil inlet pressure	Bar	175
	流量 Flow	L/min	74
充气参数 Accumulators	高压氮气压力 High pressure nitrogen pressure	Bar	50
	缓冲氮气压力 Buffer nitrogen pressure	Bar	-
	回油氮气压力 Return oil nitrogen pressure	Bar	4
其他参数 Others	水压 Water pressure	Bar	20
	水流量 Water flow	L/min	80-120
	润滑气雾压力 Air lubrication pressure	Bar	4-7
	润滑气对应流量 Lubrication air flow	L/S	4-6

# S25D/L液压凿岩机



## 设备视图

► Overall dimension

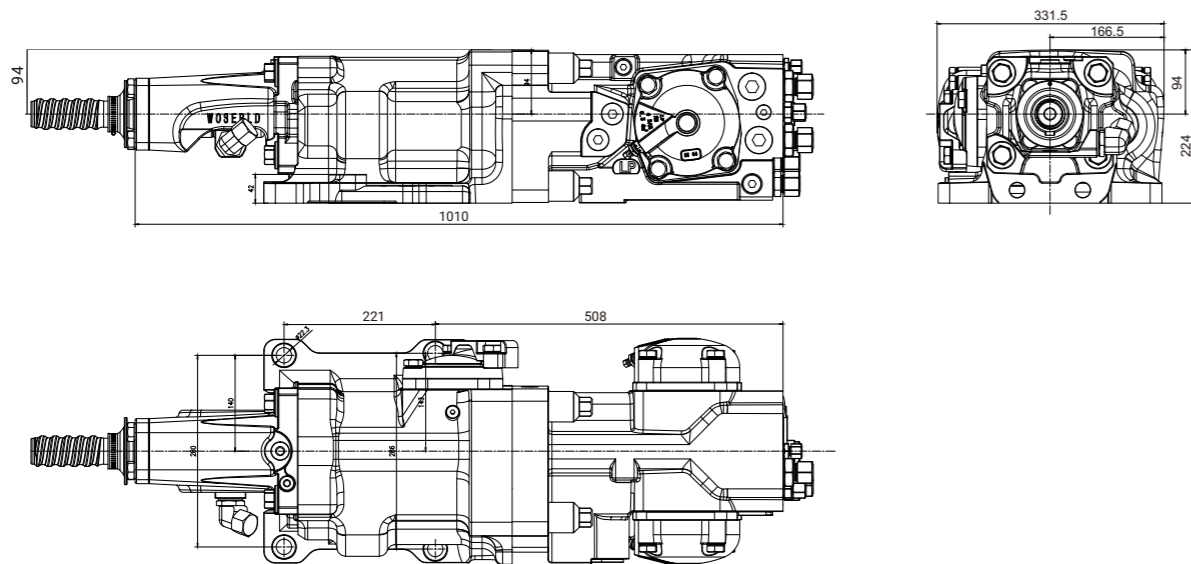

## S25DL液压凿岩机技术参数

S25DL rock drill technical data

结构参数 Structure	外形尺寸 (不含钎尾) Overall dimension (Exclude shank adapter)	mm	1010X331.5X224
	重量 Weight	KG	225
	中心高 Center height	mm	94
	钎尾 Shank adapter	/	T35/T38/T45
	凿孔直径 Hole dia.	mm	43-64
冲击性能参数 Impact	最大冲击功率 Max.impact power	KW	25
	最大冲击压力 Max.impact pressure	Bar	235
	冲击频率 Impact frequency	Hz	93
	流量 Flow	L/min	125
	冲击能 Impact energy	J	269
	开孔冲击压力 Open hole impact pressure	Bar	130
推进参数 Feed	工作推进力 Work feed force	N	12000-15000
	开孔推进力 Open hole feed force	N	9000
缓冲参数 Buffer	缓冲进油流量 Buffer oil flow	L/min	-
	空载缓冲压力 No-load-buffer pressure	Bar	-
	工作凿岩缓冲压力 Rock drilling buffer pressure	Bar	-
回转性能参数 Rotation	排量 Displacement	CC	80/125/160
	转速范围 Rotation speed	Rpm	0-390
	最大扭矩 Max.torque	Nm	720
	最大进油压力 Max.oil inlet pressure	Bar	175
	流量 Flow	L/min	65-75
充气参数 Accumulators	高压氮气压力 High pressure nitrogen pressure	Bar	50
	缓冲氮气压力 Buffer nitrogen pressure	Bar	30
	回油氮气压力 Return oil nitrogen pressure	Bar	4
其他参数 Others	水压 Water pressure	Bar	20
	水流量 Water flow	L/min	80-120
	润滑气雾压力 Air lubrication pressure	Bar	4-7
	润滑气对应流量 Lubrication air flow	L/S	5



## S33L液压凿岩机

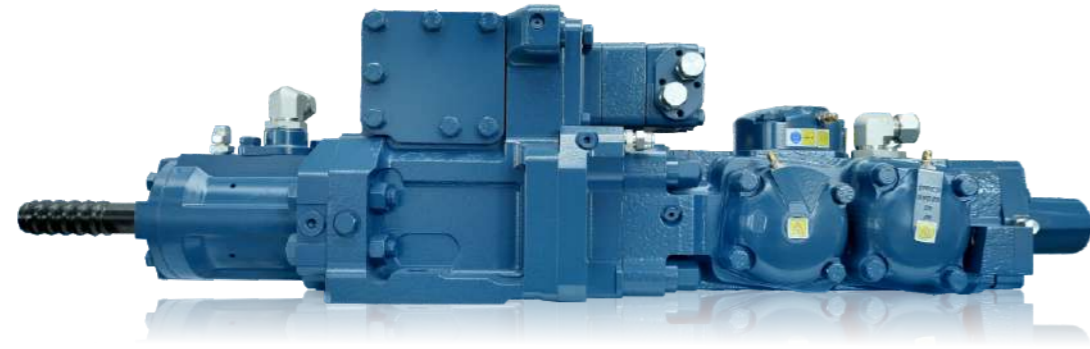

### 设备视图

► Overall dimension

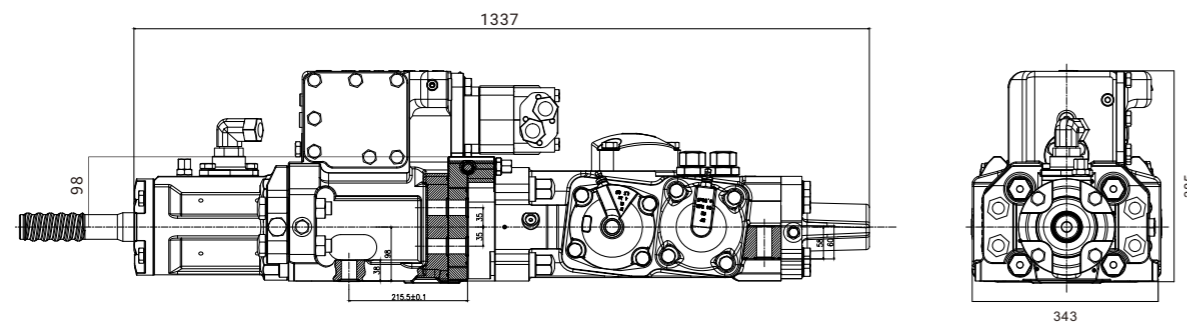

### S33L液压凿岩机技术参数

S33L rock drill technical data

结构参数 Structure	外形尺寸 (不含钎尾) Overall dimension (Exclude shank adapter)	mm	1337X343X385
	重量 Weight	KG	470
	中心高 Center height	mm	98
	钎尾 Shank adapter	/	T51/ST58/ST68
	凿孔直径 Hole dia.	mm	89-127
冲击性能参数 Impact	最大冲击功率 Max.impact power	KW	33
	最大冲击压力 Max.impact pressure	Bar	200
	冲击频率 Impact frequency	Hz	30-40
	流量 Flow	L/min	165
	冲击能 Impact energy	J	825
	开孔冲击压力 Open hole impact pressure	Bar	100
推进参数 Feed	工作推进力 Work feed force	N	16000-22000
	开孔推进力 Open hole feed force	N	12000
缓冲参数 Buffer	缓冲进油流量 Buffer oil flow	L/min	-
	空载缓冲压力 No-load-buffer pressure	Bar	-
	工作凿岩缓冲压力 Rock drilling buffer pressure	Bar	-
回转性能参数 Rotation	排量 Displacement	CC	400/500
	转速范围 Rotation speed	Rpm	0-100
	最大扭矩 Max.torque	Nm	2005/2330
	最大进油压力 Max.oil inlet pressure	Bar	175
	流量 Flow	L/min	85/113
充气参数 Accumulators	高压氮气压力 High pressure nitrogen pressure	Bar	50
	缓冲氮气压力 Buffer nitrogen pressure	Bar	40
	回油氮气压力 Return oil nitrogen pressure	Bar	4
其他参数 Others	水压 Water pressure	Bar	20
	水流量 Water flow	L/min	100-150
	润滑气雾压力 Air lubrication pressure	Bar	4-7
	润滑气对应流量 Lubrication air flow	L/S	5-7

# W14B/D液压凿岩机

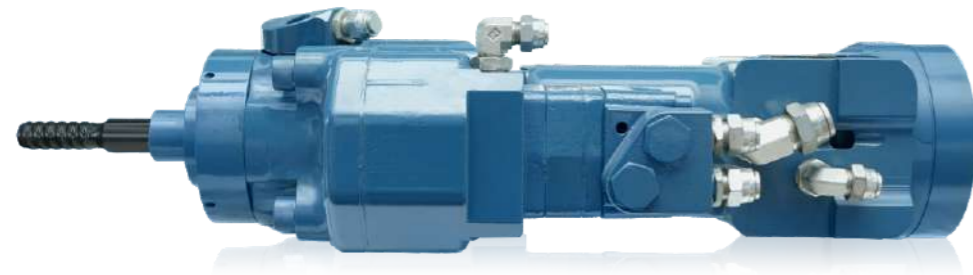

## 设备视图

► Overall dimension

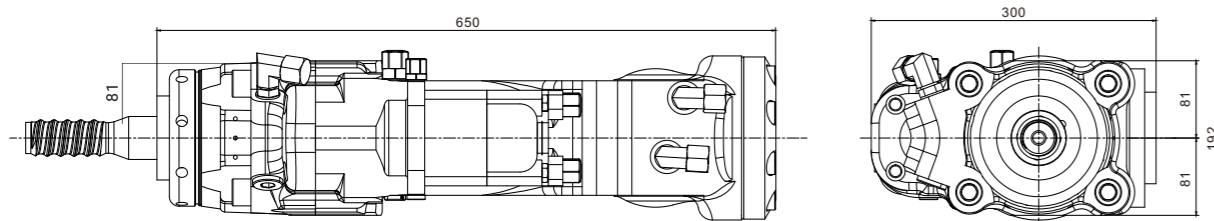

## W14B/D液压凿岩机技术参数

W14B/D rock drill technical data

结构参数 Structure	外形尺寸 (不含钎尾) Overall dimension (Exclude shank adapter)	mm	650X300X192
	重量 Weight	KG	115
	中心高 Center height	mm	81
	钎尾 Shank adapter	/	H25F/R28F/R32F/R32/R38/T38
	凿孔直径 Hole dia.	mm	32-64
冲击性能参数 Impact	最大冲击功率 Max.impact power	KW	14
	最大冲击压力 Max.impact pressure	Bar	160
	冲击频率 Impact frequency	Hz	75
	流量 Flow	L/min	85
	冲击能 Impact energy	J	190
	开孔冲击压力 Open hole impact pressure	Bar	90
推进参数 Feed	工作推进力 Work feed force	N	6000-9000
	开孔推进力 Open hole feed force	N	5000
缓冲参数 Buffer	缓冲进油流量 Buffer oil flow	L/min	-
	空载缓冲压力 No-load-buffer pressure	Bar	-
	工作凿岩缓冲压力 Rock drilling buffer pressure	Bar	-
回转性能参数 Rotation	排量 Displacement	CC	125/160
	转速范围 Rotation speed	Rpm	400/310
	最大扭矩 Max.torque	Nm	550/720
	最大进油压力 Max.oil inlet pressure	Bar	210
	流量 Flow	L/min	75
充气参数 Accumulators	高压氮气压力 High pressure nitrogen pressure	Bar	60
	缓冲氮气压力 Buffer nitrogen pressure	Bar	-
	回油氮气压力 Return oil nitrogen pressure	Bar	-
其他参数 Others	水压 Water pressure	Bar	10-15
	水流量 Water flow	L/min	30-60
	润滑气雾压力 Air lubrication pressure	Bar	3
	润滑气对应流量 Lubrication air flow	L/S	5

## 地下掘进工程案例 | Woserld rock drill for face drilling cases



### 硅石矿, 断面4.5×4米

凿岩台车配套沃思德A18D/L液压凿岩机, 岩石硬度F10, 孔深4米, 单孔平均用时2分钟。

Silica mine, with a cross-section of 4.5×4 meters, a face drilling rig equipped with WOSERLD A18D/L hydraulic rock drill is used. The rock hardness is rated at F10, and each hole, with a depth of 4 meters, takes an average of 2 minutes to drill.



### 地下抽水工程, 断面8米×7.5米

凿岩台车 配套沃思德A18D/L液压凿岩机, 岩石硬度 F7-F10, 孔深4米, 单孔平均用时2分30秒。

Underground water extraction project, with a cross-section of 8 meters × 7.5 meters, a face drilling rig is equipped with the WOSERLD A18D/L hydraulic rock drill. The rock hardness ranges from F7 to F10, and each hole, with a depth of 4 meters, takes an average of 2 minutes and 30 seconds to drill.



### 铜矿, 断面3.6×3.3米

矿用液压掘进台车 配套沃思德A18D/L液压凿岩机, 孔深3.3米, 单孔用时1分50秒。

Copper Mine, with a cross-section of 3.6 meters × 3.3 meters, a face drilling rig is equipped with the WOSERLD A18D/L hydraulic rock drill. Each hole, with a depth of 3.3 meters, takes an average of 1 minute and 50 seconds to drill.



### 金矿, 断面4×3.3米

采用凿岩台车 配套沃思德液压凿岩机、钻杆长4.3米, 单孔平均用时1分钟50秒。

Gold Mine, with a cross-section of 4 meters × 3.3 meters, a face drilling rig is equipped with the WOSERLD hydraulic rock drill and drill rods measuring 4.3 meters in length. Each hole, on average, takes 1 minute and 50 seconds to drill.



### 金矿, 断面3×3米

掘进钻车 配套沃思德A18D/L液压凿岩机, 孔深3.2米, 单孔平均用时1分钟20秒。

Gold Mine, with a cross-section of 3 meters × 3 meters, a face drilling rig is equipped with the WOSERLD A18D/L hydraulic rock drill. Each hole, with a depth of 3.2 meters, takes an average of 1 minute and 20 seconds to drill.

## 地下锚杆工程案例 | Woserld rock drill for bolting cases



### 银矿, 断面4×3.9米

矿用液压锚杆台车 配套沃思德自主研发W14B/D液压凿岩机, 岩石硬度F8-10, 孔深1.9米, 单孔平均用时1分20秒。

Silver Mine, with a cross-section of 4 meters × 3.9 meters, a bolting rig is equipped with the WOSERLD fully self-developed W14B/D hydraulic rock drill. The rock hardness ranges from F8 to F10, and each hole, with a depth of 1.9 meters, takes an average of 1 minute and 20 seconds to drill.



### 金属矿, 断面3.5×3.5米

矿山锚杆台车 配套沃思德液压凿岩机, 锚杆孔深1.9米, 单孔平均用时1分30秒。

Metal mine, with a cross-section of 3.5 meters × 3.5 meters, a bolting rig is equipped with the WOSERLD hydraulic rock drill. Each anchor hole, with a depth of 1.9 meters, takes an average of 1 minute and 30 seconds to drill.



### 铅锌矿, 断面3.5×4.2米

锚杆台车 配套沃思德M10B/D液压凿岩机, 锚杆长度2米, 单孔平均用时1分钟。

Lead-zinc mine, with a cross-section of 3.5 meters × 4.2 meters, a bolting rig is equipped with the WOSERLD M10B/D hydraulic rock drill. Each anchor hole, with a length of 2 meters, takes an average of 1 minute to drill.



### 金矿, 断面4.3×4.3米

锚杆台车 配套沃思德自主研发W14B/D液压凿岩机, 钻杆长度2.475米, 单孔平均用时45秒。

Gold Mine, with a cross-section of 4.3 meters × 4.3 meters, a bolting rig is equipped with the WOSERLD self-developed W14B/D hydraulic rock drill. Each drilling rod, with a length of 2.475 meters, takes an average of 45 seconds to complete a single hole.



### 银矿, 断面3.8×4.2米

锚杆台车 配套沃思德M8B/D液压凿岩机, 单岩层F6-8, 钻杆长2.6米, 一个班平均打120根锚杆

Silver mine, with a cross-section of 3.8×4.2 meters, a bolting rig is equipped with the WOSERLD M8B/D hydraulic rock drill. For a single rock layer with a hardness of F6-8, using drill rods that are 2.6 meters long, an average of 120 bolts are installed per shift.

## 中深孔采矿工程案例 | Woserld rock drill for long hole drilling cases



### 金矿, 断面3×2.8米

中深孔采矿台车, 配套沃思德A18D/L液压凿岩机, 3.5小时钻孔100米。

Gold Mine, with a cross-section of 3 meters × 2.8 meters, a long hole drilling rig is equipped with the WOSERLD A18D/L hydraulic rock drill. It drills 100 meters in 3.5 hours.



### 铜矿, 断面3.3×3.3米

中深孔扇形钻机采矿台车, 配套沃思德A22L/D凿岩机, 钻杆长0.915米, 单孔平均用时1分钟。

Copper Mine, with a cross-section of 3.3 meters × 3.3 meters, a long hole drilling rig is equipped with the WOSERLD A22L/D rock drill. Each drilling rod, with a length of 0.915 meters, takes an average of 1 minute to drill a single hole.



### 铁矿, 断面3.8×4米

中深孔采矿台车, 配套沃思德A25L液压凿岩机, 岩石硬度F12以上, 一个班可完成钻孔200米。

Iron Mine, with a cross-section of 3.8 meters × 4 meters, a long hole drilling rig is equipped with the WOSERLD A25L hydraulic rock drill. With rock hardness exceeding F12, it can drill 200 meters during one shift.



### 铁矿, 断面3.5×4米

中深孔采矿台车, 搭载沃思德凿岩机, 钻杆长1.2米, 孔径76mm, 一个班可打200米。

Iron Mine, with a cross-section of 3.5 meters × 4 meters, a long hole drilling rig is equipped with the WOSERLD rock drill, with drilling rods 1.2 meters long and a hole diameter of 76mm, can drill 200 meters during one shift.



### 铜矿, 断面3.6×3.3米

矿用液压采矿钻车 配套沃思德液压凿岩机, 孔深3.3米, 单孔用时1分50秒。

Copper Mine, with a cross-section of 3.6 meters × 3.3 meters, a long hole drilling rig is equipped with the WOSERLD hydraulic rock drill. Each hole, with a depth of 3.3 meters, takes an average of 1 minute and 50 seconds to drill.

## 国外配套案例 | Foreign supporting cases



### 沃思德A18D/L凿岩机的应用

安百拓K111凿岩台车, 配套沃思德A18D/L液压凿岩机。

The Epiroc K111 face drilling rig, equipped with the WOSERLD A18D/L Hydraulic Rock Drill.



### 沃思德S25D/L凿岩机的应用

山特维克DD210凿岩台车, 配套沃思德S25D/L液压凿岩机。

The Sandvik DD210 face drilling rig, equipped with the WOSERLD S25D/L hydraulic rock drill.



### 沃思德A25L凿岩机的应用

安百拓1354中深孔凿岩台车, 配套沃思德A25L液压凿岩机。

The Epiroc 1354 long hole drilling rig, equipped with the WOSERLD A25L hydraulic rock drill.



### 沃思德S20D/L凿岩机的应用

山特维克DD310凿岩台车, 配套沃思德S20D/L液压凿岩机, 孔深3.6米, 单孔平均用时1分30秒。

The Sandvik DD310 face drilling rig, equipped with the WOSERLD S20D/L Hydraulic Rock Drill, has a hole depth of 3.6 meters and an average single-hole drilling time of 1 minute and 30 seconds.



### 沃思德A18D+凿岩机的应用

安百拓281凿岩台车, 配套沃思德A18D+液压凿岩机, 孔深4米, 单孔平均用时1分50秒。

The Epiroc 281 face drilling rig, equipped with the WOSERLD A18D+ Hydraulic Rock Drill, has a hole depth of 4 meters and an average single-hole drilling time of 1 minute and 50 seconds.

## 专注品质 用心服务 | AFTER-SALE SERVICE

沃思德拥有一流的服务，一流的团队，无论何时何地，都竭诚为客户提供始终如一的优质服务，致力于成为您强大的合作伙伴。

WOSERLD has first-class service and a first-class team. We are committed to providing consistently high-quality service to our customers anytime and anywhere, striving to be your strong partner.



### 01 纯正配件 Genuine spare parts

沃思德纯正配件基于世界领先的生产平台制造，这一平台不仅包括技术先进的生产设备，还包括经验丰富的生产人员以及严格的品质管理要求。

配件设计规格有着相当精确的控制，不允许有任何误差。在配件的热处理工艺与材料方面，严格的工艺标准确保沃思德纯正配件达到设计规定的硬度、耐磨性以及疲劳强度，更好地匹配岩石开挖设备。优秀的品质可以有效降低零配件的损耗，为您的投资提供保障。

WOSERLD genuine parts are manufactured on a world-leading production platform, which includes not only technologically advanced production equipment but also experienced production personnel and strict quality management requirements. The design specifications of the parts are precisely controlled, allowing no errors. In terms of heat treatment processes and materials, strict process standards ensure that WOSERLD genuine parts achieve the designed hardness, wear resistance, and fatigue strength, making them better suited for rock excavation equipment. The excellent quality effectively reduces the wear and tear of spare parts, providing protection for your investment.

### 02 服务合约 Service contract

越精密的产品、技术含量越高的设备，对服务工作的要求也越高。为提高客户的生产效率，增加整机设备的使用寿命，沃思德为客户提供多种服务合约。根据不同的服务层级和每位客户的实际生产需要，现可提供：

The more precise the product and the higher the technical content of the equipment, the higher the requirements for service work. To improve customers' production efficiency and increase the lifespan of the entire equipment, WOSERLD offers various service contracts. Based on different service levels and the actual production needs of each customer, we can now provide:

 <p><b>凿岩机保养服务合约</b></p> <p>Rock drill maintenance service contract</p>	 <p><b>定期检查保养服务合约</b></p> <p>Scheduled inspection and maintenance service contract</p>	 <p><b>预防性维护服务合约</b></p> <p>Preventive maintenance service contract</p>	 <p><b>人员驻点服务合约</b></p> <p>On-site personnel service contract</p>
--	---	--	--

### 03 再制造服务 Remanufacturing service

沃思德再制造解决方案是将整机或总成件通过原始设备生产商 (OEM) 的再制造工艺，依据原始配件的尺寸、材料与技术参数进行再制造的过程。通过再制造后的设备或总成件将恢复其原始状态的优异效率与可靠性。沃思德在江西萍乡设立再制造中心，以世界级的技术和理念为客户提供高质量的再制造维修服务。

WOSERLD's remanufacturing solution involves the process of remanufacturing entire machines or assemblies using the original equipment manufacturer's (OEM) remanufacturing processes. This is done according to the original parts' dimensions, materials, and technical parameters. The remanufactured equipment or assemblies will restore their original state of superior efficiency and reliability. WOSERLD has established a remanufacturing center in Pingxiang, Jiangxi, to provide customers with high-quality remanufacturing and repair services using world-class technology and concepts.

## 04 培训课程

Training courses

沃思德可为客户提供设备维护保养、维修或故障诊断服务，从基础的设备结构进行简单检查与维护，到最后可以自行阅读各类图纸、调整技术参数并分析查找故障。培训课程将理论课程与实际操作相结合，通过在线课程或课堂授课讲述基础的操作理论知识，再结合现场实践操作演示，使客户掌握操作技能。

WOSERLD offers equipment maintenance, repair, and troubleshooting services to customers. This ranges from basic equipment inspections and maintenance to being able to read various diagrams, adjust technical parameters, and analyze and identify faults independently. The training courses combine theoretical lessons with practical operations. Basic operational theories are taught through online courses or classroom lectures, followed by hands-on practical demonstrations to help customers master operational skills.



## 05 定制技术改造方案

Customized technical upgrade solutions

沃思德在深入了解生产施工及工艺情况后，可为客户提供针对特殊需求量身定制的技术改造方案，从而让设备更加安全稳定，改善其性能并降低对环境的影响。

After a thorough assessment of production, construction, and process conditions, WOSERLD can provide customized technical modification solutions for special requirements, aimed at making the equipment safer and more stable, improving its performance, and reducing its environmental impact.



# THANK YOU FOR CHOOSING US

感谢关注沃思德

[www.woserld.com](http://www.woserld.com)