

# KINGSTONE

## KS1000

### MINI SKID STEER

DIMENSIONS (STD)	U.S.(in)	METRIC(mm)
A Operating height, max std. bucket	117in	2.98m
Overall length of machine, std. bucket	117in	2.98m
E Overall length of loader, no attachment	83.5in	2.12m
C Overall machine height	56in	1.42m
Machine weight (no attachment, fluids full)	2974lb	1350kg
Operating capacity		
35% tipping capacity	1000lb	454kg
Tipping capacity	2855lb	1298kg
B Hinge pin height, max	87in	2.21m
F Wheelbase/track length	46.5in	1.18m
O Track width, max	22in	0.56m
I Ground clearance, min	5.7in	145mm
J Angle of departure	33°	
P Overall width	36.7in	932mm
Q Total track width	36.2in	920mm
R Track width	7in	180mm

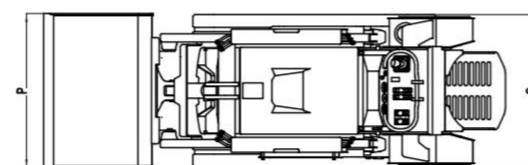
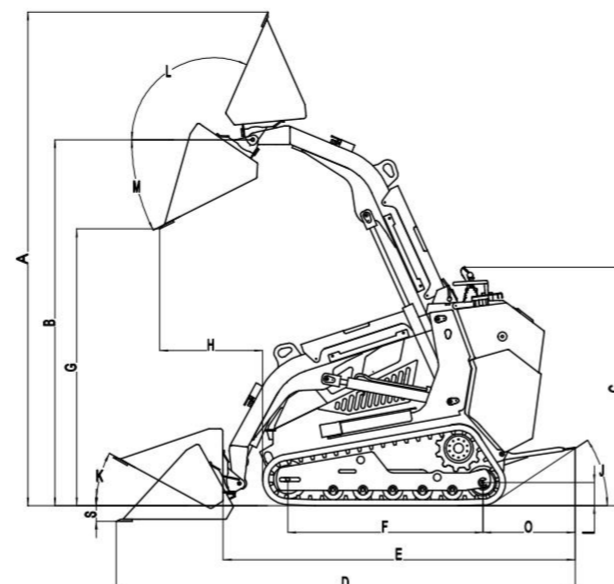

### POWER

Engine	Kubota D1105	
Fuel	Diesel	
Gross power rating	19 hp	14.2kW
Emissions compliance	EPA Tier 4	EU Stage V
Number of cylinders	3	
Displacement	68.53in <sup>3</sup>	1.123 L
Bore	3.07 in	78 mm
Stroke	3.09 in	78.4mm
Rated speed	2,200rpm	

### OPERATION

Ground drive speed		
Forward/averse	4mph	6.5km/h
Ground pressure (ISO/CD 16754)		
9-in(230-mm)tracks	4.5psi	0.31bar

### HYDRAULIC SYSTEM

Auxiliary circuit		
Gear pump		
Flow rate (pump #1)	8.4gpm	31.9/min
Pressure	3,190psi	220bar
Dual hydrostatic ground drive pumps		
Flowp rate	16.2gpm	61.6/min
Pressure	3,190psi	220bar

### FLUID CAPACITIES

Fuel tank capacity	10.5gal
Lubricating oil capacity	1.3gal
Hydraulic reservoir capacity	9.5gal

### BATTERY

SAE reserve capacity rating	110min
SAE cold crank @ 0°F (-18°C)	800amps
Electrical system	12V



### Kingstone America Corp

Address : 20181 South State Highway 78 Leonard, Texas 75452 USA  
 Hotline : 832-916-0665

Website : [www.kingstoneamerica.com](http://www.kingstoneamerica.com)  
 E-mail : [info@kingstoneamerica.com](mailto:info@kingstoneamerica.com)

We reserve the right to improve or withdraw the specification or products without prior notice.

[www.kingstoneamerica.com](http://www.kingstoneamerica.com)

