



无锡雪桃集团有限公司

地址：江苏省无锡市滨湖技术开发区大通路501号
电话：0510-85602710（内贸部）0510-85626785（外贸部）85625666（总机）
传真：0510-85627666（内贸部）0510-85607997（外贸部）
邮编：214134
网址：www.wxuetao.com
电子邮件：webmaster@wxuetao.com

WUXI XUETAO GROUP CO., LTD.

ADD: No. 501 Datong Road, Binhu Economic & Technical Development Zone, Wuxi, Jiangsu, China
TEL: +86 510 85602710 85626785 85625666
FAX: +86 510 85627666 85607997
P.C.: 214134
Http://www.wxuetao.com
E-mail: webmaster@wxuetao.com

无锡雪桃集团有限公司

WUXI XUETAO GROUP CO., LTD.

中国·无锡

董事长致词

Chairman's Speech



董事长：钱竹云
Chairman: Qian Zhuyun

【为客户及时提供优质的产品和服务】这是无锡雪桃集团得以茁壮成长，以至拥有今天璀璨成绩的基石。

今天，我们的产品已遍布国内市场、产品远销至海外很多国家。过去与客户一起成长，取得优良的成绩，令人欣慰。环视今日世界各地市场，时刻讲求成本竞争、优越品质、优质服务与顶尖科技，可是我们对客户却从不苛求，反而竭尽所能不断地提升与改善产品与服务，给予客户最大的支持，以协助他们面对这些挑战。

因此公司里主要的任务之一培育“绝对优质文化”。为了达到这个目标，我们力求为客户提供优质的产品、最快捷、最完美的服务，并决心成为高效与成功的企业楷模。过去认真的工作态度与才华横溢的员工使公司得以茁壮繁盛；而与我们一同勇往直前，风雨同舟的客户与供应商，亦功不可没！步入二十一世纪，公司员工决心把技术领先，品质卓越的雪桃产品奉献给世界上每一个选购雪桃产品的客户。雪桃集团欢迎世界各国朋友的光临！

我们坚信我们的事业将迎来一个新的发展时期，为此我们将努力把握这千载难逢的发展机遇，积极迎接更激烈的竞争和挑战。我们已经拥有了现在，我们也一定能把握住未来！

无锡雪桃 以心换信

Providing our customers with high quality products and service is the cornerstone of WUXI XUETAO GROUP, which makes our company grow up steadily and achieve excellent results.

Now our products have won customers all over the country and have been sold to countries and regions overseas.

In the past, we grew up with our customers and made great achievements which were gratified and inspiring. Now the markets at home and abroad are filled with cost competition, quality products, excellent service and top science and technology. Even so, we are devoting ourselves to improving and perfecting the products and services to support our customer to win over challenge.

Therefore, one of the main tasks of our company is to develop “Absolute Quality Culture”. In order to achieve this target, we are making great efforts to provide our customers with quality products, quick and perfect service to become the model enterprise of high efficiency and success.

All the achievements we made are attributed not only to our talented employees, but also to our customers and suppliers. In the 21st century, we will present our products with advanced technology and good quality to customers all over the world. We welcome friends all over the world to visit our company.

We believe that our business will enter into a new development period. We will make every effort to seize the opportunities and meet the fierce competitions and challenges. We will create a bright future.



公司简介

Company Introduction

- 1、1987年公司成立，现在拥有二个占地约100000平方米的生产基地。
Our company was established in 1987. And now we have two production bases of 100000 square meters.
- 2、2000年与长安大学工程机械学院成立路面机械研究开发中心。
We established the Road Machinery Center with Chang-an University Engineering Machinery Institute in 2000.
- 3、2008年江苏省科技厅批准成立路面废旧沥青混合料热再生装备工程技术中心。
Science and Technology Department of Jiangsu Province approved us to establish Asphalt Reclaimed Equipment Technology Center in 2008.
- 4、2010年获得沥青搅拌设备国家职业技能（无锡点）培训资质。
We acquired the National Vocational Skills Training (Wuxi) Qualification of Asphalt Mixing Plant in 2010.
- 5、《强制间歇式沥青混合料搅拌设备》、《沥青混合料厂拌热再生设备》及《导热油加热沥青设备技术要求》国家行业标准起草单位。
One of the drafting units of national industrial standards of “Batch type asphalt mixing plant”, “Auxiliary stationary RAP recycling plant” and “Requirements for asphalt heat-transfer oil melter”.
- 6、《室内沥青混合料生产线》国家行业标准主要起草单位。
Main drafting unit of national industrial standard “Production line of asphalt mixture in factory building”.
- 7、3C、CE、ISO9000认证单位。
3C, CE, ISO9000 certification unit.



公司综合资信：The comprehensive enterprise credit



企业文化

Enterprise culture



团结 雪桃人战胜困难的力量之源

SOLIDARITY The power source for XUETAO MEMBERS to conquer difficulties

敬业 雪桃人完善自我的职业精神

ASSIDUITY The occupational spirit for XUETAO MEMBERS to consummate themselves

求精 雪桃人科学发展的永恒主题

Perfection The eternal topic XUETAO MEMBERS to develop scientifically

创新 雪桃人超越一流的希望之翼

INNOVATION The hopeful wing for XUETAO MEMBERS to surpass the first grade

无锡雪桃

以心换信

合作与交流

Cooperation and Communication



雪桃管理的提升与技术的进步也非常得益于研制机构以及国际一流企业的相互交流，通过交流将国内外先进的管理理念和技术融合到雪桃公司的实践中去。

The improvement of Xuetao's management and technology also benefit a lot from the mutual exchange and studying with top international enterprises, through such communication, the advanced foreign management conception and technology will be fused into the practice of Xuetao.

AMP5000-C型沥青混凝土搅拌站

AMP5000-C type Asphalt Mixing Plant



目前国内已在高速公路上成功使用的最大产量的沥青搅拌站，每小时最大产量可达到400吨，对大标段高速公路的施工拥有很大的优势。

At present, the AMP5000-C type asphalt mixing plant has been used steadily with the max. capacity of 400t/h. It has advantages on the large section of highway construction.

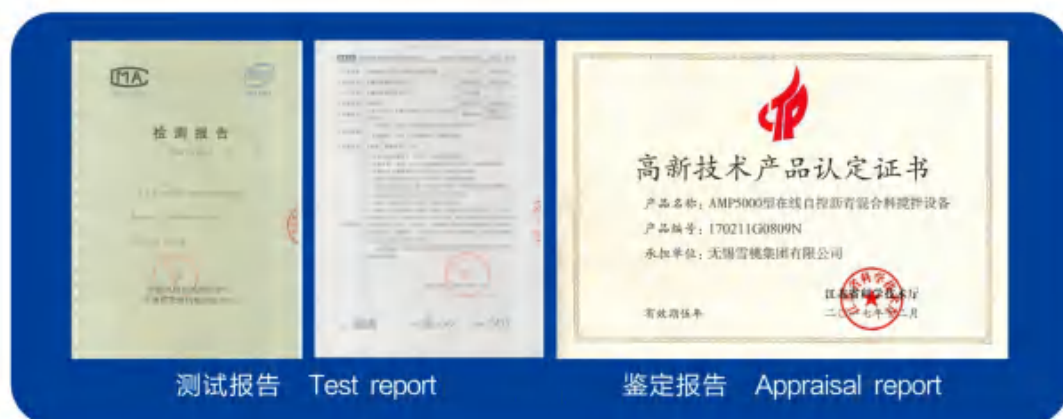

测试报告 Test report

鉴定报告 Appraisal report

AMP4000-C型沥青混凝土搅拌站

AMP4000-C type Asphalt Mixing Plant



拥有令人难以置信的生产能力，每小时最大产量可达到320吨，它可以供应二台9m摊铺机同时施工。

The max. capacity can reach 320t/h. It can meet the construction requirements of two pavers of 9m each simultaneously.

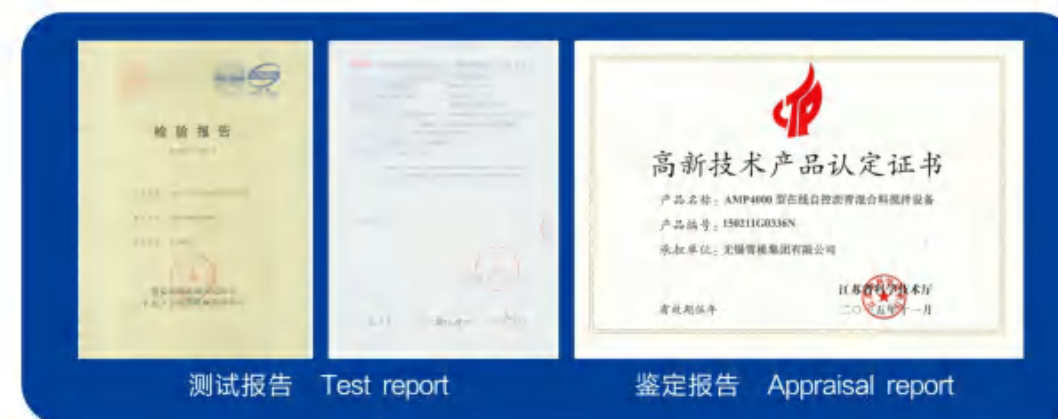

测试报告 Test report

鉴定报告 Appraisal report

AMP3000-C型沥青混凝土搅拌站

AMP3000-C type Asphalt Mixing Plant



每小时最大产量可达到240吨，就像一座移动的沥青混凝土工厂，它是进行大规模施工的可靠保证。

The max. capacity can reach 240t/h. It looks like a big movable asphalt mill. It can be used reliably for large-scale construction.

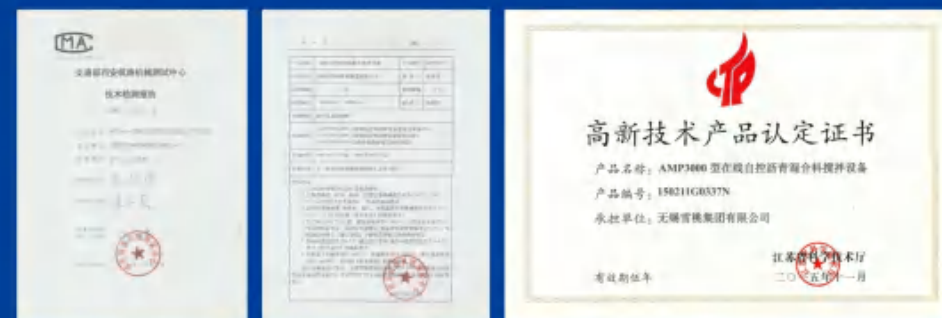

测试报告 Test report

鉴定报告 Appraisal report

AMP2000-C型沥青混凝土搅拌站

AMP2000-C type Asphalt Mixing Plant



每小时产量最大为160吨，完全能满足一般性公路的施工，而且移动方便，物美价廉，无疑是施工单位的首选产品。

With capacity of 160t/h, the AMP2000-C type asphalt mixing plant can completely meet the requirements of general road construction. It is of good quality and reasonable price, which is the best choice for customers.

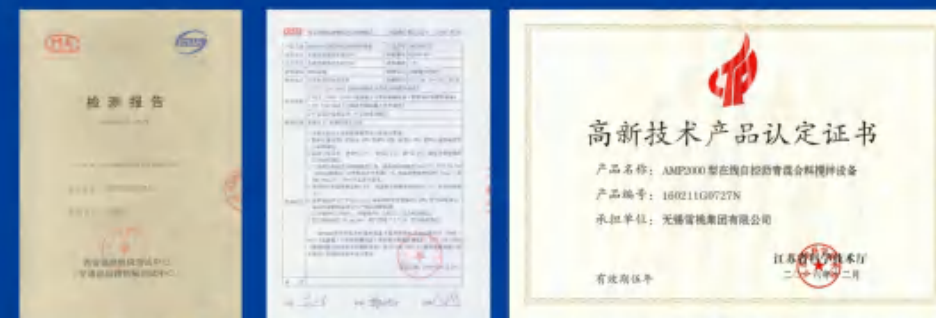

测试报告 Test report

鉴定报告 Appraisal report

AMP1500型、1000型、700型沥青混凝土搅拌站

AMP1500, AMP1000 and AMP700 type Asphalt Mixing Plant



每小时产量分别为120吨、80吨、40吨的中小型沥青混凝土搅拌站，不仅转场灵活方便，价格便宜，该产品会让你得到意想不到的收获。

The capacity is 120t/h, 80t/h, 40t/h separately. These medium-small size asphalt mixing plants are of easy installation, move and competitive price.



测试报告 Test report



鉴定报告 Appraisal report

AMP系列沥青混凝土搅拌站控制系统

Control room of asphalt mixing plant



在满足用户生产的各个功能要求的同时，我们充分考虑到了人机有效结合的这个理念，使操作人员工作时更轻松，并且把操作室一分为二，有效的降低了大功率电器件对人体的伤害。

We consider not only the functions, but also the idea of man-machine effective combination. Separate the strong control cabinets from operation desk, it makes working environment less harmful, more comfortable.

沥青混凝土搅拌站 远程服务系统

Remote service system



我公司建成了沥青混凝土搅拌站远程服务系统，该系统是通过互联网，把数据及图像实时传输给我公司的平台，让我们技术人员在公司就可以实时了解搅拌站的生产现场情况，并与操作人员面对面直接交流，及时帮助客户解决搅拌站的问题，既便捷又经济。该系统是目前我国沥青混凝土搅拌站第一套远程服务平台。

In order to service our customers faster and better, we developed the remote service system. Through internet, the production data and image of plant can be transported to our company. After authorized by the user, our technical staff can know the real working situations of the jobsite. So they can communicate with the operator face to face by the internet, help and guide them to solve the problems instantly. It's proved that this service system is reliable and effective.

AMP系列沥青混凝土搅拌站技术参数表

Main technical parameters of AMP Series Asphalt Mixing Plants

内容 Contents	型号 Type	AMP500-E	AMP700-B	AMP1000-E	AMP1000-C	AMP1500-C	AMP2000-C	AMP2500-C	AMP3000-C	AMP3500-C	AMP4000-C	AMP5000-C
额定生产率(t/h) Rated output		40	50	80	80	120	160	200	240	280	320	400
拌缸容量(kg/batch) Mixer capacity		500	700	1000	1000	1500	2000	2800	3000	4000	4000	5000
总装机容量(不含成品仓)(kw) Installed capacity (without product storage silo)		120	161	175	280	330	430	494	628	708	820	991
总占地面积(m ²) Total area		28×25=700	30×25=750	35×30=1050	35×30=1050	40×34=1360	45×36=1620	40×40=1600	60×40=2400	60×40=2400	60×40=2400	68×40=2720
燃油消耗率(kg/t) Oil consumption		≤6.2										
燃料种类 Fuel variety		柴油、重油、天然气 Diesel oil, heavy oil, gas										
成品料温度(℃) Product Temp.		130-160										
骨料累积计量精度(%) Agg. accumulated weighing accuracy		±0.33										
沥青材料计量精度(%) Bitumen weighing accuracy		±0.18										
粉料计量精度(%) Filler weighing accuracy		±0.22										
油石比偏差(%) Deviation of Agg. and bitumen		≤±0.5				≤±0.3						
出料温度稳定精度(℃) Product Temp. accuracy		±5										
环境噪声[dB(A)] Environment noise		≤85										
操作人员耳边噪声[dB(A)] Operation room noise		≤80				≤70						
除尘方式 Dust collection		文丘里湿式 Venturi wet				分室、高压脉冲袋式 High pressure pulse bag filter						
粉尘排放浓度[mg/Nm ³] Smoke emission concentration		≤200				≤75 (增加湿式除尘with wet dust collection≤50)						

技术参数如有变动, 请以技术规格书为准。
Any Changes, please refer to our technical specifications.

标准AMP系列沥青混凝土搅拌站图解

Diagram of the standard AMP Series of Asphalt Mixing Plants

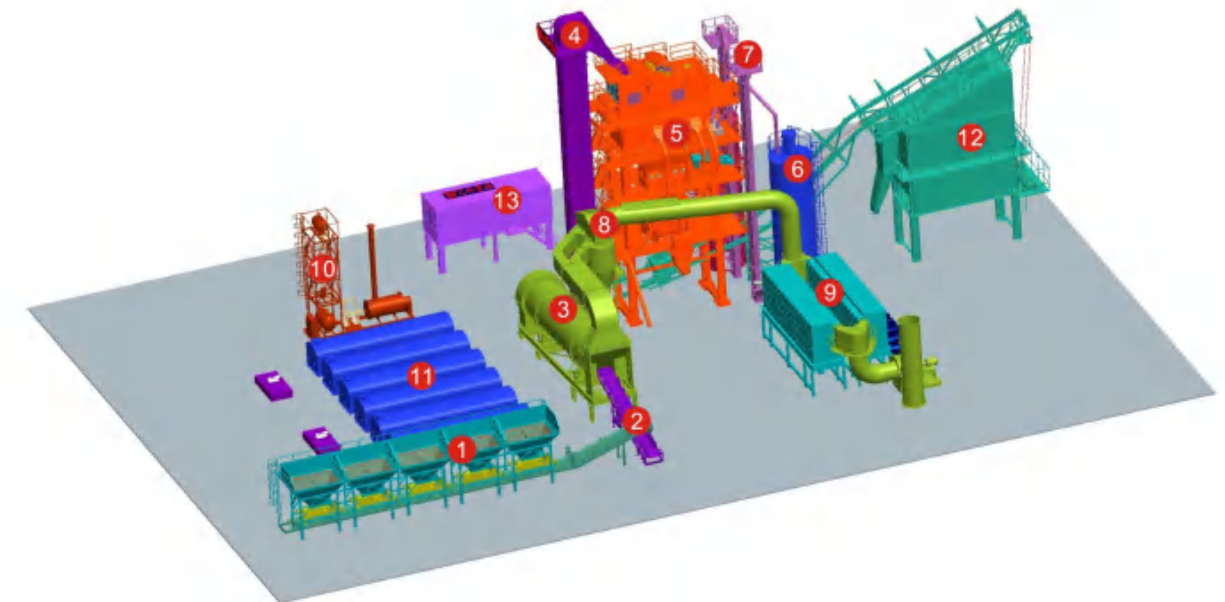

- | | |
|-----------|-------------------------------------|
| 1. 冷料斗 | COLD FEED HOPPER |
| 2. 输送带 | CONVEYER |
| 3. 烘干筒 | DRYER DRUM |
| 4. 热骨料提升机 | HOT MATERIAL ELEVATOR |
| 5. 主机架 | MIXING TOWER |
| 6. 粉仓 | FILLER SILO |
| 7. 粉料提升机 | FILLER ELEVATOR |
| 8. 一级除尘 | PRIMARY DUST COLLECTOR |
| 9. 二级布袋除尘 | SECONDARY BAG FILTER DUST COLLECTOR |
| 10. 加热炉 | OIL HEATER |
| 11. 沥青罐 | BITUMEN TANK |
| 12. 成品仓 | FINISHED MATERIAL STORAGE SILO |
| 13. 操作室 | CONTROL ROOM |

MAMP系列移动式沥青搅拌站技术参数表

Main technical parameters of MAPM Series Mobile Asphalt Mixing Plant

参数 Specification	型号 Model			
	MAMP50	MAMP80	MAMP100	MAMP140
额定生产量 Rated output(t/h)	50	80	100	140
拌缸容量 Mixer capacity(kg/batch)	700	1000	1500	1800
总装机容量 Installed capacity(kw)	236	270	319	367
燃油消耗率 Oil consumption(kg/t)	≤6.5			
燃料种类 Fuel variety	柴油、重油 Diesel oil , heavy oil			
成品料温度 Product Temp.(°C)	130-160			
矿料计量精度 Agg. weighing accuracy	±0.3%	±0.3%	±0.3%	±0.3%
沥青材料计量精度 Bitumen weighing accuracy	±0.2%	±0.2%	±0.2%	±0.2%
粉料计量精度 Filler weighing accuracy	±0.2%	±0.2%	±0.2%	±0.2%
油石比偏差 Deviation of Agg. and bitumen	≤ ±0.5%			
出料温度稳定精度 Product Temp. accuracy	±5			
环境噪声 Environment noise[dB(A)]	≤80			
除尘方式 Dust collection	一级除尘：重力式 Primary dust collection:gravity type 二级除尘：袋式除尘 Second dust collection:bag filter			
粉尘排放浓度 Smoke emission concentration[mg/Nm ³]	≤73.1			
拖车底盘 Semi-trailer	4 (包括冷料供给系统、骨料烘干系统、粉仓、除尘系统) Including:cold Feed System,Aggregate Dry System,Filler Bin,Dust Collection System		5 (包括冷料供给系统、骨料烘干系统、粉仓、除尘系统/2 辆) Including:cold Feed System,Aggregate Dry System,Filler Bin,Dust Collection System(two semi-trailers)	
	7 (包括冷料供给系统、骨料烘干系统、粉仓、除尘系统、沥青罐、导热炉、控制室) Including:cold Feed System,Aggregate Dry System,Filler Bin,Dust Collection System,Bitumen Tank,Oil Heater,Control room)		8 (包括冷料供给系统、骨料烘干系统、粉仓、除尘系统/(2 辆) 沥青罐导热油炉、控制室) Including:cold Feed System,Aggregate Dry System,Filler Bin,Dust Collection System(two semi-trailers), Bitumen Tank,Oil Heater,Control room	

技术参数如有变动，请以技术规格书为准。
Any Changes, please refer to our technical specifications.

MAMP系列移动式沥青搅拌站

MAMP Series of Mobile Asphalt Mixing Plant



我们充分吸收了站式沥青搅拌站以及全移动式沥青搅拌站的优点，把设备的使用性能以及快速便捷的搬运方式有机的统一起来。

We have absorbed advantages both of the batch type and mobile type asphalt mixing plants and reasonably combined the characteristics of stable performance and easy-moving.

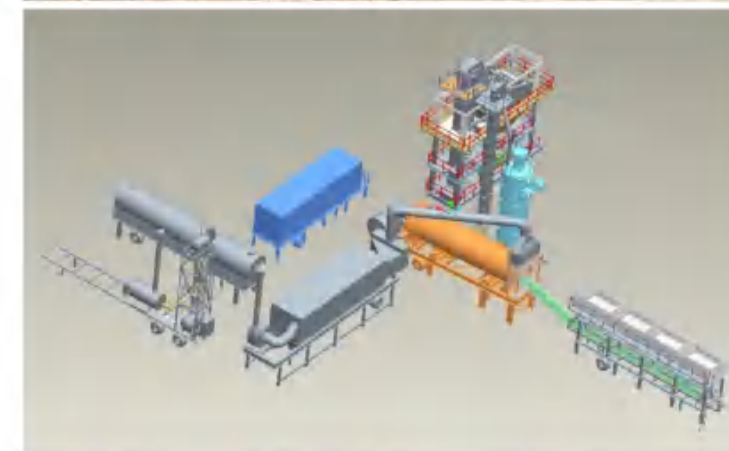

IH·AMP系列室内环保型沥青混合料生产线

IH·AMP Series In-door Asphalt Mixing Plant



经过公司多年来不断研究与改进，室内环保型沥青混合料生产线已成功问世。这种设备完全颠覆了传统沥青混凝土搅拌站的概念！它可以几乎与外界隔绝粉尘、噪音及气味，对周围环境的影响很小，适用于城乡结合部，工业园区等地方。目前，该设备已在多个地方成功试用，效果良好，并且已通过国家权威机构的检测。

After many years' research and improvement, we developed IH-AMP series In-door Asphalt Mixing Plant. It's a completely new concept from the traditional asphalt mixing plant. The whole plant will be installed in a factory. It can isolate dust, noise and odour from environment. So it is the best choice for those areas with high requests of environment protection. Until now, it has been successfully used in many places and got very high appreciations for it's stable performance and advanced environment idea.

IH·AMP系列**室内**环保型沥青混合料生产线

还您一个**不受限制**的施工环境！

IH·AMP Series In-door Asphalt Mixing Plant makes your construction unrestricted!

IH·AMP系列室内环保型沥青混合料生产线参数表

Main technical parameters of IH·AMP series In-door Asphalt Mixing Plant

型号 Model	IH-AMP50	IH-AMP80	IH-AMP120	IH-AMP160	IH-AMP180	IH-AMP200	IH-AMP240	IH-AMP260	IH-AMP280	IH-AMP320	IH-AMP340	IH-AMP380
内容 Contents												
最大生产率(t/h) Max. capacity	50	80	120	160	180	200	240	260	280	320	340	380
拌缸容量(kg/batch) Mixer capacity	1000	1500	2000	2800	3000	3300	4000	4300	4800	5000	5000	6000
设备高度(m) Height	≤14.5		≤15.8						≤16.8			
燃油消耗率(kg/t) Oil consumption	≤6.5											
燃油种类 Fuel variety	柴油、重油、天然气 Diesel oil, heavy oil, gas											
成品料温度(°C) Product Temp.	130-160											
骨料累计计量精度(%) Agg. accumulated weighing accuracy	±0.33%											
沥青计量精度(%) Bitumen weighing accuracy	±0.18%											
粉料计量精度(%) Filler weighing accuracy	±0.22%											
油石比偏差(%) Deviation of AGG. and bitumen	±0.3%											
出料温度稳定精度(°C) Product Temp. accuracy	±5											
操作工位噪声[dB(A)] Operation room noise	<70											
环境噪声 厂界7m处[dB(A)] Noise ≤7m	<85											
环境噪声 厂界30m处[dB(A)] Noise ≤30m	<70											
环境噪声 厂界50m处[dB(A)] Noise ≤50m	<68											
烟气黑度(级) Blackness of exhaustion	≤1											
烟尘排放浓度(mg/Nm³) Smoke emission concentration	≤50											
飘尘排放浓度(车间外)(mg/Nm³) Dust emission concentration (outdoor)	≤5.0											
CO₂含量(%) CO₂ content	≤30											
CO含量(ppm) CO content	≤450											
SO₂含量(mg/m³) SO₂ content	≤20											
NOₓ含量(mg/m³) NOₓ content	≤70											

技术参数如有变动，请以技术规格书为准。
Any Changes, please refer to our technical specifications.

PRD系列沥青热再生搅拌设备

PRD Series Asphalt Hot Recycled Mixing Plant



在2003年我们公司在国内率先研制出沥青热再生搅拌设备，与上海路用材料研究所合作，在上海进行试生产，并取得了成功。

现在我们公司生产的PRD系列沥青热再生搅拌设备有500型、1000型、1500型、2000型四种。它们既可以和用户原有购置的相同产量的搅拌设备配套使用，又可以单独使用，取得了良好的经济和社会效率。

Early in 2003, we developed the asphalt hot mixing plant. Cooperation with Shanghai Road Material Institute, we successfully made the trial production.

Now, we have four popular models: PRD500, PRD1000, PRD1500 and PRD2000. They can be used not only with corresponding asphalt mixing plant, but also alone. It has very good economic and social benefits.

PRD沥青热再生技术参数表

Main technical parameters of PRD Series Asphalt Hot Recycled Mixing Plant

内容Contents	型号Type	PRD500	PRD1000	PRD1500	PRD2000
总装机容量 (kw) Installed capacity		50	85	116	155
产量 (t/h) Rated output		30-40	60-80	90-120	120-160
旧料最多添加量 Old material max. adding amount		≤50%	≤50%	≤50%	≤50%
主机占地面积 (长×宽) (m ²) Total area(L×W)		9×3.5	10×3.5	12×3.5	14×3.5
燃油消耗率 Oil consumption		≤7kg			
燃料种类 Fuel variety		柴油/重油 Diesel oil / Heavy oil			
温度控制 Temperature control		±3℃			

技术参数如有变动，请以技术规格书为准。
Any Changes, please refer to our technical specifications.

工艺流程图

Technical Process Diagram

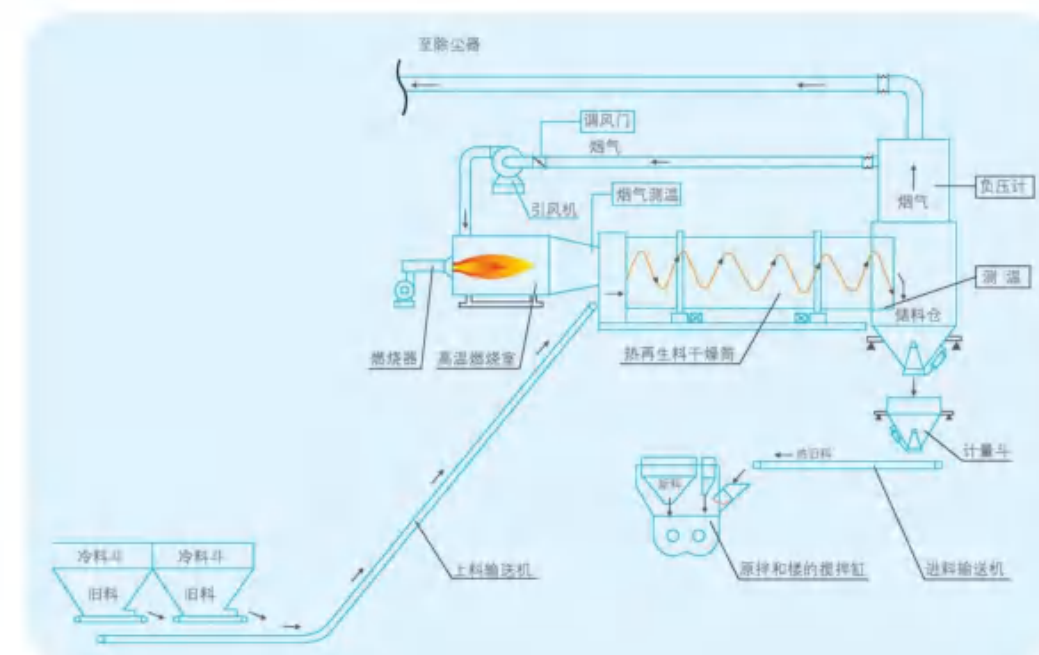

稳定土厂拌设备

Stabilized Soil Mixing Plant

SWCB系列稳定土厂拌设备
使用于高速公路的施工，采用计算机控制，皮带称与计算机的连接，实行全自动配料，使计量非常精确。

Belt scale connected with computer, it is fully automatic control. The measuring is highly accurate and the plant is very good performance. It's a good choice for highway constructions.



SWCB系列稳定土厂拌设备
SWCB Series Stabilized Soil Mixing Plant



WCB系列稳定土厂拌设备
WCB Stabilized Soil Mixing Plant

WCB系列稳定土厂拌设备
适用于一般高等级公路的施工，它具有产量高，维修简单，价格低廉等优点。

High productivity, easy maintenance and competitive price, it's suitable for normal highway constructions.

稳定土厂拌设备参数

Main technical parameters of Stabilized Soil Mixing Plant

型号Type	WCB200	WCB300	WCB400	WCB500
	SWCB200	SWCB300	SWCB400	SWCB500
产量Out put(t/h)	150-200	250-300	350-400	450-500
功率Power(kw)	84	91	115	130

技术参数如有变动，请以技术规格书为准。
Any Changes, please refer to our technical specifications.

SMP系列淤泥搅拌设备

SMP Series Silt Mixing Plant



淤泥由于其特有的性质一直无法搅拌均匀，这对于要利用淤泥的用户来说一直是个长期得不到解决的难题。我们凭借长期从事沥青搅拌站的经验，针对淤泥的特性，设计出了SMP系列淤泥搅拌设备，它完全能满足各种需求。

Silt has been unable to be stirred well because of its peculiar properties. It has been a long-term problem that bothers all silt users. Now, our Silt Mixing Plant can solve this problem once and for all.

淤泥搅拌设备参数

Main technical parameters of Silt Mixing Plant

型号Type	SMP-40	SMP-60	SMP-80	SMP-120
额定生产率Rated output(t/h)	40	60	80	120

技术参数如有变动，请以技术规格书为准。
Any Changes, please refer to our technical specifications.

乳化沥青设备

Emulsifying Bitumen Machine



乳化沥青示意图

Sketch of Emulsifying Bitumen Machine



乳化沥青设备工艺流程

Technical Process Diagram

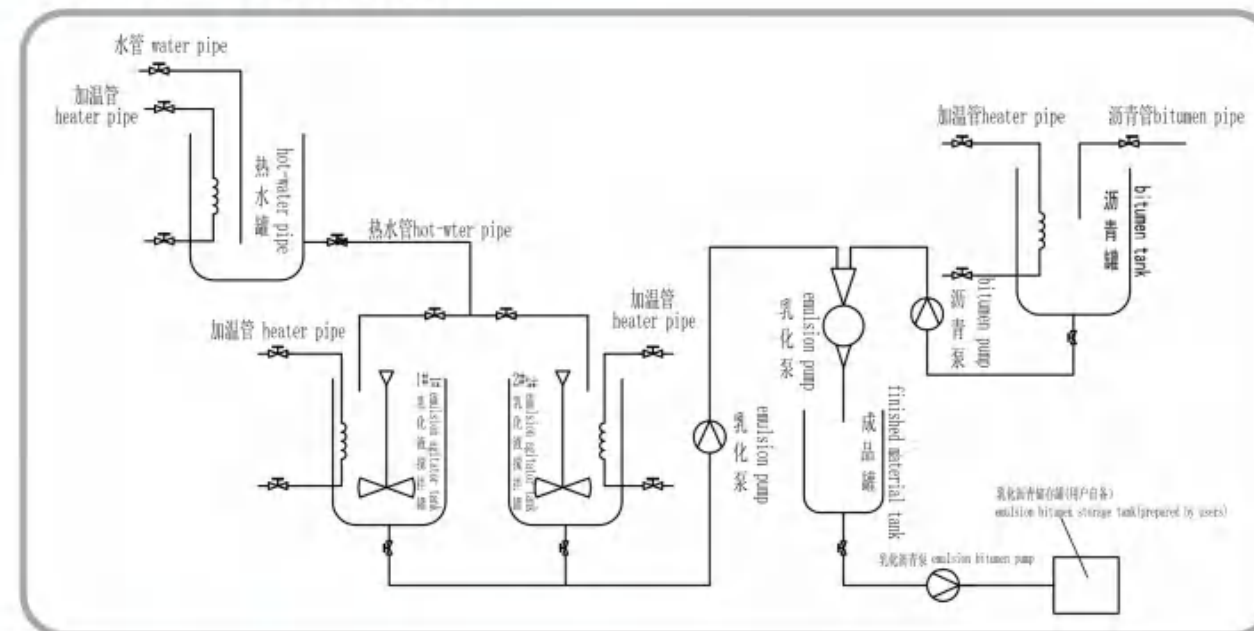

乳化沥青设备参数表

Main technical parameters of Emulsifying Bitumen Machine

序号 No.	名称 Name	型号/技术/外形尺寸 Model/Specification/Dimension	备注 Remarks
1	设备型号 Model	LRS-6	
2	设备产量 Rated productivity	1-6t/h	
3	主框架 Main frame	L × W × H=7900 × 2000 × 2200mm	
4	热水罐 Hot-water tank	容量 Capacity	4.0m ³
		外形 Dimension	L × W × H=1800 × 2000 × 2200mm
5	乳化液搅拌罐 Emulsion agitator	容量 Capacity	3.8m ³
		外形 Dimension	L × W × H=1600 × 2000 × 1800mm
6	沥青罐 Bitumen tank	容量 Capacity	4.5m ³
		外形 Dimension	L × W × H=1900 × 2000 × 2000mm
7	成品罐 Finished material tank	容量 Capacity	1.5m ³
		外形 Dimension	L × W × H=1600 × 1000 × 1000mm
8	沥青泵 Bitumen pump	型号 Model	LCB-3A
		电机 Motor	Y160M-4-3KW
		流量 Flow	3t/h
9	乳化液泵 Emulsion pump	型号 Model	LCB-3B
		电机 Motor	Y160M-4-3KW
		流量 Flow	3t/h
10	乳化机 Emulsifying machine	型号 Model	RH-6
		电机 Motor	Y180M2-2-22KW
		流量 Flow	6t/h
11	成品输送泵 Finished material conveying pump	型号 Model	3QGB60X2-46
		电机 Motor	Y132M164KW
12	控制电柜 Electric control cabinet	流量 Flow	9.8m ³ /h
		外形 Dimension	L × W × H=700 × 450 × 1500mm

技术参数如有变动, 请以技术规格书为准。
Any Changes, please refer to our technical specifications.

移动式加热炉

Removable Thermal Oil Heater



型号 Type	装机容量 Power(kw)	运输尺寸(最大件) Shipping Size (Max.) (mm)
YYW-180Y	8	6600 × 1950 × 2530
YYW-350Y	12	7200 × 1950 × 2550
YYW-580Y	18	7900 × 1950 × 2250
YYW-820Y	27	8100 × 2230 × 2600
YYW-940Y	28	8500 × 2230 × 2600
YYW-1200Y	36	9000 × 2230 × 2600
YYW-1400Y	38	9300 × 2230 × 2600

技术参数如有变动, 请以技术规格书为准。
Any Changes, please refer to our technical specifications.

采用架式结构, 移动方便, 采用进口全自动燃烧器, 温度与燃烧器实行连锁, 操作方便。
Using frame structure, it's convenient for installation and moving. With an imported full-automatic burner, which is interlocked with temperature, it's easy for operation.

桶装沥青脱桶融化设备

Drummed Bitumen Melting Equipment



上下箱体结构, 运输方便。散热面积布置合理。升温迅速, 具有特殊的除渣功能, 操作方便, 保养方便。



Unique designed as upper and lower cabinets, easy installation and moving. Reasonable layout of heating coils makes temperature increase fast. It has special slag discharge function, simple operation and easy maintenance.

技术参数 Technical 型号 Type	产量 Output t/h	功率 Power kw	脱桶容积 Debarrelling volume m³	贮存容积 Storage volume m³	送桶速度 Speed for feeding barrel min/次	推力 Thrust t	散热面积 Area of heat dissipation m²	介质温度 Medium temperature ℃	外形尺寸 Dimensions m	重量 Weight t
QX.YRL.TD-10	2.5	3	8	10	1.5	4	80	240	11.5×2.6×4.9	12
QX.YRL.TD-20	5	5	19	20	1.5	4	115	240	12×3.5×5.6	18.5
QX.YRL.TD-30	7.5	8	25	27	1.5	6	153	240	14×5.6×5.8	23
QX.YRL.TD-40	10	15	35	36	1.5	6	200	240	16×5.6×5.8	30

技术参数如有变动, 请以技术规格书为准。
Any Changes, please refer to our technical specifications.

各种沥青罐

Bitumen Storage Tanks



沥青搅拌罐
Bitumen Agitator Tank



块装沥青投料罐
Bitumen Feeding Tank



沥青高温罐
Bitumen Storage Tank



集装箱式运输罐
Container type Bitumen Tank

沥青罐技术参数

Main technical parameters of Bitumen Tanks

名称 name	规格 (m³) Size									
沥青高温罐 bitumen storage tank	6	8	10	12	15	20	30	40	50	
集装箱式运输(加热)罐 container type bitumen tank	/	/	/	/	/	20	/	40	/	
沥青投料罐 bitumen feeding tank	3	6	8	10	15	20	30	/	/	
沥青搅拌罐 bitumen agitator tank	3	6	8	10	15	20	30	40	50	

技术参数如有变动, 请以技术规格书为准。
Any Changes, please refer to our technical specifications.

大型沥青罐贮存库

Large-scale Bitumen Storage Tank

采用导热油加热方式，具有加热速度快，沥青温度容易控制，自动化程度高，环境污染小，节能效果好等优点。我公司积累了建造大型沥青库丰富经验，能够根据用户的要求进行设计和施工。

Flexible design satisfies different requirements. With thermal oil heating system, it has advantages of quick-heating, temperature easy control, automatically operation, environment friendly and energy saving.



火车装油平台
Railway bitumen loading platform

火车卸油平台
Railway bitumen unloading platform

汽车卸油平台
Tank-trucks bitumen loading platform

沥青库管线系统
System pipelines



沥青库

Large-scale Bitumen Storage Tank

立式沥青贮存罐技术参数表

Main Technical Parameters of Large-scale Bitumen Storage Tank

容量 Capacity	直径 Diameter(mm)	高度 Height(mm)	加热面积 Heating area(m ²)	加热方式 Heating style	制作形式 Production form
100T	φ 5200	5180	39.7	整体加热 Entire heating	罐体搭接、加热管 5 层 Tank body weided,5-layer coil
150T	φ 5200	7400	39.7	整体加热 Entire heating	罐体搭接、加热管 5 层 Tank body weided,5-layer coil
200T	φ 6900	5930	56.0	整体加热 Entire heating	罐体搭接、加热管 4 层 Tank body weided,4-layer coil
300T	φ 7562	7400	75.6	分层加热 Layered heating	罐体搭接、加热管 4 层 Tank body weided,4-layer coil
300T	φ 7562	7400	76.0	整体加热 Entire heating	罐体搭接、加热管 4 层 Tank body weided,4-layer coil
500T	φ 9460	7400	193.9	分层加热 Layered heating	罐体搭接、加热管 6 层 Tank body weided,6-layer coil
500T	φ 9460	7400	124.9	整体加热 Entire heating	罐体搭接、加热管 4 层 Tank body weided,4-layer coil
800T	φ 10500	9780	145.9	整体加热 Entire heating	罐体搭接、加热管 4 层 Tank body weided,4-layer coil
1000T	φ 11462	10350	180.6	分层加热 Layered heating	罐体搭接、加热管 4 层 Tank body weided,4-layer coil
1000T	φ 11462	10350	168.0	整体加热 Entire heating	罐体搭接、加热管 4 层 Tank body weided,4-layer coil
2000T	φ 15780	11430	374.0	分层加热 Layered heating	罐体搭接、加热管 5 层 Tank body weided,5-layer coil
2000T	φ 15780	11430	395.0	整体加热 Entire heating	罐体搭接、加热管 5 层 Tank body weided,5-layer coil
3000T	φ 18900	11620	527.0	分层加热 Layered heating	罐体搭接、加热管 5 层 Tank body weided,5-layer coil

技术参数如有变动，请以技术规格书为准。
Any Changes, please refer to our technical specifications.

工程业绩

Achievement of partial projects

无锡雪桃 以心换信



AMP4000-PRD2000沥青热再生搅拌站江苏苏州
AMP4000-PRD2000 asphalt hot recycle mixing plant
used in Suzhou, Jiangsu Province



AMP4000-PRD2000沥青热再生搅拌站江苏兴化
AMP4000-PRD2000 asphalt hot recycle mixing plant
used in Xinghua, Jiangsu Province



中铁十四局购买的AMP5000型搅拌站用于福建福泉高速
AMP5000 model asphalt mixing plant
used in Fujian-Fuquan expressway



AMP4000型沥青搅拌站内蒙古包头
AMP4000 model asphalt mixing plant
used in Baotou, Inner Mongolia



AMP3000-PRD1500沥青热再生搅拌站江苏苏州
AMP3000-PRD1500 asphalt hot recycle mixing plant
used in Suzhou, Jiangsu Province



AMP3000-PRD1500沥青热再生搅拌站江苏无锡
AMP3000-PRD1500 asphalt hot recycle mixing plant
used in Wuxi, Jiangsu Province



AMP3000型沥青搅拌站江西
AMP3000 model asphalt mixing plant
used in Jiangxi Province



AMP5000型沥青搅拌站内蒙古包头
AMP5000 model asphalt mixing plant
used in Baotou, Inner Mongolia



AMP2000-PRD1000沥青热再生搅拌站山东莱州
AMP2000-PRD1000 asphalt hot recycle mixing plant
used in Laizhou, Shandong Province



AMP3000-PRD1000沥青热再生搅拌站江苏淮安
AMP3000-PRD1000 asphalt hot recycle mixing plant
used in Huai'an, Jiangsu Province



AMP4000型沥青搅拌站山东青岛
AMP4000 model asphalt mixing plant
used in Qiangdao, Shandong Province



中铁十九局三处购买的AMP5000型搅拌站用于辽宁皮炮旺南高速
AMP5000 model asphalt mixing plant
used in Liaoning Pipo-Wangnan expressway