



**SPECIFICATION:**

**MAX. CURRENT/VOLTAGE RATING WITH RESISTIVE LOAD:**

400mA 32VAC-100mA 50VDC-125mA 125VAC

Metal bushing type: 500mA 48VAC - 200 mA 50VDC - 200mA 250VAC

**INITIAL CONTACT RESISTANCE:** 50mΩ max. (without wire leads)

**INSULATION RESISTANCE:** 1GΩ min.at 500VDC.

**DIELECTRIC STRENGTH:** 1,000 VAC rms.(initial value)

Metal bushing type: 1,500 VAC rms.(initial value)

**ELECTRICAL LIFE AT FULL LOAD:** 500,000 cycles.

**OPERATING TEMPERATURE:** -30°C to 85°C.

**TOTAL TRAVEL:** 1.5 mm(.059)

**OPERATING FORCE:** 2N~5N

**CONTACT BOUNCE:** 10 ms.

**MECHANICAL LIFE:** 1,000,000 cycles.

**TORQUE:** 0.5 Nm max.

Metal bushing type: 1.5 Nm max.

**SOLDERING:** 350°C max.for 5 seconds.

**MATERIALS**

**CASE:** Diallyl phthalate (DAP)(UL94v-0).

**CAP:** Polyamide 6/6.

**BUSHING:** Polyamide 6/6.

**HOW TO ORDER**

MODEL NO.	BUSHING	TERMINAL TYPE	CONTACT PLATING	SEAL	RoHS SOLDERING	CAP COLOR	ADDITIONAL HARDWARE	LED COLOR
SP PAS6 OFF-(ON) PAS7 ON-(OFF) *		M1 Solder Lug (std) M4 PC thru-hole ** M3 8.20 Solder Lug **	C Gold over silver	E EPOXY (std) S RoHS & Lead Free			5 Standard hardware	

\* Not available with LED

**WIRE TYPE**

- B1 Round, snap-in
- B2 Round threaded
- B3 Round, snap-in
- B6 Square threaded

**Die-casting**

- D1 Square threaded
- D2 Round threaded

**Die-casting with plating**

**EXAMPLE:**  
PAS6□□M1CES□-5

- Cap Color
- A Chromium
- C Stain-chromium
- D Stain-nickel plating
- D1 Square threaded
- D2 Round threaded

Note: Die-casting with plating is only available for bushing D1 and D2.

Note: Our standard is with flat cap.  
1.LED is only available with flat cap.  
2.Bushing B6 and D1 is only available with flat cap.

CAP COLOR	ITEM NO.		
	Flat(std.)	Round	High
White	1	A1	G1
Black (Std)	2	A2	G2
Red (Std)	3	A3	G3
Orange	4	A4	G4
Yellow	5	A5	G5
Green	6	A6	G6
Blue	7	A7	G7

\*\*\*

ITEM NO	COLOR
Single Color LED	
L1	White
L3	Red
L5	Yellow
L6	Green
L7	Blue
Dual Color LED	
L36	Red+Green
L37	Red+Blue

\*\*\*

\*\* Terminal M3 and M4 are only available with PAS6 without LED.  
\*\*\* Except standard color, for other colors information please consult sales representative.

**EXAMPLE:**  
PAS6B2M1CES□-5 (STD)

- Cap color

PAS6B2M1CES□-5□ (STD)

- LED color
- Flat cap color



▼ SWITCH FUNCTION

NO. POLES	MODEL NO.	SWITCH FUNCTION		CONNECTED TERMINALS		SCHEMATIC
		POS.1	POS.2	POS.1	POS.2	
SP	PAS6	OFF	(ON)	OPEN	1-3	
SP	PAS7	ON	(OFF)	1-3	OPEN	

( )=MOMENTARY

▼ BUSHING OPTIONS

**B1** Round, Snap-in

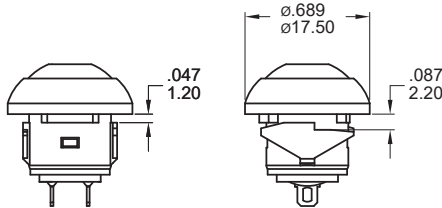

**B2** Round threaded

**D2** Round threaded, die-casting

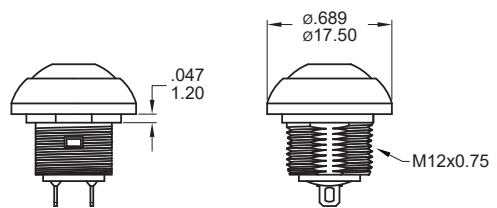

**B3** Round, Snap-in

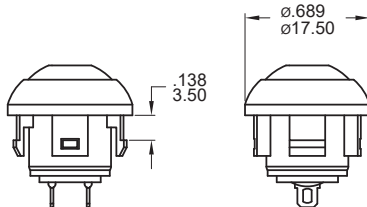

**D1** Square threaded, die-casting

**B6** Square threaded

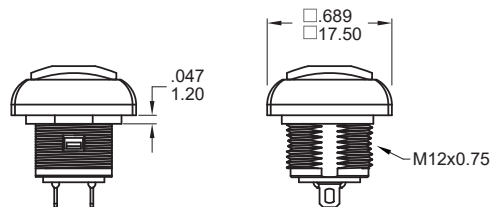

Note: Die-casting with plating is only available for bushing D1 and D2.

**A** Chromium

**C** Stain-chromium

**D** Stain-nickel



▼ TERMINAL OPTIONS

**M1** Solder lug, STD

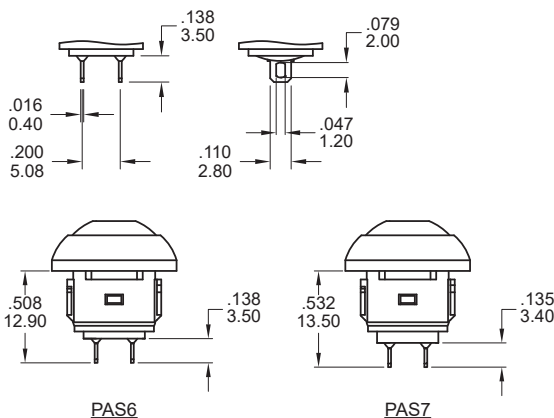

**M3** Solder lug

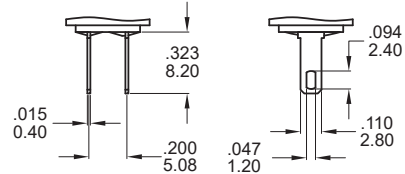

**M4** PC Thru-hole

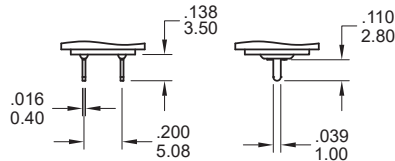

Note: Terminal M3 and M4 are only available with PAS6 without LED.

Note: Not available with LED



▼ **CAP OPTIONS**

**FLAT STD**

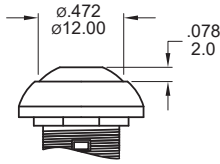

**ROUND No LED \***

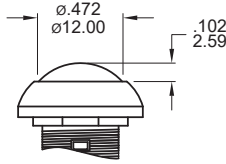

**HIGH No LED \***

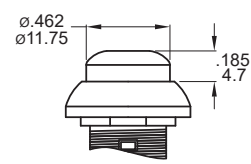

\* Note: Round and high caps are not available for bushing B6 and D1.

▼ **PANEL MOUNTING**

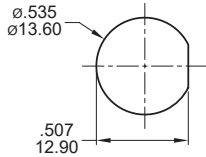

Panel thickness:  
B1 bushing:  
0.8 mm (.031inch) min. -1.8 mm (.071inch) max.  
B2, B6, D1, D2 Bushing:  
1.5 mm (.059inch) min. -4 mm (.157inch) max.

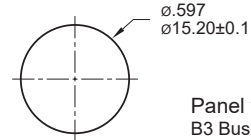

Panel thickness:  
B3 Bushing:  
2.85 +0.05/-0.10 mm (.112inch)

▼ **DIMENSION**

**B1 Snap-in**

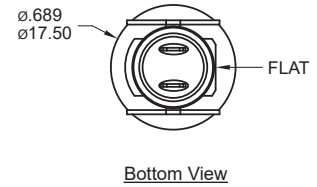
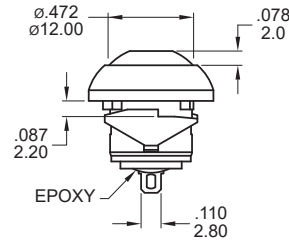
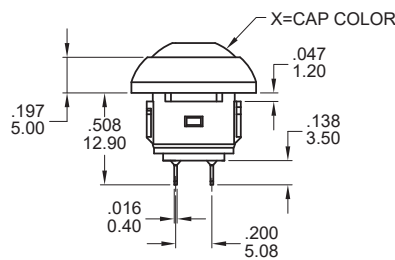

**SPST**

Model name. PAS6B1M1CESX-5

**B2 Threaded**

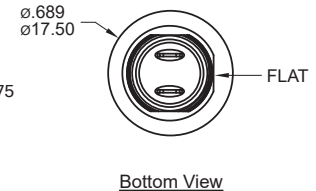
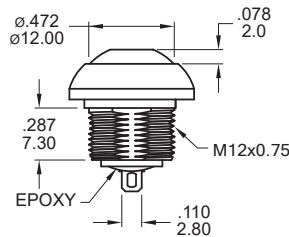
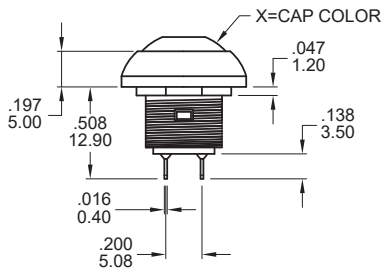

**SPST**

Model name. PAS6B2M1CESX-5

**B3 Snap-in**

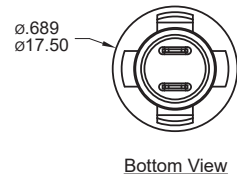
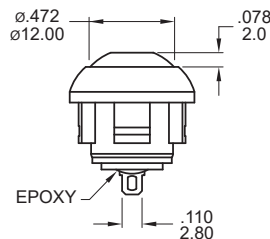
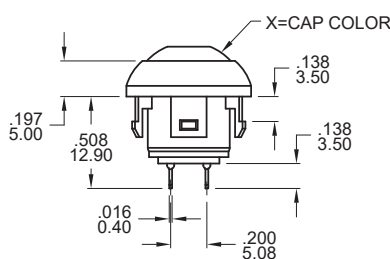

**SPST**

Model name. PAS6B3M1CESX-5



**B6 Square threaded**

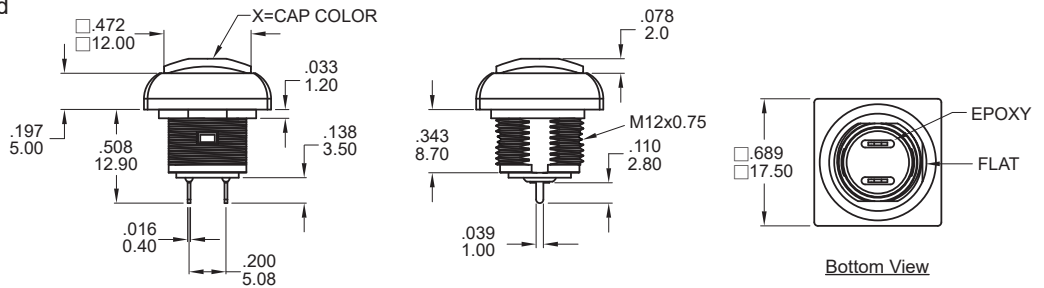

**SPST**

Model name. PAS6B6M1CESX-5

**B2 Threaded**

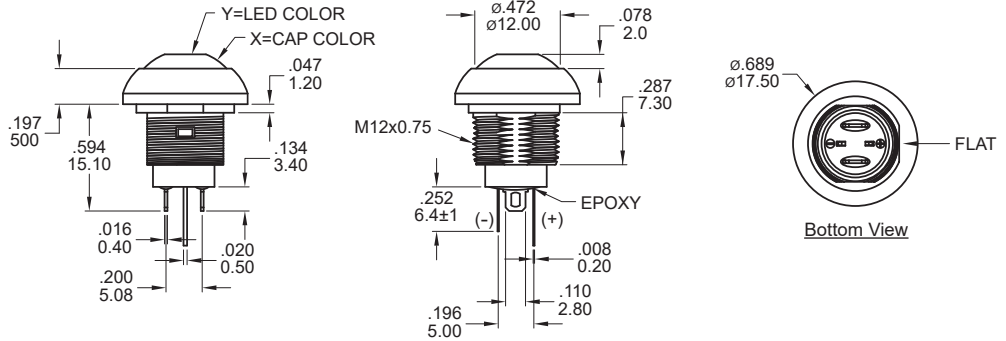

**SPST**

Model name. PAS6B2M1CESX-5LY

**D1 Die-casting**

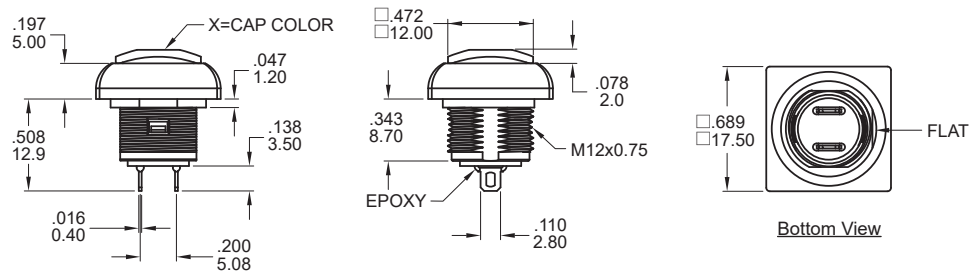

**SPST**

Model name. PAS6D1M1CESX-5

**D2 Die-casting**

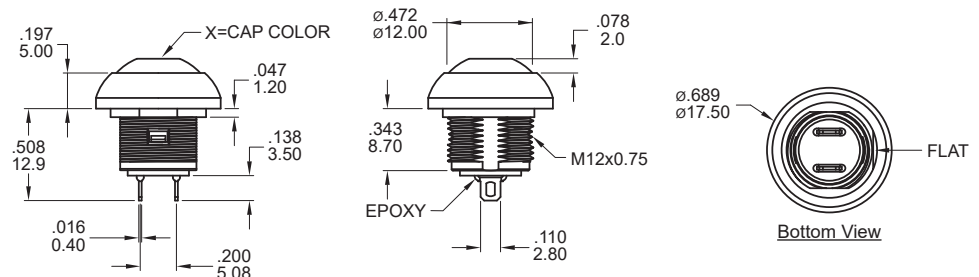

**SPST**

Model name. PAS6D2M1CESX-5

▼ **WIRE OPTIONS**

※ Please consult sales for additional wire options.

**L2** 90mm wire leads 20 AWG

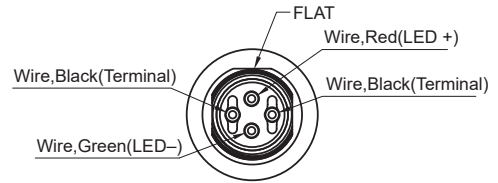
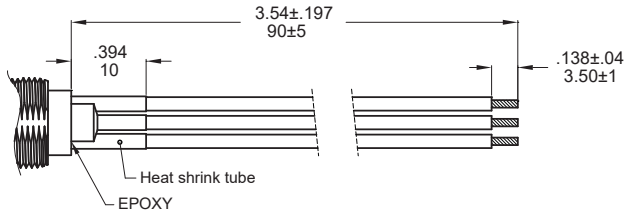

Note: No Illumination: Black and Red Wire - Terminal

**L3** 100mm wire leads 20 AWG

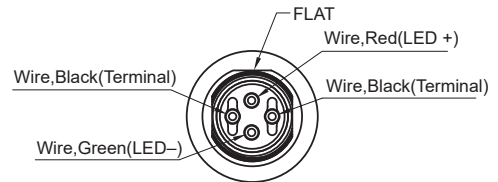
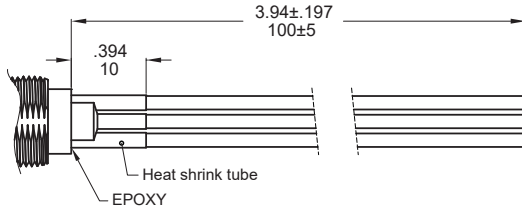

Note: No Illumination: Black Wire - Terminal

**D1** Molding, 500mm wire leads 20 AWG

※ Only available for bushing B2 with flat cap.

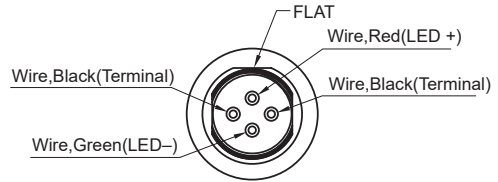
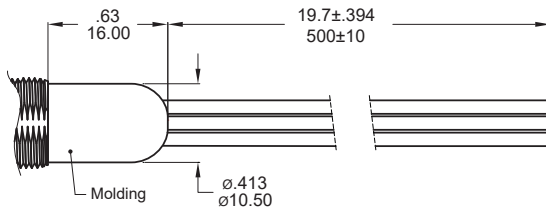

Note: No Illumination: Black Wire - Terminal

▼ **HARDWARE**

EXAMPLE: Model name. 5 Standard Hardware

\* Standard for threaded bushing : 1 nut, 1 EVA washer or o-ring, 1 lockwasher  
\* For further information please consult sales representative.

**NUT (Std.)**

Model name. MNU-PA03

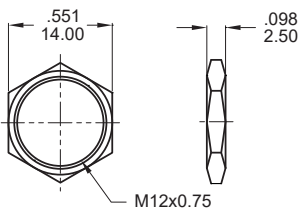

**LOCK WASHER (Std.)**

Model name. MNU-1M09

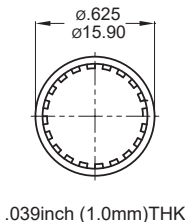

For Threaded bushing

**EVA WASHER (Std.)**

Model name. FSU-PA01

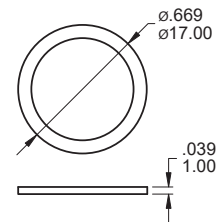

Available with bushing B1 and B2 only

**O-RING (Std.)**

Model name. FCP-A253

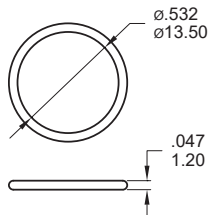

Available with bushing D1, D2 and B6 only

**O-RING (Std.)**

Model name. FCP-P004

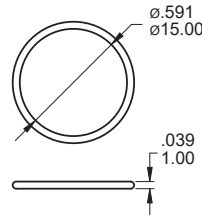

Available with bushing B3 only

**NUT**

Model name. MNU-PA04

MOQ: 10K

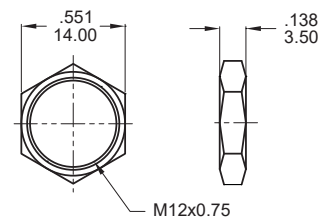



## SPECIFICATION:

### MAX. CURRENT/VOLTAGE RATING WITH RESISTIVE LOAD:

100mA 24VDC-life expectancy 200,000 cycles

2A 125VAC-life expectancy 10,000 cycles

**INITIAL CONTACT RESISTANCE:** 50mΩ max. (without wire leads)

**INSULATION RESISTANCE:** 1GΩ min.at 500VDC.

**DIELECTRIC STRENGTH:** 1,000 VAC rms.(initial value)

**ELECTRICAL LIFE AT FULL LOAD:** 200,000 cycles.

**OPERATING TEMPERATURE:** -30°C to 85°C.

**TOTAL TRAVEL:** 2.5 mm(.098)

**OPERATING FORCE:** 2N~5N

**CONTACT BOUNCE:** 10 ms.

**MECHANICAL LIFE:** 1,000,000 cycles.

**TORQUE:** 0.5 Nm max.

**SOLDERING:** 350°C max.for 5 seconds.

## MATERIALS

**CASE:** Polyamide 6/6.

**CAP:** Polyamide 6/6.

**BUSHING:** Polyamide 6/6.

## HOW TO ORDER

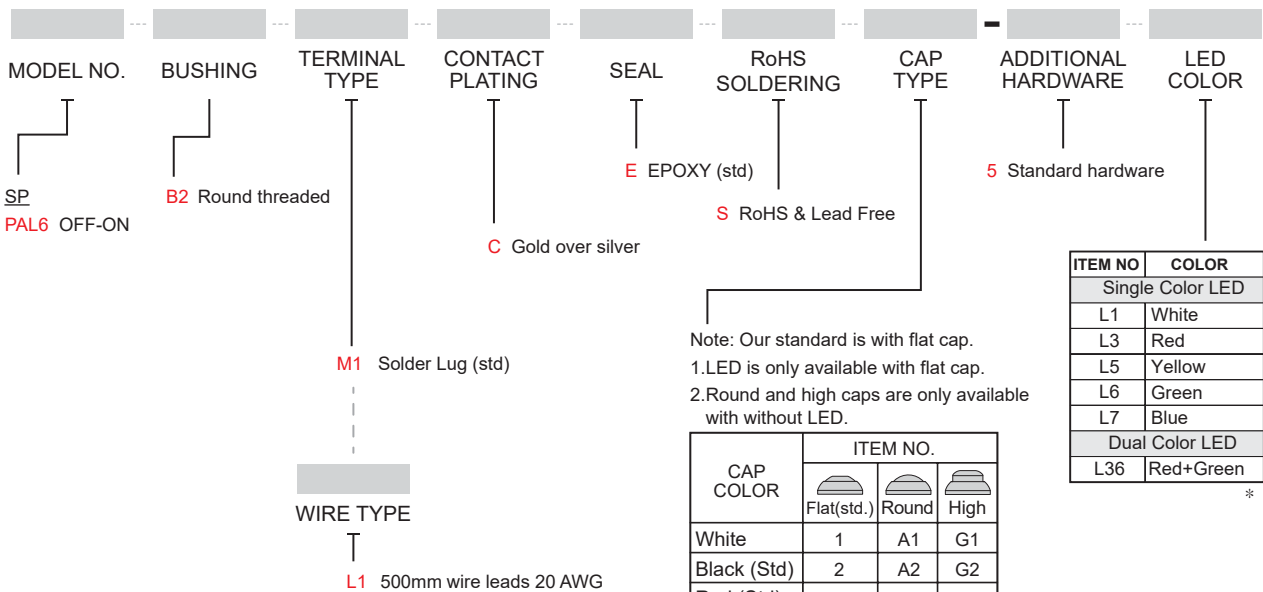

\* Except standard color, for other colors information please consult sales representative.

EXAMPLE:

PAL6B2M1CES□-5 (STD)  
Cap type

PAL6B2M1CES□-5□ (STD)  
LED color  
Flat cap color

### ▼ SWITCH FUNCTION

NO. POLES	MODEL NO.	SWITCH FUNCTION		CONNECTED TERMINALS		SCHEMATIC
		POS.1	POS.2	POS.1	POS.2	
SP	PAL6	OFF	ON	OPEN	1-3	

### ▼ CAP OPTIONS

#### FLAT STD

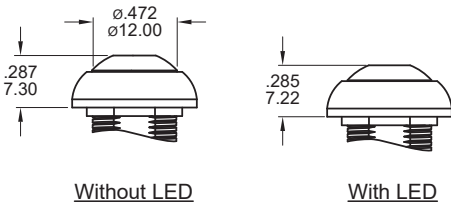

#### ROUND No LED

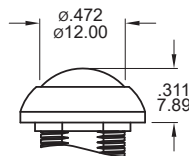

#### HIGH No LED

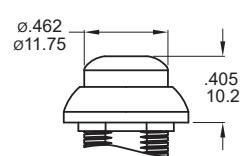

### ▼ DIMENSION

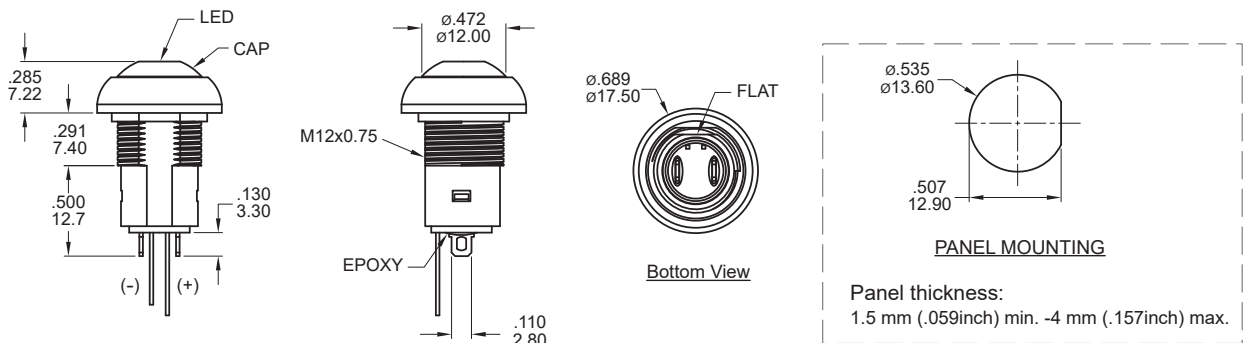

### ▼ WIRE OPTIONS

Wire leads 20 AWG

\* Please consult sales for additional wire options.

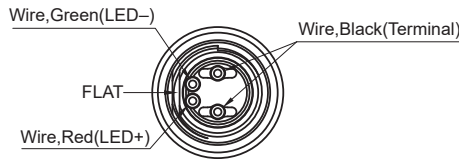
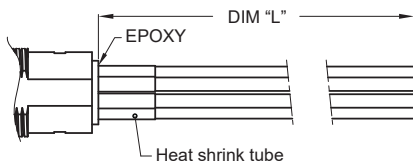

Note: No Illumination: Black Wire - Terminal

#### WIRE LENGTH

CODE	DIM "L"
L1	500±10(19.7±.394)
L2*	90±5(3.54±.197)
L3	100±5(3.94±.197)

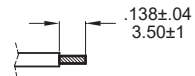

\* Stripping wire for code L2

### ▼ HARDWARE

EXAMPLE: Model name. 5 Standard hardware

\* Standard hardware : 1 nut, 1 O-ring, 1 lockwasher  
\* For further information please consult sales representative.

#### NUT (Std.)

Model name. MNU-PA03

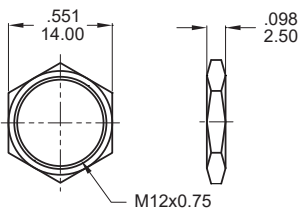

#### LOCKWASHER (Std.)

Model name. MNU-1M09

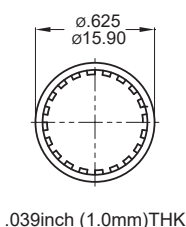

#### O-RING (Std.)

Model name. FCP-A253

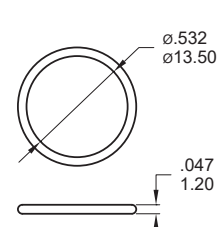



▼ RUBBER HOOD

**Transparent rubber hood (Std.)**

Model name. FCP-P003



**Black rubber hood**

Model name. FCP-P003-2

MOQ: 10K

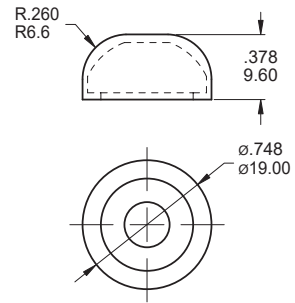

Note: Standard is with flat cap.

EXAMPLE:  -   
Model name.

4 Standard hardware+FCP-P003(Transparen rubber hood)

\* Standard for threaded bushing : 1 nut, 1 EVA washer or o-ring, 1 lockwasher, 1 rubber hood

\* For further information please consult sales representative.

▼ SOLDERING PROCESS

**MANUAL SOLDERING:** Use 30 watts soldering iron and controlled the temperature at 350°.

Duration of solder immersion: Max. 5 sec.

**WAVE SOLDERING:** Recommend soldering temperature: 260 ± 5°C

Duration of solder immersion: Max. 5 sec. (PCB thickness is 1.6mm)

IP67 for the whole series:  
Protected against the effects of  
immersion up to 1 m water (30 min)

