

SPECIFICATIONS

CONTACT RATING: Dependent upon contact material, see page 87.

MECHANICAL LIFE: 30,000 make-and-break cycles.

CONTACT RESISTANCE: 10 mΩ max. (initial value) @ 2-4VDC
100mA for both silver and gold plated contacts.

INSULATION RESISTANCE: 1,000 MΩ min./1000VDC

DIELECTRIC STRENGTH: 1,000 Vrms min.@sea level. (initial value)

OPERATING TEMPERATURE: -40°C to 85°C.

MATERIALS

CASE: Diallyl phthalate (DAP) (UL94v-0).

HOUSING: Stainless steel.

ACTUATOR: Nylon, black.

CONTACT/TERMINALS: Copper with silver or gold plated.

HOW TO ORDER

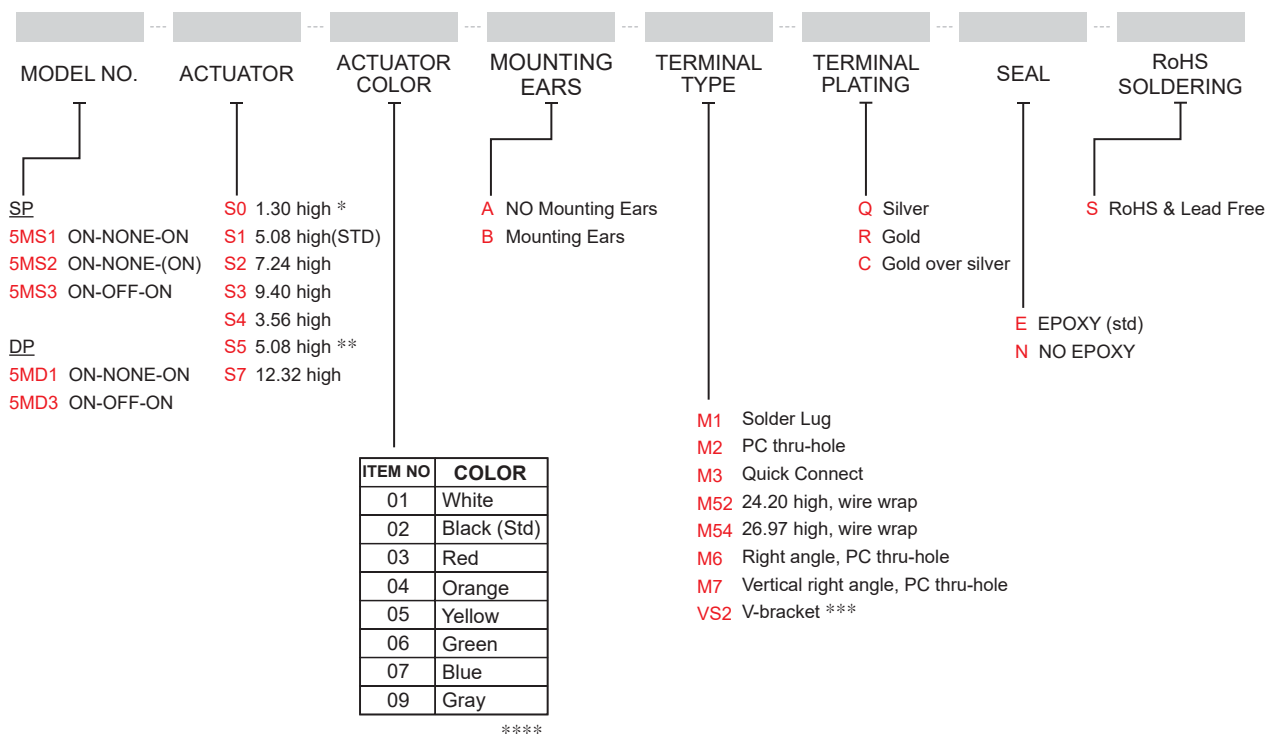

* Actuator S0 is not applicable for 5MS3.
 ** Only available for DPDT.
 *** Not applicable for actuator S5.
 **** Except standard color, for other colors information please consult sales representative.

EXAMPLE:
 5MS1S1□BM1QES
 □ Actuator Color



5M
Slide Switches

▼ SWITCH FUNCTION

NO. POLES	UL/CSA MODEL NO.	MODEL NO.	SWITCH FUNCTION			CONNECTED TERMINALS / SCHEMATIC		
			POS.1	POS.2	POS.3	POS.1	POS.2	POS.3
SP	Q1511	5MS1	ON	NONE	ON	2-1	N/A	2-3
	Q1512	5MS2	ON	NONE	(ON)		OPEN	
	Q1513	5MS3	ON	OFF	ON			
DP	Q1521	5MD1	ON	NONE	ON	2-1,5-4	N/A	2-3,5-6
	Q1523	5MD3	ON	OFF	ON		OPEN	

()=MOMENTARY

▼ POLE OPTIONS

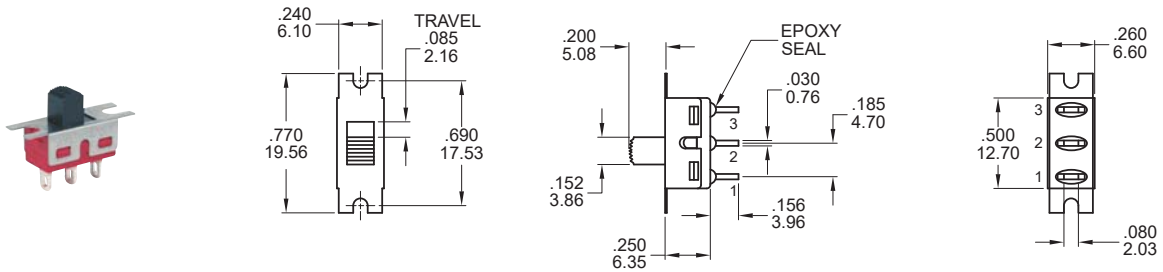

SPDT

Model name. 5MS1S102BM1QES

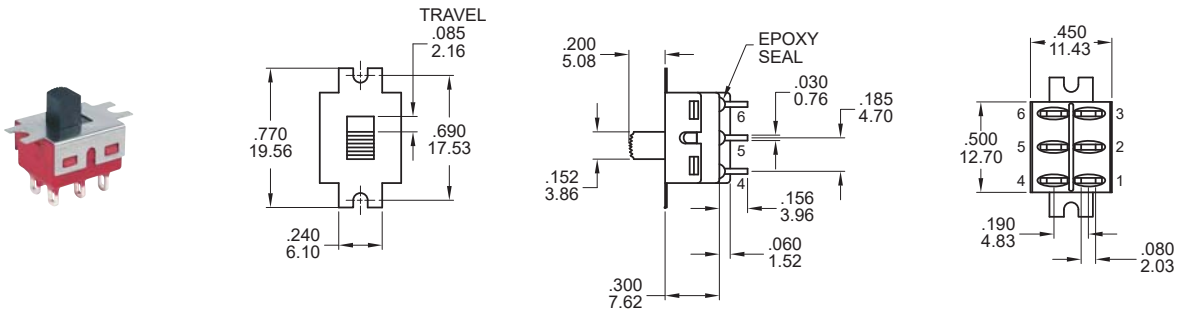

DPDT

Model name. 5MD1S102BM1QES

▼ ACTUATOR OPTIONS

S1 (Std.)

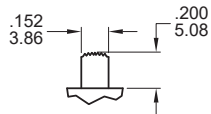

S2

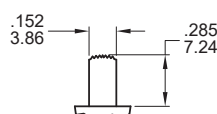

S0 *

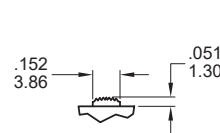

FRONT

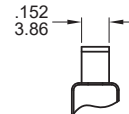

▲ S5

Only available for DPDT

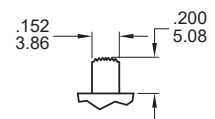

S3

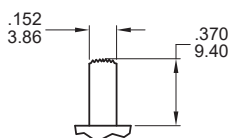

S4

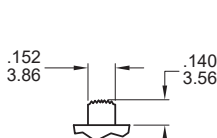

S7

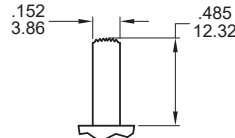

For S0-S4 and S7 actuator

FRONT

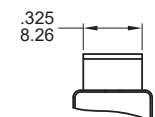

* Actuator S0 is not applicable for 5MS3.

Note: For terminal M6, M7, VS2: -.014inch(0.36mm)

▼ **TERMINAL OPTIONS**

M1 Solder lug

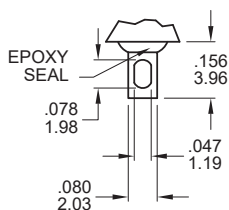

.030inch(0.76mm)THK

M2 PC Thru-hole

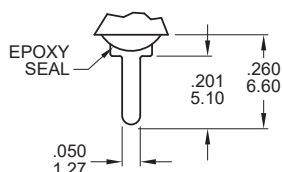

.030inch(0.76mm)THK

M3 Quick connect

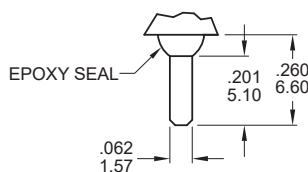

.030inch(0.76mm)THK

M5 Wire Wrap

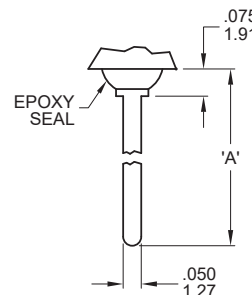

.030inch(0.76mm)THK

5M
Slide Switches

▼ **OTHER TERMINAL OPTIONS**

M6 Right angle P.C. Mount

M7 Right angle P.C. Mount

VS2 Vertical bracket P.C. Mount

OPTION CODE	DIM. 'A'
M52	.953 (24.20)
M54	1.062 (26.97)

M6

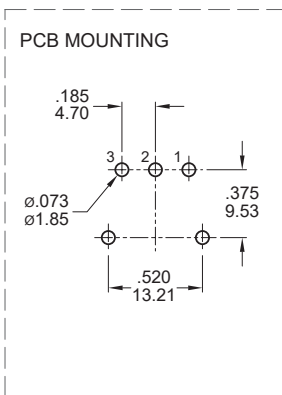
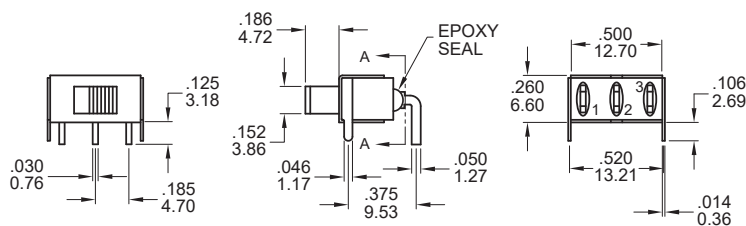

SPDT

Model name. 5MS1S102AM6QES

M6

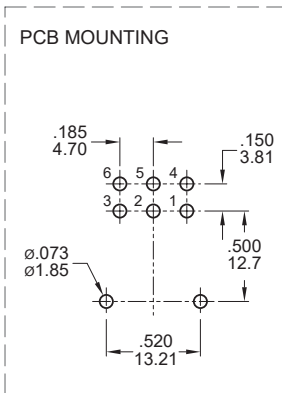
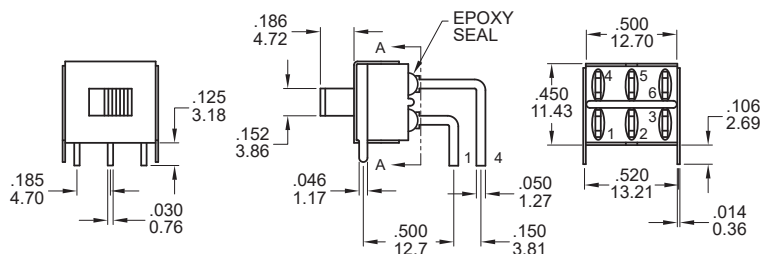

DPDT

Model name. 5MD1S102AM6QES



5M
Slide Switches

M7

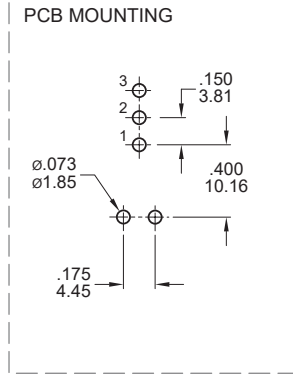
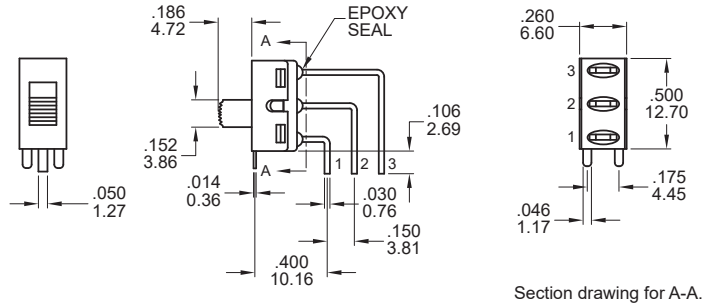

SPDT

Model name. 5MS1S102AM7QES

M7

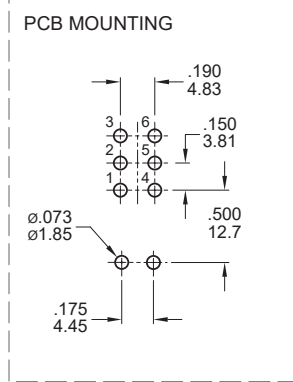
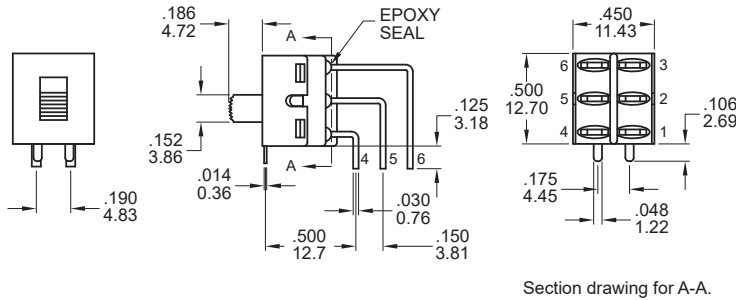
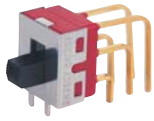

DPDT

Model name. 5MD1S102AM7RES

VS2

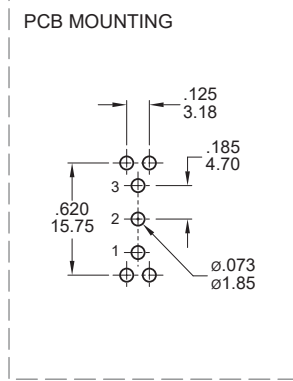
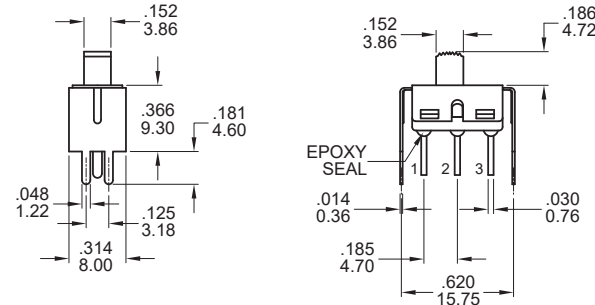
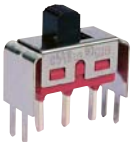

SPDT

Model name. 5MS1S102AVS2QES

VS2

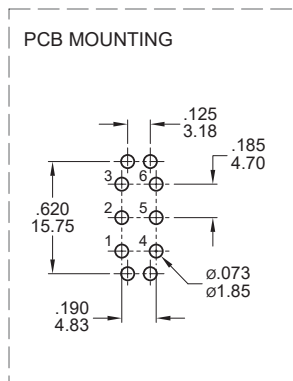
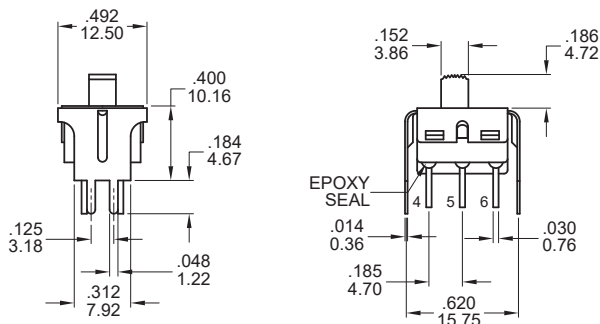
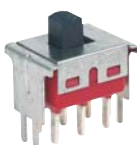

DPDT

Model name. 5MD1S102AVS2QES

▼ MOUNTING EARS

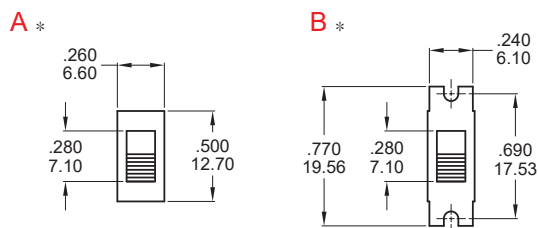
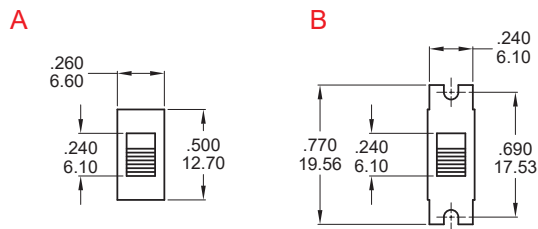

* Three positions only
Note: Standard for S0~S4 and S7 actuator.

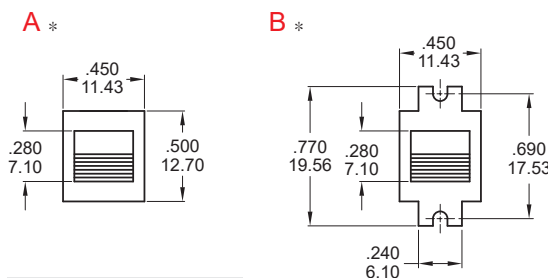
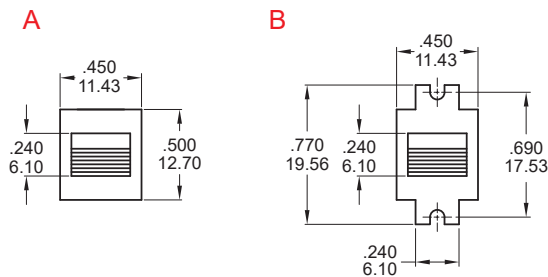

* Three positions only
Note: Standard for S5 actuator.

▼ PANEL MOUNT

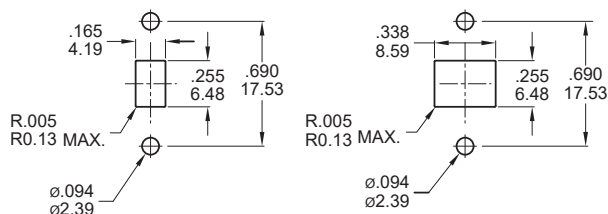

For S0~S4 and S7 actuator

For S5 actuator only

Three positions only

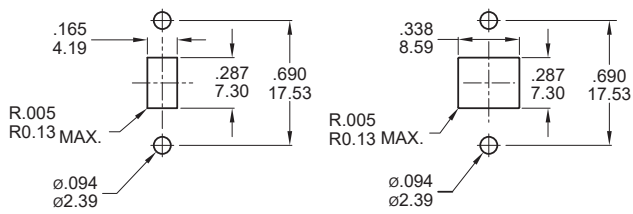

For S0~S4 and S7 actuator

For S5 actuator only

▼ CONTACT & TERMINAL PLATING OPTIONS

	CONTACT PLATING	TERMINAL PLATING	RATINGS
Q	Silver	Silver	5 Amps with resistant load @ 120VAC or 28VDC
C	Gold over Silver	Gold over silver	2 Amps with resistant load @ 250VAC
R	Gold	Gold	0.4 Volt - Amps (VA) max. @ 20V max. (AC or DC)

▼ SOLDERING PROCESS

MANUAL SOLDERING: Use 30 watts soldering iron and controlled the temperature at 350°.

Duration of solder immersion: Max. 5 sec.

WAVE SOLDERING: Recommend soldering temperature: 260 ± 5°C

Duration of solder immersion: Max. 5 sec. (PCB thickness is 1.6mm)